



(12) **United States Patent**  
**Gordon et al.**

(10) **Patent No.:** **US 10,529,147 B2**  
(45) **Date of Patent:** **Jan. 7, 2020**

(54) **SELF-DRIVING VEHICLE ROAD SAFETY FLARE DEPLOYING SYSTEM**

USPC ..... 701/2  
See application file for complete search history.

(71) Applicant: **International Business Machines Corporation**, Armonk, NY (US)  
(72) Inventors: **Michael S. Gordon**, Yorktown Heights, NY (US); **James R. Kozloski**, New Fairfield, CT (US); **Clifford A. Pickover**, Yorktown Heights, NY (US)

(56) **References Cited**

U.S. PATENT DOCUMENTS

4,665,395	A	5/1987	Van Ness
4,908,988	A	3/1990	Yamamura et al.
5,975,791	A	11/1999	McCulloch
6,064,970	A	5/2000	McMillian et al.
6,201,318	B1	3/2001	Guillory
6,326,903	B1	12/2001	Gross et al.
6,393,362	B1	5/2002	Burns

(Continued)

(73) Assignee: **International Business Machines Corporation**, Armonk, NY (US)

(\* ) Notice: Subject to any disclaimer, the term of this patent is extended or adjusted under 35 U.S.C. 154(b) by 99 days.

FOREIGN PATENT DOCUMENTS

CN	1135063	11/1996
CN	2349068	Y 11/1999

(Continued)

(21) Appl. No.: **15/398,927**

(22) Filed: **Jan. 5, 2017**

OTHER PUBLICATIONS

(65) **Prior Publication Data**

US 2018/0190042 A1 Jul. 5, 2018

U.S. Appl. No. 62/369364, filed Aug. 1, 2016 (of Application USP 2018/0032071).\*

(Continued)

(51) **Int. Cl.**

<b>G07C 5/00</b>	(2006.01)
<b>G05D 1/04</b>	(2006.01)
<b>G07C 5/08</b>	(2006.01)
<b>B64C 39/02</b>	(2006.01)
<b>B64D 1/02</b>	(2006.01)

Primary Examiner — Muhammad Shafi

(74) *Attorney, Agent, or Firm* — Law Office of Jim Boice

(52) **U.S. Cl.**

CPC ..... **G07C 5/008** (2013.01); **B64C 39/024** (2013.01); **B64D 1/02** (2013.01); **G05D 1/042** (2013.01); **G07C 5/0808** (2013.01); **B64C 2201/128** (2013.01); **B64C 2201/141** (2013.01); **B64C 2201/146** (2013.01)

(57) **ABSTRACT**

A method deploys a road safety flare near a faulty self-driving vehicle (SDV). One or more processors detect a driving problem severity level for a faulty SDV. One or more processors assess environmental conditions at the location of the faulty SDV. One or more processors determine an opportune position for deploying the road safety flare based on the environmental conditions at the location of the faulty SDV and then deploy, according to directions from the faulty SDV, a road safety flare at the opportune position.

(58) **Field of Classification Search**

CPC .... G07C 5/008; G07C 5/0808; G05D 1/0088; G05D 1/042; G05D 1/0011; B64C 39/024; B64C 2201/141; B64C 2201/128

**15 Claims, 9 Drawing Sheets**

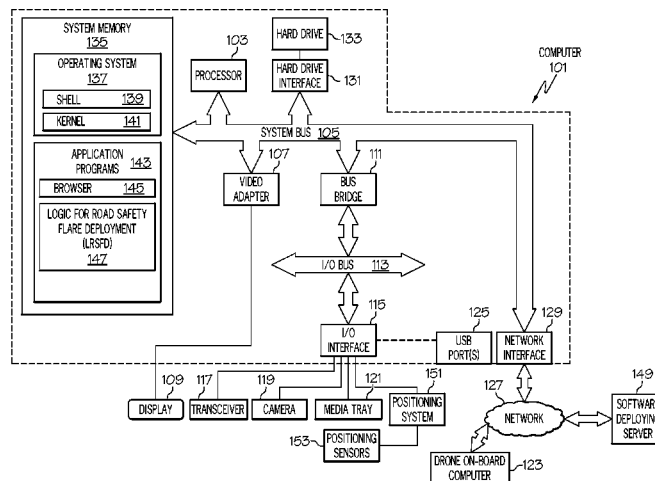

(56)

## References Cited

U.S. PATENT DOCUMENTS			10,093,322 B2	10/2018	Gordon
6,502,035 B2	12/2002	Levine	2002/0026841 A1	3/2002	Svendsen
6,587,043 B1	7/2003	Kramer	2002/0128774 A1	9/2002	Takezaki et al.
6,622,082 B1	9/2003	Schmidt et al.	2003/0065572 A1	4/2003	McNee et al.
6,731,202 B1	5/2004	Klaus	2003/0076981 A1	4/2003	Smith et al.
6,810,312 B2	10/2004	Jammu et al.	2004/0078133 A1	4/2004	Miller
6,969,185 B1	11/2005	Adair	2004/0117086 A1	6/2004	Rao et al.
7,124,088 B2	10/2006	Bauer et al.	2004/0199306 A1	10/2004	Helmann et al.
7,580,782 B2	8/2009	Breed et al.	2005/0021227 A1	1/2005	Matsumoto et al.
7,769,544 B2	8/2010	Blesener et al.	2005/0104745 A1	5/2005	Bachelder et al.
7,877,269 B2	1/2011	Bauer et al.	2006/0106671 A1	5/2006	Biet
7,894,951 B2	2/2011	Norris et al.	2006/0163939 A1	7/2006	Kuramochi et al.
7,979,173 B2	7/2011	Breed	2006/0200379 A1	9/2006	Biet
8,031,062 B2	10/2011	Smith	2006/0241855 A1	10/2006	Joe et al.
8,045,455 B1	10/2011	Agronow et al.	2007/0100687 A1	5/2007	Yoshikawa
8,078,349 B1	12/2011	Prada Gomez et al.	2007/0124027 A1	5/2007	Betzitza et al.
8,090,598 B2	1/2012	Bauer et al.	2008/0048850 A1	2/2008	Yamada
8,139,109 B2	3/2012	Schmiedel et al.	2008/0065293 A1	3/2008	Placke et al.
8,140,358 B1	3/2012	Ling et al.	2008/0114663 A1	5/2008	Watkins et al.
8,146,703 B2	4/2012	Baumann et al.	2008/0129475 A1	6/2008	Breed et al.
8,152,325 B2	4/2012	Mcdermott	2008/0201217 A1	8/2008	Bader et al.
8,180,322 B2	5/2012	Lin et al.	2008/0288406 A1	11/2008	Seguin et al.
8,346,480 B2	1/2013	Trepagnier et al.	2009/0094109 A1	4/2009	Aaronson et al.
8,352,112 B2	1/2013	Mudalige	2009/0138168 A1	5/2009	Labuhn et al.
8,442,854 B2	5/2013	Lawton et al.	2009/0248231 A1	10/2009	Kamiya
8,466,807 B2	6/2013	Mudalige	2009/0313096 A1	12/2009	Kama
8,489,434 B1	7/2013	Otis et al.	2010/0057511 A1	3/2010	Mansouri et al.
8,583,365 B2	11/2013	Jang et al.	2010/0156672 A1	6/2010	Yoo et al.
8,660,734 B2	2/2014	Zhu et al.	2010/0179720 A1	7/2010	Lin et al.
8,676,466 B2	3/2014	Mudalige	2010/0228427 A1	9/2010	Anderson et al.
8,678,701 B1	3/2014	Aldasem	2010/0256852 A1	10/2010	Mudalige
8,706,394 B2	4/2014	Trepagnier et al.	2011/0029173 A1	2/2011	Hyde et al.
8,786,461 B1	7/2014	Daudelin	2011/0035250 A1	2/2011	Finucan
8,810,392 B1	8/2014	Teller et al.	2011/0077807 A1	3/2011	Hyde et al.
8,816,857 B2	8/2014	Nordin et al.	2011/0077808 A1	3/2011	Hyde et al.
8,874,305 B2	10/2014	Dolgov et al.	2011/0137699 A1	6/2011	Ben-Ari et al.
8,880,270 B1	11/2014	Ferguson et al.	2011/0264521 A1	10/2011	Straka
8,892,451 B2	11/2014	Everett	2012/0072243 A1	3/2012	Collins et al.
8,903,591 B1	12/2014	Ferguson et al.	2012/0083960 A1	4/2012	Zhu
8,923,890 B1	12/2014	White et al.	2012/0123646 A1	5/2012	Mantini
8,935,034 B1	1/2015	Zhu	2012/0139756 A1	6/2012	Djurkovic
8,948,955 B2	2/2015	Zhu et al.	2012/0277947 A1	11/2012	Boehringer et al.
8,949,016 B1	2/2015	Ferguson et al.	2012/0293341 A1	11/2012	Lin
8,954,217 B1	2/2015	Montemerlo et al.	2013/0030657 A1	1/2013	Chatterjee et al.
8,954,252 B1	2/2015	Urmson et al.	2013/0113634 A1	5/2013	Hutchinson et al.
8,954,261 B2	2/2015	Das et al.	2013/0131949 A1	5/2013	Shida
8,958,943 B2	2/2015	Bertosa et al.	2013/0144502 A1	6/2013	Shida
8,965,621 B1	2/2015	Urmson et al.	2013/0231824 A1	9/2013	Wilson et al.
8,970,362 B2	3/2015	Morley et al.	2013/0261871 A1	10/2013	Hobbs et al.
8,983,705 B2	3/2015	Zhu et al.	2013/0304514 A1	11/2013	Hyde
8,996,224 B1	3/2015	Herbach et al.	2014/0019259 A1	1/2014	Dung et al.
9,014,905 B1	4/2015	Kretzschmar et al.	2014/0032049 A1	1/2014	Moshchuk et al.
9,024,787 B2	5/2015	Alshinnawi et al.	2014/0092332 A1	4/2014	Price
9,123,049 B2	9/2015	Hyde et al.	2014/0095214 A1	4/2014	Mathe et al.
9,170,327 B2	10/2015	Choe et al.	2014/0129073 A1	5/2014	Ferguson
9,189,897 B1	11/2015	Stenneth	2014/0136045 A1	5/2014	Zhu et al.
9,194,168 B1	11/2015	Lu et al.	2014/0136414 A1	5/2014	Abhyanker
9,216,745 B2	12/2015	Beardsley et al.	2014/0164126 A1	6/2014	Nicholas et al.
9,218,698 B2	12/2015	Ricci	2014/0188999 A1	7/2014	Leonard et al.
9,286,520 B1	3/2016	Lo et al.	2014/0195213 A1	7/2014	Kozloski
9,317,033 B2	4/2016	Ibanez-guzman et al.	2014/0201037 A1	7/2014	Mallawarachchi et al.
9,381,915 B1	7/2016	Crombez et al.	2014/0201126 A1	7/2014	Zadeh
9,390,451 B1	7/2016	Slusar	2014/0214255 A1	7/2014	Dolgov et al.
9,399,472 B2	7/2016	Minoiu-Enache	2014/0214260 A1	7/2014	Eckert et al.
9,463,805 B2	10/2016	Kirsch et al.	2014/0222277 A1	8/2014	Tsimhoni et al.
9,483,948 B1	11/2016	Gordon et al.	2014/0222577 A1	8/2014	Abhyanker
9,552,735 B2	1/2017	Pilutti et al.	2014/0282967 A1	9/2014	Maguire
9,566,958 B2	2/2017	Waldmann	2014/0297116 A1	10/2014	Anderson et al.
9,566,986 B1	2/2017	Gordon et al.	2014/0306833 A1	10/2014	Ricci
9,587,952 B1	3/2017	Slusar	2014/0309789 A1	10/2014	Ricci
9,628,975 B1	4/2017	Watkins et al.	2014/0309806 A1	10/2014	Ricci
9,646,496 B1	5/2017	Miller	2014/0309864 A1	10/2014	Ricci
9,718,468 B2	8/2017	Barfield et al.	2014/0309891 A1	10/2014	Ricci
9,754,235 B1	9/2017	Konrardy	2014/0310186 A1	10/2014	Ricci
9,834,224 B2	12/2017	Gordon et al.	2014/0316671 A1	10/2014	Okamoto
10,042,359 B1	8/2018	Konrardy	2014/0324268 A1	10/2014	Montemerlo et al.
			2014/0330479 A1	11/2014	Dolgov
			2014/0358331 A1	12/2014	Prada Gomez et al.
			2014/0358353 A1	12/2014	Ibanez-Guzman et al.

(56)

## References Cited

## U.S. PATENT DOCUMENTS

2015/0006005 A1 1/2015 Yu et al.  
 2015/0006014 A1 1/2015 Wimmer et al.  
 2015/0026092 A1 1/2015 Abboud et al.  
 2015/0035685 A1 2/2015 Strickland et al.  
 2015/0051778 A1 2/2015 Mueller  
 2015/0057891 A1 2/2015 Mudalige et al.  
 2015/0062340 A1 3/2015 Datta et al.  
 2015/0062469 A1 3/2015 Fleury  
 2015/0066282 A1 3/2015 Yopp  
 2015/0066284 A1 3/2015 Yopp  
 2015/0070178 A1 3/2015 Kline  
 2015/0088358 A1 3/2015 Yopp  
 2015/0095190 A1 4/2015 Hammad et al.  
 2015/0097866 A1 4/2015 Mochizuki  
 2015/0120331 A1 4/2015 Russo et al.  
 2015/0134178 A1 5/2015 Minoiu-Enache  
 2015/0137985 A1 5/2015 Zafiroglu et al.  
 2015/0141043 A1 5/2015 Abramson  
 2015/0149018 A1 5/2015 Attard et al.  
 2015/0149021 A1 5/2015 Duncan et al.  
 2015/0160019 A1 6/2015 Biswal et al.  
 2015/0166059 A1 6/2015 Ko  
 2015/0170287 A1 6/2015 Tirone  
 2015/0187019 A1 7/2015 Fernandes  
 2015/0196256 A1 7/2015 Venkatraman et al.  
 2015/0210280 A1 7/2015 Agnew et al.  
 2015/0232065 A1 8/2015 Ricci et al.  
 2015/0235480 A1 8/2015 Cudak  
 2015/0235557 A1 8/2015 Engelman  
 2015/0242953 A1 8/2015 Suiter  
 2015/0269536 A1 9/2015 Parris  
 2015/0293994 A1 10/2015 Kelly  
 2015/0338226 A1 11/2015 Mason et al.  
 2015/0339639 A1 11/2015 Choe  
 2016/0001781 A1 1/2016 Fung et al.  
 2016/0026182 A1 1/2016 Boroditsky et al.  
 2016/0063761 A1 3/2016 Sisbot et al.  
 2016/0075512 A1 3/2016 Lert, Jr.  
 2016/0078695 A1 3/2016 Mcclintic et al.  
 2016/0078758 A1 3/2016 Basalamah  
 2016/0090100 A1 3/2016 Oyama et al.  
 2016/0139594 A1 5/2016 Okumura et al.  
 2016/0140507 A1 5/2016 Stevens et al.  
 2016/0176409 A1 6/2016 Kirsch et al.  
 2016/0202700 A1 7/2016 Sprigg  
 2016/0205146 A1 7/2016 Sugioka et al.  
 2016/0221768 A1 8/2016 Kadaba  
 2016/0303969 A1 10/2016 Akula  
 2016/0304122 A1 10/2016 Herzog et al.  
 2016/0321921 A1 11/2016 Stafford et al.  
 2016/0334797 A1 11/2016 Ross et al.  
 2016/0344737 A1 11/2016 Anton  
 2016/0355192 A1 12/2016 James et al.  
 2016/0358477 A1 12/2016 Ansari  
 2016/0364823 A1 12/2016 Cao  
 2016/0368534 A1 12/2016 Harda  
 2016/0371977 A1 12/2016 Wingate  
 2017/0001650 A1 1/2017 Park  
 2017/0010613 A1 1/2017 Fukumoto  
 2017/0021830 A1 1/2017 Feldman et al.  
 2017/0021837 A1 1/2017 Ebina  
 2017/0032585 A1 2/2017 Stenneth  
 2017/0057542 A1 3/2017 Kim et al.  
 2017/0061798 A1 3/2017 Linder  
 2017/0088143 A1 3/2017 Goldman-Shenhar et al.  
 2017/0106876 A1 4/2017 Gordon et al.  
 2017/0123428 A1 5/2017 Levinson et al.  
 2017/0129487 A1 5/2017 Wulf  
 2017/0137023 A1 5/2017 Anderson et al.  
 2017/0151958 A1 6/2017 Sakuma  
 2017/0168689 A1 6/2017 Goldman-Shenhar et al.  
 2017/0200449 A1 7/2017 Penilla et al.  
 2017/0219364 A1 8/2017 Lathrop  
 2017/0248949 A1 8/2017 Moran et al.  
 2017/0300855 A1 10/2017 Lund

2018/0032071 A1\* 2/2018 Wieneke ..... G05D 1/0027  
 2018/0072323 A1 3/2018 Gordon  
 2018/0075309 A1 3/2018 Sathyanarayana et al.  
 2018/0086373 A1 3/2018 Tamura  
 2018/0093631 A1 4/2018 Lee et al.  
 2018/0141453 A1\* 5/2018 High ..... B60L 11/1822  
 2018/0154906 A1\* 6/2018 Dudar ..... B60R 21/0136  
 2018/0203455 A1 7/2018 Cronin  
 2018/0265054 A1 9/2018 Hofmann

## FOREIGN PATENT DOCUMENTS

CN 201004265 Y 1/2008  
 CN 202012052 10/2011  
 CN 202038228 U 11/2011  
 CN 102650882 8/2012  
 CN 202772924 3/2013  
 CN 104900018 A 9/2015  
 EP 0582236 2/1994  
 GB 2498793 A 7/2013  
 WO 2014058263 4/2014  
 WO 2014066721 5/2014  
 WO 2014147361 9/2014  
 WO 2014148975 9/2014  
 WO 2014148976 9/2014  
 WO 2015024616 2/2015  
 WO 2015056105 4/2015

## OTHER PUBLICATIONS

U.S. Appl. No. 62/425,173, filed Nov. 22, 2016 (of Application USP 2018/0141453). (Year: 2016).\*

Anonymous, "System and Method to Target Advertisements for the Right Focus Group".ip.com, No. 000218285, May 31, 2012, pp. 1-2.

Anonymous, "Car Built-In Mechanism to Enforce Mandatory Self-Driving Mode", ip.com, No. 000234916, Feb. 14, 2014, pp. 1-3.

T. Horberry et al., "Driver Distraction: The Effects of Concurrent In-Vehicle Tasks, Road Environment Complexity and Age on Driving Performance", Elsevier Ltd., Accident Analysis and Prevention, 38, 2006, pp. 185-191.

J. Miller, "Self-Driving Car Technology's Benefits, Potential Risks, and Solutions", The Energy Collective, theenergycollective.com, Aug. 19, 2014, pp. 1-7.

Chen S, et al., "A Crash Risk Assessment Model for Roas Curves". Inproceedings 20th International Technical Conference on the Enhanced Safety of Vehicles., 2007. Lyon, France.

J. Wei et al., "Towards a Viable Autonomous Driving Research Platform", IEEE, Intelligent Vehicles Symposium (IV), 2013, pp. 1-8.

Anonymous, "Diagnostics Mechanism for Self-Driving Cars to Validate Self-Driving Capabilities", ip.com, Jun. 6, 2014, pp. 1-5. ip.com.

Brownell, "Shared Autonomous Taxi Networks: An Analysis of Transportation Demand in NJ and a 21st Century Solution for Congestion", Dissertation, Princeton University, 2013, pp. 1-122.

Sessa et al., "Blueprint of Alternative City Cyber-Mobility Take-U Scenarios", Seventh Framework Programme Theme SST.2012.3.1-4, Automated Urban Vehicles Collaborative Project—Grant Agreement No. 314190, 2013, pp. 1-63.

Lutin et al., "The Revolutionary Development of Self-Driving Vehicles and Implications for the Transportation Engineering Profession", ITE Journal 83.7, 2013, pp. 28-32.

A. Hars, "Self-Driving Cars: The Digital Transformation of Mobility", Marktplate Im Umbruch, Springer Berlin Heidelberg, 2015, pp. 539-549.

Jimenez et al.; "Autonomous collision avoidance system based on accurate knowledge of the vehicle surroundings"; Inst Engineering Technology-IET; IET Intelligent Transport Systems vol. 9, No. 1, pp. 105-117; 2015; England.

Anonymous, "Avoiding Crashes With Self-Driving Cars: Today's Crash-Avoidance Systems Are the Mile Markers to Tomorrow's Autonomous Vehicles". Consumer Reports Magazine, Feb. 2014. Web. Sep. 22, 2016. <http://www.consumerreports.org/cro/magazine/2014/04/the-road-to-self-driving-cars/index.htm>.

(56)

**References Cited**

## OTHER PUBLICATIONS

Anonymous, "Google Files Patent for Second-Gen Autonomous Vehicle Without a Steering Wheel, Brake Pedal & More". patentlymobile.com, Nov. 27, 2015. Web. Sep. 22, 2016. <<http://www.patentlymobile.com/2015/11/GOOGLE-FILES-PATENT-FOR-SECOND-GEN-AUTONOMOUS-VEHICLE-WITHOUT-A-STEERING-WHEEL-BRAKE-PEDAL-MORE.HTML>>.

C. Berger et al., "Cots-Architecture With a Real-Time OS for a Self-Driving Miniature Vehicle", Safecomp 2013—Workshop Ascoms of the 32nd International Conference on Computer Safety, Reliability and Security, Sep. 2013, Toulouse, France, pp. 1-13.

Anonymous, "Marche Smart Flare Ultra Bright 360 Degree LED Emergency Flares—2 Pack". amazon.com, Web. Sep. 22, 2016. <<https://www.amazon.com/MARCHE-BRIGHT-DEGREE-EMERGENCY-FLARES/DP/B00X7VIRAY>>.

Anonymous, "pi-Lit® Ice Cream Sandwich—Sequencing Road Surface Flare". pivvariables.com, Apr. 16, 2014. Web. Sep. 22, 2016. <<https://www.google.com/search?q=PIVARIABLES%2FCOM%2FICE-CREAM-SANDWICH-FLARE&ie=utf-8&oe=utf-8>>.

P. Mell et al., "The NIST Definition of Cloud Computing", National Institute of Standards and Technology, Information Technology Laboratory, Sep. 2011, pp. 1-7.

R. Vaidyanathan et al., "A Reflexive Vehicle Control Architecture Based on a Neural Model of the Cockroach Escape Response", Institution of Mechanical Engineers. Journal of Systems and Control Engineering, 2011, vol. 226, No. 5, pp. 699-718.

\* cited by examiner

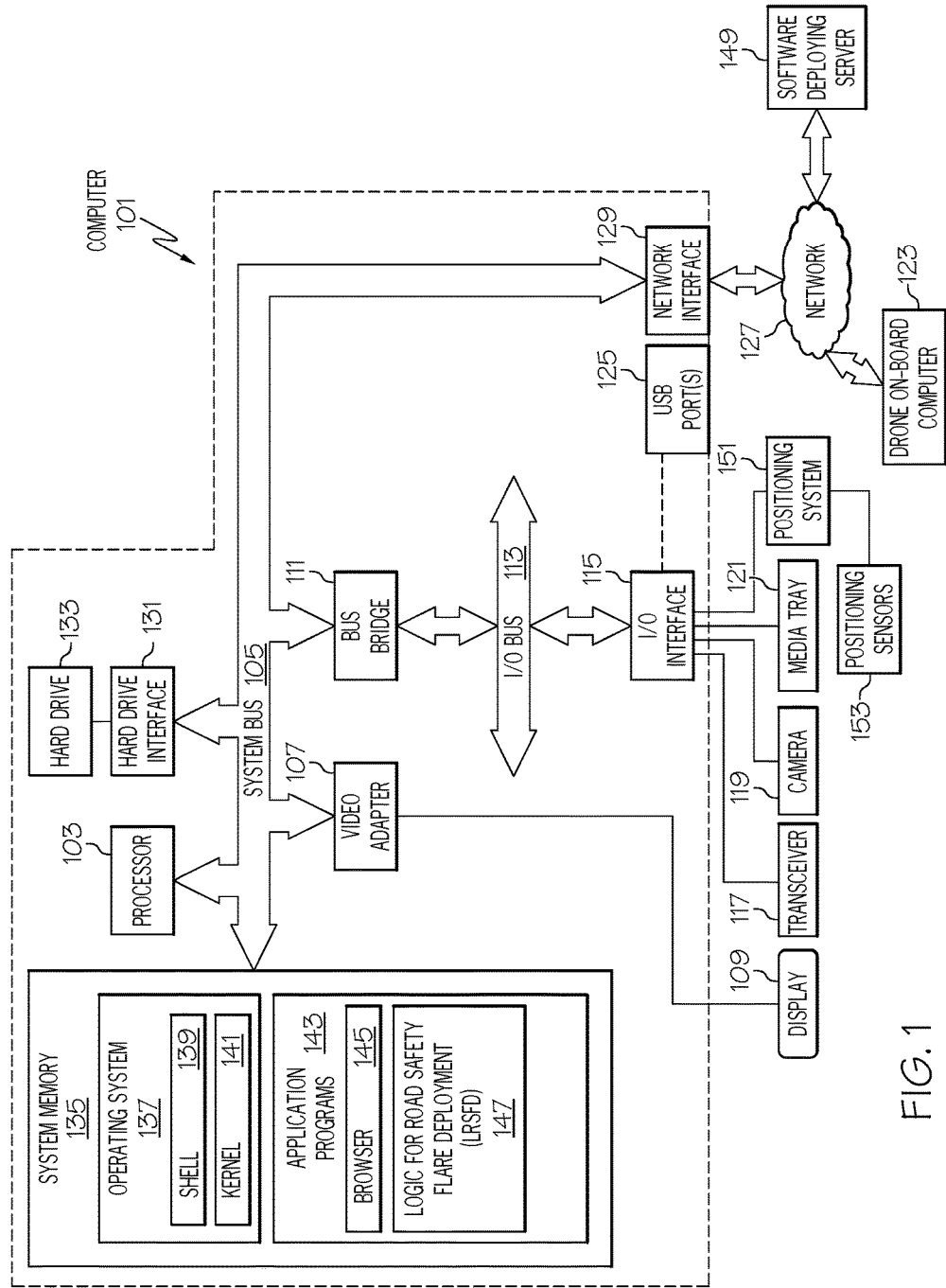

FIG. 1

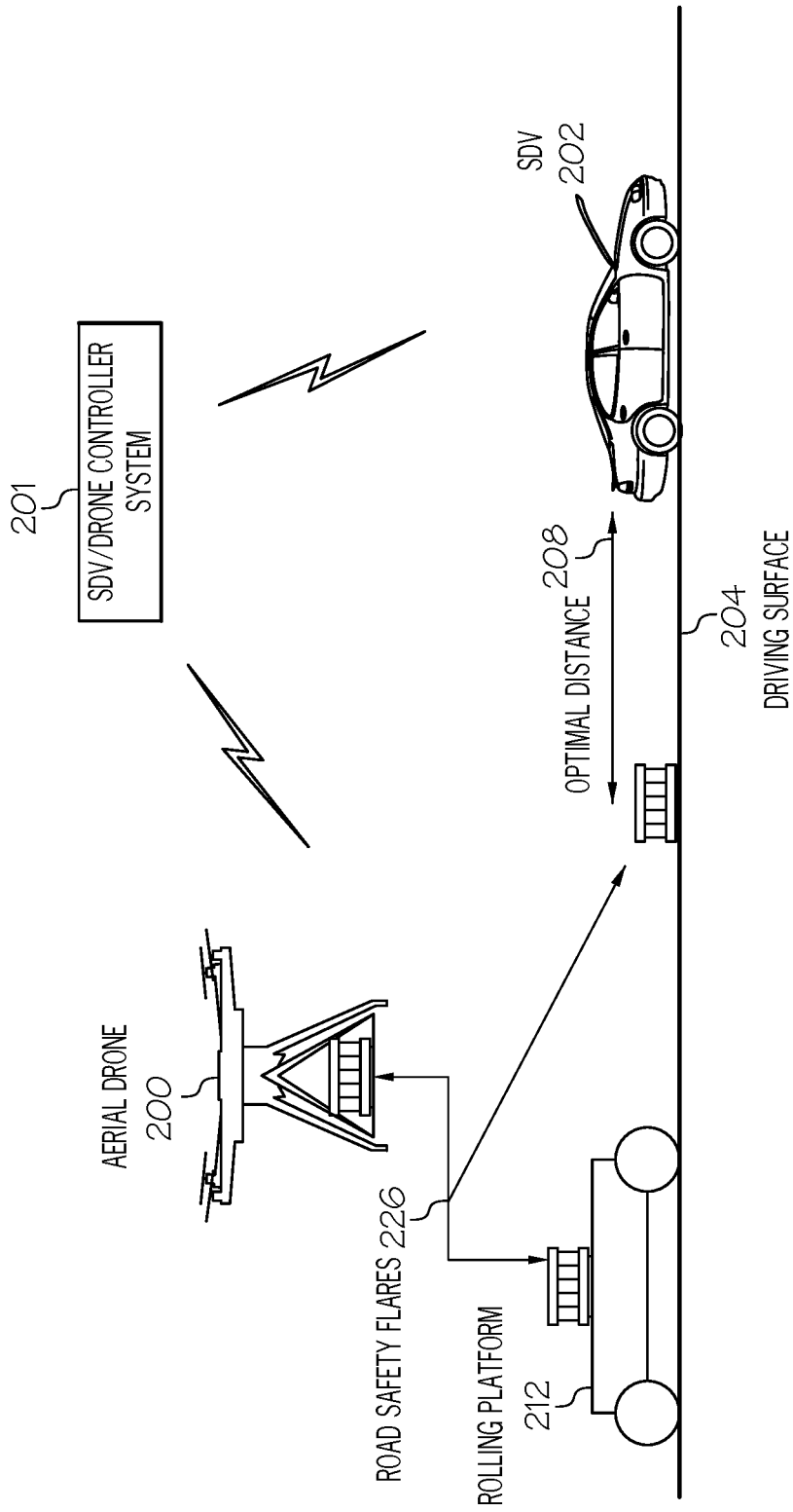

FIG. 2

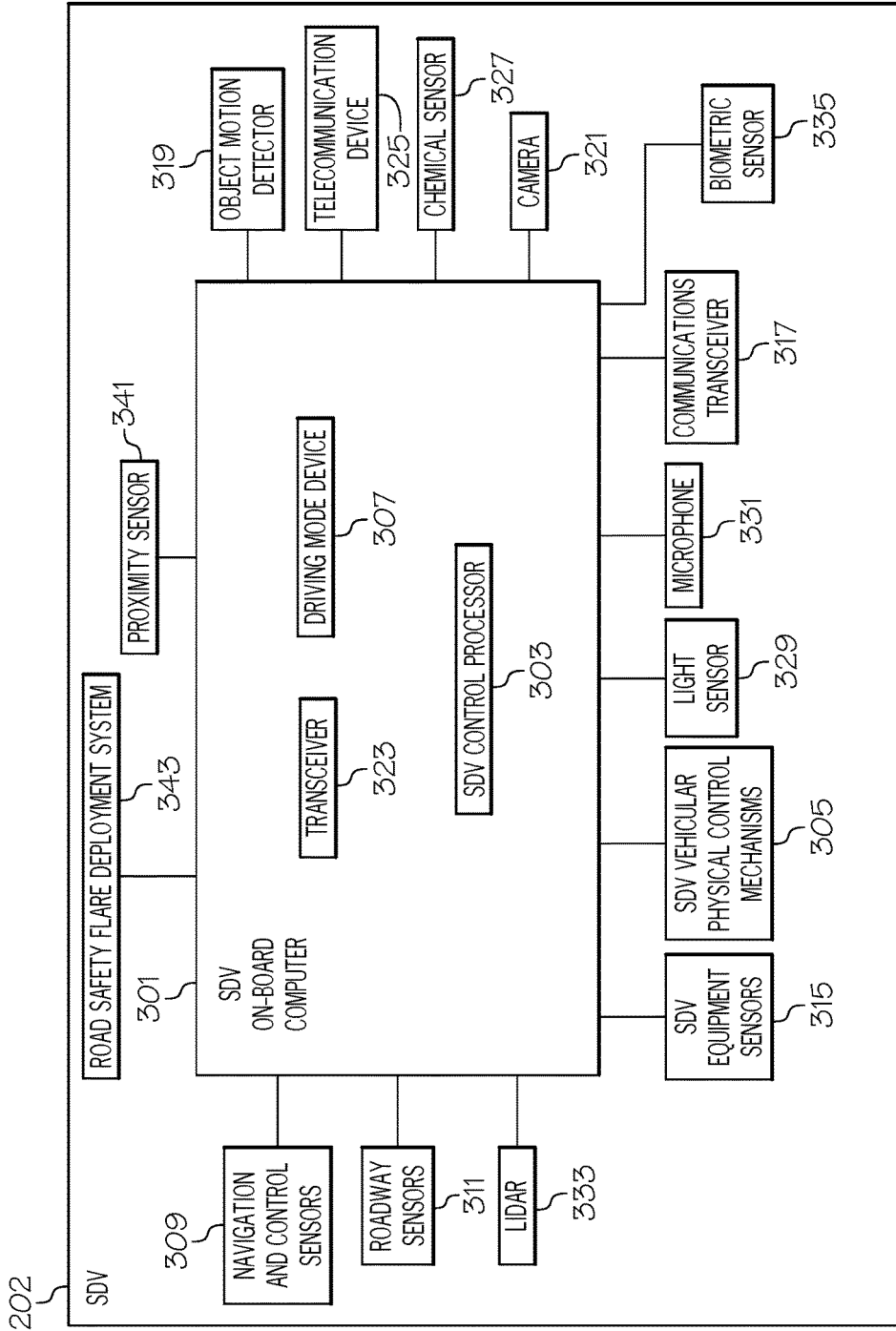

FIG. 3

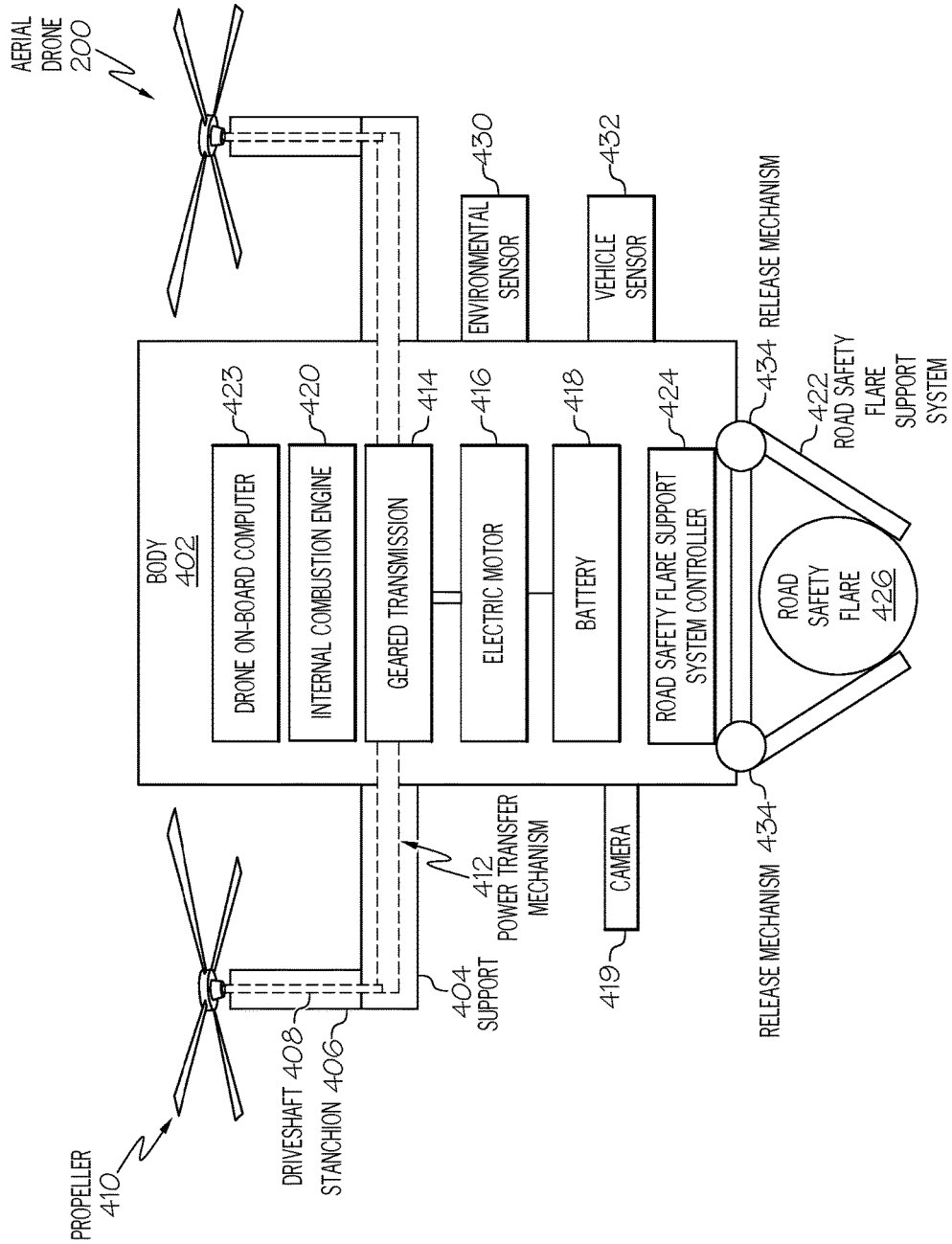

FIG. 4



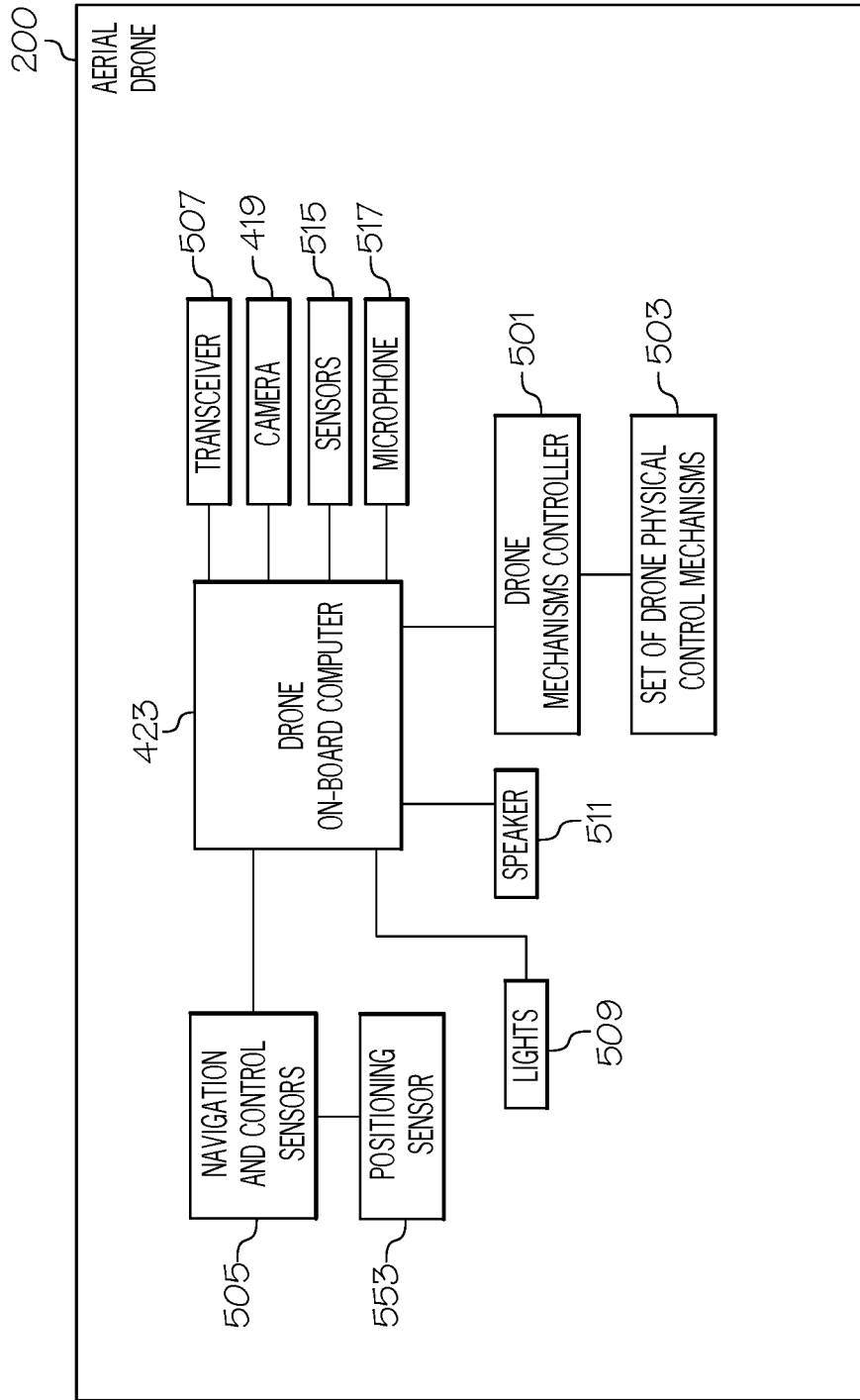

FIG. 5

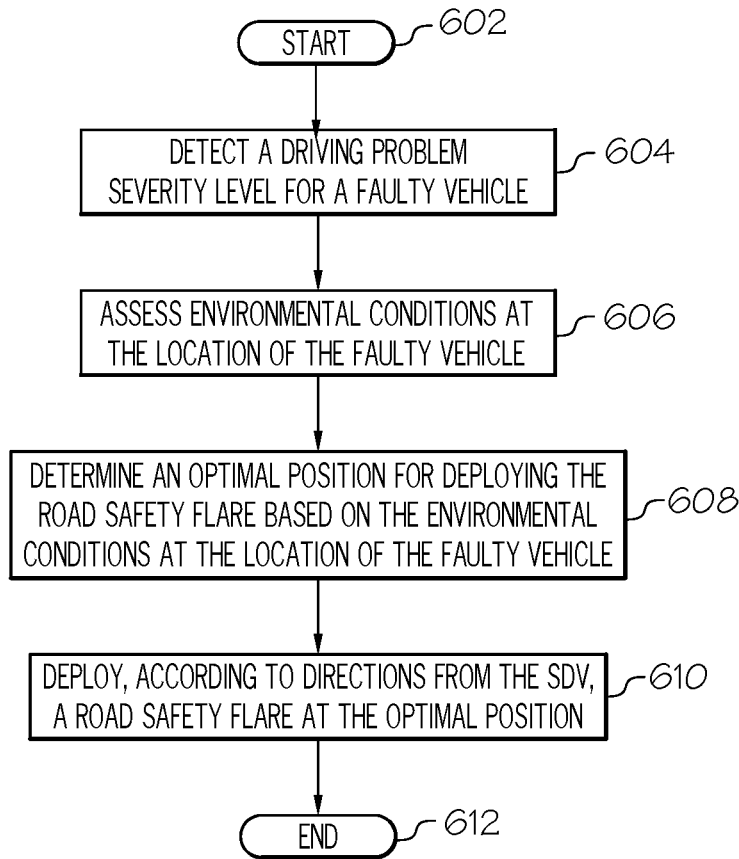

FIG. 6

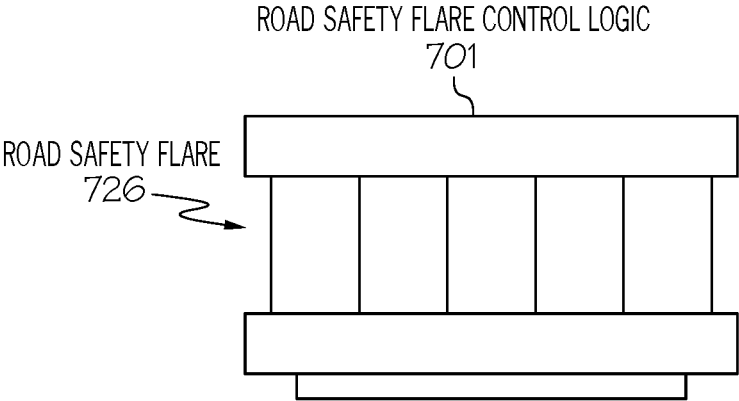

FIG. 7

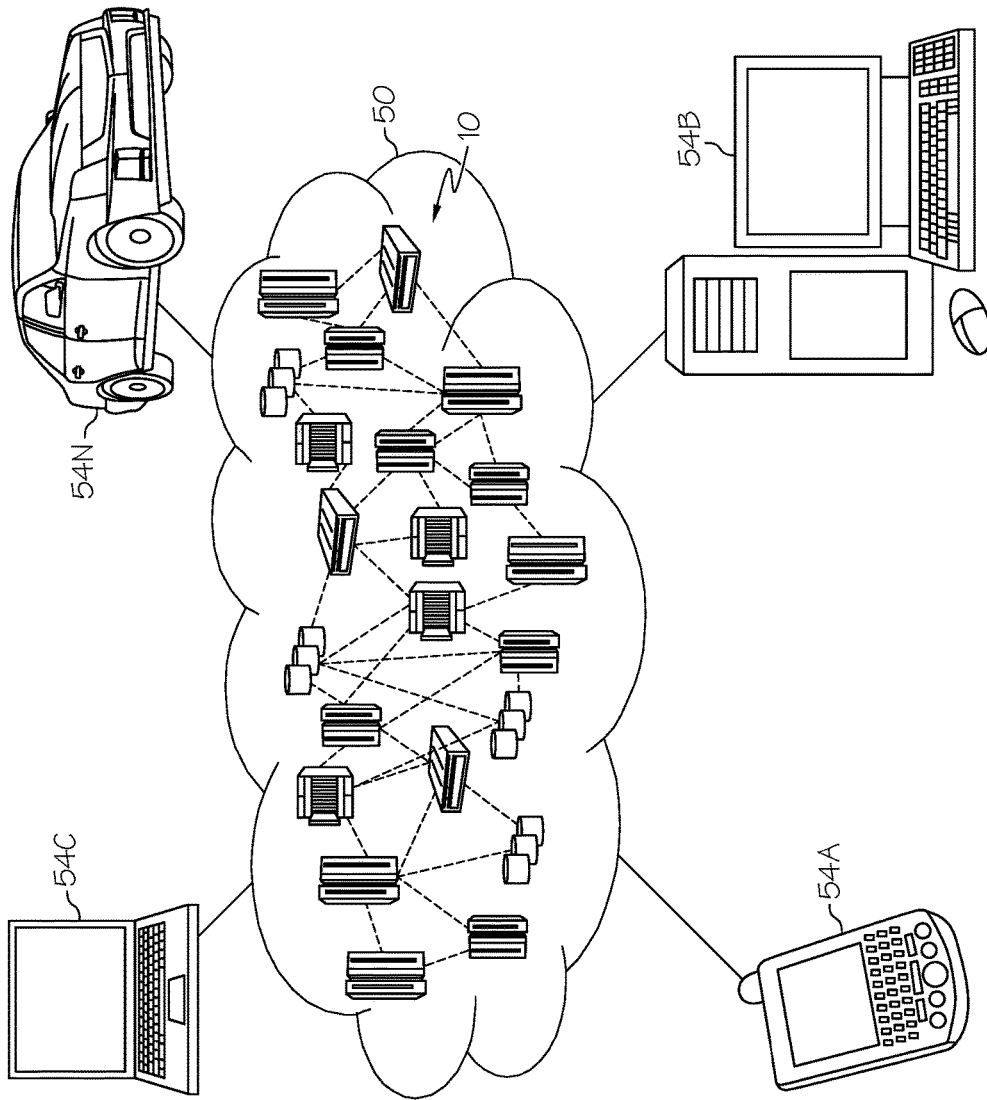

FIG. 8

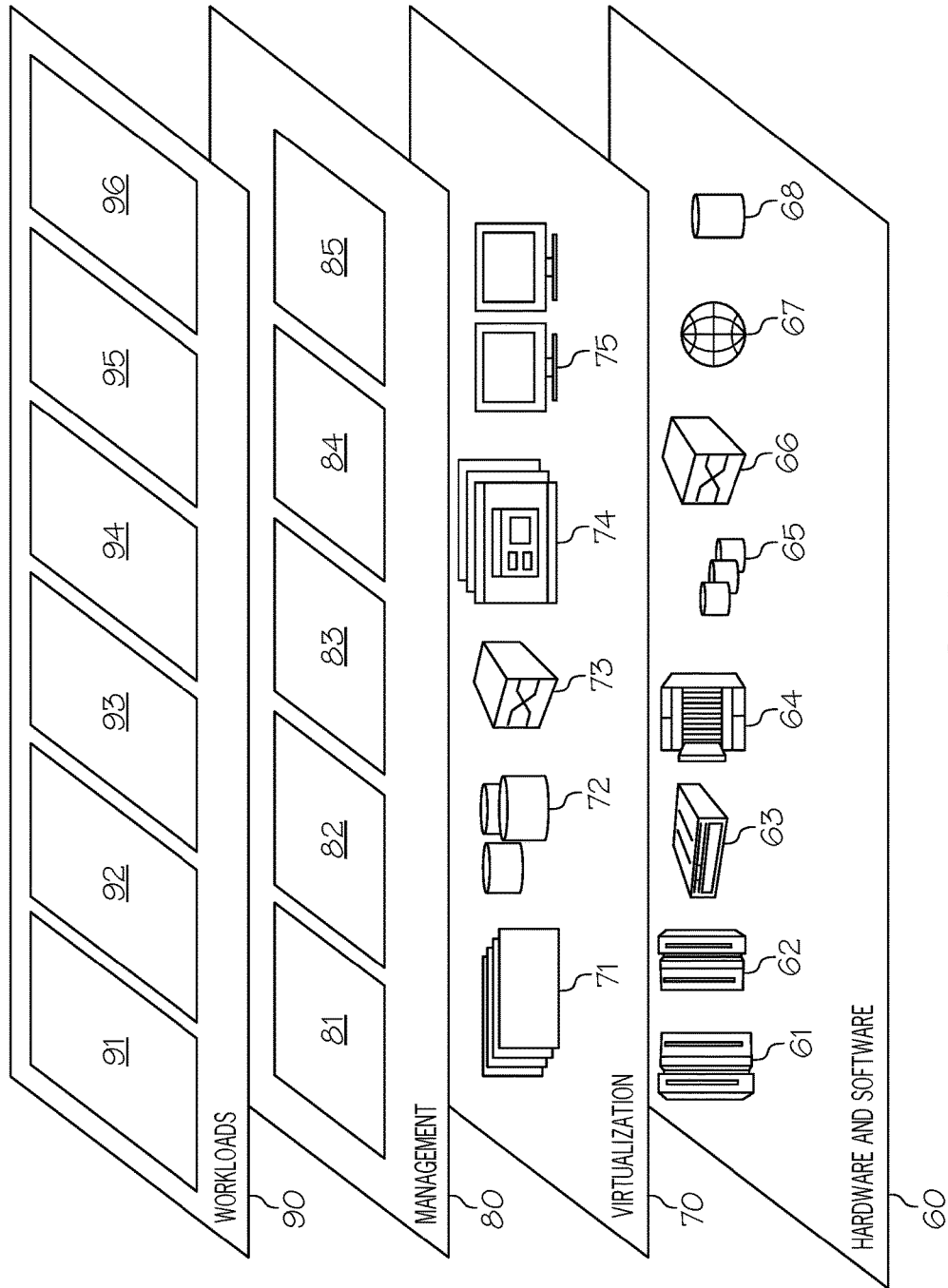

FIG. 9

1

## SELF-DRIVING VEHICLE ROAD SAFETY FLARE DEPLOYING SYSTEM

### BACKGROUND

The present disclosure relates to the field of self-driving vehicles, and specifically to self-driving vehicles that are tasked with ameliorating roadway hazards. More specifically, the present disclosure relates to the use of a self-driving vehicle to deploy, from the self-driving vehicle and/or from an aerial drone, a road safety flare warning of the presence of a faulty SDV.

Self-driving vehicles (SDVs) are vehicles that are able to autonomously drive themselves through private and/or public spaces. Using a system of sensors that detect the location and/or surroundings of the SDV, logic within or associated with the SDV controls the speed, propulsion, braking, and steering of the SDV based on the sensor-detected location and surroundings of the SDV.

An aerial drone, also known as an unmanned aerial vehicle (UAV) or a flying drone, is an unmanned airborne vehicle that is capable of being piloted without an on-board human pilot. If autonomously controlled using an on-board computer and pre-programmed instructions, a UAV is called an autonomous drone. If remotely piloted by a human pilot, the UAV is called a remotely piloted aircraft (RPA).

### SUMMARY

In one or more embodiments of the present invention, a method deploys a road safety flare near a faulty self-driving vehicle (SDV). One or more processors detect a driving problem severity level for a faulty SDV. One or more processors assess environmental conditions at the location of the faulty SDV. One or more processors determine an opportune position for deploying the road safety flare based on the environmental conditions at the location of the faulty SDV and then deploy, according to directions from the faulty SDV, a road safety flare at the opportune position.

The aforementioned invention may also be implemented as a system and/or computer program product.

### BRIEF DESCRIPTION OF THE DRAWINGS

FIG. 1 depicts an exemplary system and network in which the present disclosure may be implemented;

FIG. 2 depicts a self-driving vehicle (SDV) and/or aerial drone deploying a road safety flare near a faulty SDV on a roadway in accordance with one or more embodiments of the present invention;

FIG. 3 illustrates additional hardware detail of the SDV shown in FIG. 2 in accordance with one or more embodiments of the present invention;

FIG. 4 depicts detail of the exemplary aerial drone shown in FIG. 2 as used in accordance with one or more embodiments of the present invention;

FIG. 5 illustrates control hardware and other hardware features of the exemplary aerial drone shown in FIG. 4 in accordance with one or more embodiments of the present invention;

FIG. 6 is a high-level flow chart illustrating a process in accordance with one or more embodiments of the present invention;

FIG. 7 illustrates a road safety flare with associated road safety flare control logic in accordance with one or more embodiments of the present invention;

2

FIG. 8 depicts a cloud computing environment according to an embodiment of the present invention; and

FIG. 9 depicts abstraction model layers of a cloud computer environment according to an embodiment of the present invention.

### DETAILED DESCRIPTION

The present invention may be a system, a method, and/or a computer program product at any possible technical detail level of integration. The computer program product may include a computer readable storage medium (or media) having computer readable program instructions thereon for causing a processor to carry out aspects of the present invention.

The computer readable storage medium can be a tangible device that can retain and store instructions for use by an instruction execution device. The computer readable storage medium may be, for example, but is not limited to, an electronic storage device, a magnetic storage device, an optical storage device, an electromagnetic storage device, a semiconductor storage device, or any suitable combination of the foregoing. A non-exhaustive list of more specific examples of the computer readable storage medium includes the following: a portable computer diskette, a hard disk, a random access memory (RAM), a read-only memory (ROM), an erasable programmable read-only memory (EPROM or Flash memory), a static random access memory (SRAM), a portable compact disc read-only memory (CD-ROM), a digital versatile disk (DVD), a memory stick, a floppy disk, a mechanically encoded device such as punch-cards or raised structures in a groove having instructions recorded thereon, and any suitable combination of the foregoing. A computer readable storage medium, as used herein, is not to be construed as being transitory signals per se, such as radio waves or other freely propagating electromagnetic waves, electromagnetic waves propagating through a waveguide or other transmission media (e.g., light pulses passing through a fiber-optic cable), or electrical signals transmitted through a wire.

Computer readable program instructions described herein can be downloaded to respective computing/processing devices from a computer readable storage medium or to an external computer or external storage device via a network, for example, the Internet, a local area network, a wide area network and/or a wireless network. The network may comprise copper transmission cables, optical transmission fibers, wireless transmission, routers, firewalls, switches, gateway computers and/or edge servers. A network adapter card or network interface in each computing/processing device receives computer readable program instructions from the network and forwards the computer readable program instructions for storage in a computer readable storage medium within the respective computing/processing device.

Computer readable program instructions for carrying out operations of the present invention may be assembler instructions, instruction-set-architecture (ISA) instructions, machine instructions, machine dependent instructions, microcode, firmware instructions, state-setting data, or either source code or object code written in any combination of one or more programming languages, including an object oriented programming language such as Java, Smalltalk, C++ or the like, and conventional procedural programming languages, such as the "C" programming language or similar programming languages. The computer readable program instructions may execute entirely on the user's computer, partly on the user's computer, as a stand-alone software

package, partly on the user's computer and partly on a remote computer or entirely on the remote computer or server. In the latter scenario, the remote computer may be connected to the user's computer through any type of network, including a local area network (LAN) or a wide area network (WAN), or the connection may be made to an external computer (for example, through the Internet using an Internet Service Provider). In some embodiments, electronic circuitry including, for example, programmable logic circuitry, field-programmable gate arrays (FPGA), or programmable logic arrays (PLA) may execute the computer readable program instructions by utilizing state information of the computer readable program instructions to personalize the electronic circuitry, in order to perform aspects of the present invention.

Aspects of the present invention are described herein with reference to flowchart illustrations and/or block diagrams of methods, apparatus (systems), and computer program products according to embodiments of the invention. It will be understood that each block of the flowchart illustrations and/or block diagrams, and combinations of blocks in the flowchart illustrations and/or block diagrams, can be implemented by computer readable program instructions.

These computer readable program instructions may be provided to a processor of a general purpose computer, special purpose computer, or other programmable data processing apparatus to produce a machine, such that the instructions, which execute via the processor of the computer or other programmable data processing apparatus, create means for implementing the functions/acts specified in the flowchart and/or block diagram block or blocks. These computer readable program instructions may also be stored in a computer readable storage medium that can direct a computer, a programmable data processing apparatus, and/or other devices to function in a particular manner, such that the computer readable storage medium having instructions stored therein comprises an article of manufacture including instructions which implement aspects of the function/act specified in the flowchart and/or block diagram block or blocks.

The computer readable program instructions may also be loaded onto a computer, other programmable data processing apparatus, or other device to cause a series of operational steps to be performed on the computer, other programmable apparatus or other device to produce a computer implemented process, such that the instructions which execute on the computer, other programmable apparatus, or other device implement the functions/acts specified in the flowchart and/or block diagram block or blocks.

The flowchart and block diagrams in the Figures illustrate the architecture, functionality, and operation of possible implementations of systems, methods, and computer program products according to various embodiments of the present invention. In this regard, each block in the flowchart or block diagrams may represent a module, segment, or portion of instructions, which comprises one or more executable instructions for implementing the specified logical function(s). In some alternative implementations, the functions noted in the block may occur out of the order noted in the figures. For example, two blocks shown in succession may, in fact, be executed substantially concurrently, or the blocks may sometimes be executed in the reverse order, depending upon the functionality involved. It will also be noted that each block of the block diagrams and/or flowchart illustration, and combinations of blocks in the block diagrams and/or flowchart illustration, can be implemented by special purpose hardware-based systems that perform the

specified functions or acts or carry out combinations of special purpose hardware and computer instructions.

With reference now to the figures, and in particular to FIG. 1, there is depicted a block diagram of an exemplary system and network that may be utilized by and/or in the implementation of the present invention. Some or all of the exemplary architecture, including both depicted hardware and software, shown for and within computer 101 may be utilized by drone on-board computer 123 and/or positioning system 151, and/or SDV/drone controller system 201 shown in FIG. 2, and/or SDV on-board computer 301 shown in FIG. 3, and/or drone on-board computer 423 and/or the road safety flare support system controller 424 shown in FIG. 4, and/or drone mechanisms controller 501 shown in FIG. 5, and/or road safety flare control logic 701 shown in FIG. 7.

Exemplary computer 101 includes a processor 103 that is coupled to a system bus 105. Processor 103 may utilize one or more processors, each of which has one or more processor cores. A video adapter 107, which drives/supports a display 109, is also coupled to system bus 105. System bus 105 is coupled via a bus bridge 111 to an input/output (I/O) bus 113. An I/O interface 115 is coupled to I/O bus 113. I/O interface 115 affords communication with various I/O devices, including a transceiver 117 (capable of transmitting and receiving electromagnetic transmissions), a camera 119 (i.e., a digital camera capable of capturing still and moving images), a media tray 121 (which may include storage devices such as CD-ROM drives, multi-media interfaces, etc.), and external USB port(s) 125. While the format of the ports connected to I/O interface 115 may be any known to those skilled in the art of computer architecture, in one embodiment some or all of these ports are universal serial bus (USB) ports.

Also coupled to I/O interface 115 is a positioning system 151, which determines a position of computer 101 and/or other devices using positioning sensors 153. Positioning sensors 153 may be any type of sensors that are able to determine a position of a device, including computer 101, an aerial drone 200 and/or self-driving vehicle (SDV) 202 shown in FIG. 2, etc. Positioning sensors 153 may utilize, without limitation, satellite based positioning devices (e.g., global positioning system—GPS based devices), accelerometers (to measure change in movement), barometers (to measure changes in altitude), etc.

As depicted, computer 101 is also able to communicate (besides via transceiver 117) with a software deploying server 149 and/or other devices/systems (e.g., drone on-board computer 123 and/or a software deploying server 149) using a network interface 129. Network interface 129 is a hardware network interface, such as a network interface card (NIC), etc. Network 127 may be an external network such as the Internet, or an internal network such as an Ethernet or a virtual private network (VPN). In one or more embodiments, network 127 is a wireless network, such as a Wi-Fi network, a cellular network, etc.

A hard drive interface 131 is also coupled to system bus 105. Hard drive interface 131 interfaces with a hard drive 133. In one embodiment, hard drive 133 populates a system memory 135, which is also coupled to system bus 105. System memory is defined as a lowest level of volatile memory in computer 101. This volatile memory includes additional higher levels of volatile memory (not shown), including, but not limited to, cache memory, registers and buffers. Data that populates system memory 135 includes computer 101's operating system (OS) 137 and application programs 143.

OS **137** includes a shell **139**, for providing transparent user access to resources such as application programs **143**. Generally, shell **139** is a program that provides an interpreter and an interface between the user and the operating system. More specifically, shell **139** executes commands that are entered into a command line user interface or from a file. Thus, shell **139**, also called a command processor, is generally the highest level of the operating system software hierarchy and serves as a command interpreter. The shell provides a system prompt, interprets commands entered by keyboard, mouse, or other user input media, and sends the interpreted command(s) to the appropriate lower levels of the operating system (e.g., a kernel **141**) for processing. While shell **139** is a text-based, line-oriented user interface, the present invention will equally well support other user interface modes, such as graphical, voice, gestural, etc.

As depicted, OS **137** also includes kernel **141**, which includes lower levels of functionality for OS **137**, including providing essential services required by other parts of OS **137** and application programs **143**, including memory management, process and task management, disk management, and mouse and keyboard management.

Application programs **143** include a renderer, shown in exemplary manner as a browser **145**. Browser **145** includes program modules and instructions enabling a world wide web (WWW) client (i.e., computer **101**) to send and receive network messages to the Internet using hypertext transfer protocol (HTTP) messaging, thus enabling communication with software deploying server **149** and other systems.

Application programs **143** in computer **101**'s system memory also include Logic for Road Safety Flare Deployment (LRSFD) **147**. LRSFD **147** includes code for implementing the processes described below, including those described in FIGS. 2-6. In one embodiment, computer **101** is able to download LRSFD **147** from software deploying server **149**, including in an on-demand basis. In one embodiment, software deploying server **149** is able to execute one or more instructions from LRSFD **147** and provide the results to computer **101**, thus relieving computer **101** from the need to utilize its internal processing power.

The hardware elements depicted in computer **101** are not intended to be exhaustive, but rather are to highlight certain components used in some embodiments of the present invention. For instance, computer **101** may include alternate memory storage devices such as magnetic cassettes, digital versatile disks (DVDs), Bernoulli cartridges, and the like. These and other variations are intended to be within the spirit and scope of the present invention.

With reference now to FIG. 2, assume that a faulty SDV **202** is disabled or otherwise operating in a diminished capacity while on a driving surface **204** (e.g., a roadway, a parking lot, etc.). Faulty SDV **202** (also referred to herein simply as SDV **202**) thus poses a navigation/traffic hazard to other vehicles on the driving surface **204**. Assume now that faulty SDV **202** experiences some type of mechanical problem, which causes it to lose power, and thus pulls over to the side of the driving surface **204** (e.g., onto a shoulder of the driving surface **204**). As such, the present invention provides a system for deploying road safety flares **226** onto the driving surface **204** at a position that is an optimal distance **208** away from the faulty SDV **202**. In one or more embodiments of the present invention, one or more of the road safety flares **226** are deployed directly from the faulty SDV **202** (i.e., are dropped onto the driving surface **204** as the faulty SDV **202** rolls to a stop). In one or more embodiments of the present invention, one or more of the road safety flares **226** are deployed from an aerial drone **200**, under the

direction/control of faulty SDV **202** and/or an SDV/drone controller system **201** shown in FIG. 2.

That is, in one embodiment the road safety flares **226** are deployed directly by the SDV **202**. However, there may be occasions in which the faulty SDV **202** determines that it is unable to place the road safety flares **226** in the proper position (e.g., due to the incapacity or stopped position of the faulty SDV **202**, due to current traffic conditions, due to icing/flooding conditions on the driving surface **204**, due to a lack of power, etc.). As such, the SDV **202** may summon the aerial drone **200** to deliver and deploy the road safety flares **226**. In one embodiment, the aerial drone **200** already is carrying the road safety flare(s) **226**. However, in another embodiment, the aerial drone **200** will first pick up the needed road safety flare(s) **226** from the faulty SDV **202**, which is likely to have a larger carrying capacity than the aerial drone **200**.

In an embodiment of the present invention, the aerial drone **200** and/or the faulty SDV **202** are under the control of a remote SDV/drone controller system **201**, which is able to communicate (e.g., via wireless transmissions) to the aerial drone **200** and/or faulty SDV **202**.

In an embodiment of the present invention, the faulty SDV **202** operates autonomously when deploying one or more of the road safety flares **226** that are deployable and removably coupled to the faulty SDV **202**.

In an embodiment of the present invention, the faulty SDV **202** controls the operation of the aerial drone **200**, including positioning the aerial drone **200**, directing the aerial drone **200** to deploy one or more of the road safety flares **226**, etc.

In an embodiment of the present invention, the road safety flare **226** is mounted on a rolling platform **212**, which is deployed from the faulty SDV **202** and/or the aerial drone **200**. Within the rolling platform **212** are control systems, receivers, etc. that allow the faulty SDV **202** and/or SDV/drone controller system **201** to maneuver the rolling platform **212** to an opportune position. That is, the rolling platform **212** may include a remote control, powered wheels, and a transceiver capable of receiving a signal from faulty SDV **202** to position the rolling platform **212** at the opportune position for one or more of the road safety flares **226** to be visible to other vehicles.

With reference now to FIG. 3, additional details of one or more embodiments of the faulty SDV **202** are presented.

As shown in FIG. 3, SDV **202** has an SDV on-board computer **301** that controls operations of the SDV **202**. According to directives from a driving mode device **307**, the SDV **202** can be selectively operated in manual mode or autonomous mode. In a preferred embodiment, driving mode device **307** is a dedicated hardware device that selectively directs the SDV on-board computer **301** to operate the SDV **202** in one of the autonomous modes or in the manual mode.

While in autonomous mode, SDV **202** operates without the input of a human driver, such that the engine, steering mechanism, braking system, horn, signals, etc. are controlled by the SDV control processor **303**, which is now under the control of the SDV on-board computer **301**. That is, by the SDV on-board computer **301** processing inputs taken from navigation and control sensors **309** and the driving mode device **307** (indicating that the SDV **202** is to be controlled autonomously), then driver inputs to the SDV control processor **303** and/or SDV vehicular physical control mechanisms **305** are no longer needed.

As just mentioned, the SDV on-board computer **301** uses outputs from navigation and control sensors **309** to control



the SDV **202**. Navigation and control sensors **309** include hardware sensors that 1) determine the location of the SDV **202**; 2) sense other cars and/or obstacles and/or physical structures around SDV **202**; 3) measure the speed and direction of the SDV **202**; and 4) provide any other inputs needed to safely control the movement of the SDV **202**.

With respect to the feature of 1) determining the location of the SDV **202**, this can be achieved through the use of a positioning system such as positioning system **151** shown in FIG. 1. Positioning system **151** may use a global positioning system (GPS), which uses space-based satellites that provide positioning signals that are triangulated by a GPS receiver to determine a 3-D geophysical position of the SDV **202**. Positioning system **151** may also use, either alone or in conjunction with a GPS system, physical movement sensors such as accelerometers (which measure acceleration of a vehicle in any direction), speedometers (which measure the instantaneous speed of a vehicle), airflow meters (which measure the flow of air around a vehicle), etc. Such physical movement sensors may incorporate the use of semiconductor strain gauges, electromechanical gauges that take readings from drivetrain rotations, barometric sensors, etc.

With respect to the feature of 2) sensing other cars and/or obstacles and/or physical structures around SDV **202**, the positioning system **151** may use radar or other electromagnetic energy that is emitted from an electromagnetic radiation transmitter (e.g., transceiver **323** shown in FIG. 3), bounced off a physical structure (e.g., another car), and then received by an electromagnetic radiation receiver (e.g., transceiver **323**). An exemplary positioning system within SDV **202** is a Light Detection and Ranging (LIDAR) (e.g., LIDAR **333** shown in FIG. 3) or Laser Detection and Ranging (LADAR) system that measures the time it takes to receive back the emitted electromagnetic radiation (e.g., light), and/or evaluate a Doppler shift (i.e., a change in frequency to the electromagnetic radiation that is caused by the relative movement of the SDV **202** to objects being interrogated by the electromagnetic radiation) in the received electromagnetic radiation from when it was transmitted, the presence and location of other physical objects can be ascertained by the SDV on-board computer **301**.

With respect to the feature of 3) measuring the speed and direction of the SDV **202**, this can be accomplished by taking readings from an on-board speedometer (not depicted) on the SDV **202** and/or detecting movements to the steering mechanism (also not depicted) on the SDV **202** and/or the positioning system **151** discussed above.

With respect to the feature of 4) providing any other inputs needed to safely control the movement of the SDV **202**, such inputs include, but are not limited to, control signals to activate a horn, turning indicators, flashing emergency lights, etc. on the SDV **202**.

In one or more embodiments of the present invention, SDV **202** includes roadway sensors **311** that are coupled to the SDV **202**. Roadway sensors **311** may include sensors that are able to detect the amount of water, snow, ice, etc. on the roadway **204** (e.g., using cameras, heat sensors, moisture sensors, thermometers, etc.). Roadway sensors **311** also include sensors that are able to detect “rough” roadways (e.g., roadways having potholes, poorly maintained pavement, no paving, etc.) using cameras, vibration sensors, etc. Roadway sensors **311** may also include sensors that are also able to detect how dark the roadway **204** is using light sensors.

Similarly, a dedicated camera **321** can be trained on roadway **204**, in order to provide photographic images of conditions on the roadway **204** upon which the SDV **202** is traveling.

Similarly, a dedicated object motion detector **319** (e.g., a radar transceiver capable of detecting Doppler shifts indicative of the speed and direction of movement of other vehicles, animals, persons, etc. on the roadway **204**) can be trained on the roadway **204** upon which the SDV **202** is traveling.

In one or more embodiments of the present invention, also within the SDV **202** are SDV equipment sensors **315**. SDV equipment sensors **315** may include cameras aimed at tires on the SDV **202** to detect how much tread is left on the tire. SDV equipment sensors **315** may include electronic sensors that detect how much padding is left of brake calipers on disk brakes. SDV equipment sensors **315** may include drivetrain sensors that detect operating conditions within an engine (e.g., power, speed, revolutions per minute—RPMs of the engine, timing, cylinder compression, coolant levels, engine temperature, oil pressure, etc.), the transmission (e.g., transmission fluid level, conditions of the clutch, gears, etc.), etc. SDV equipment sensors **315** may include sensors that detect the condition of other components of the SDV **202**, including lights (e.g., using circuitry that detects if a bulb is broken), wipers (e.g., using circuitry that detects a faulty wiper blade, wiper motor, etc.), etc.

In one or more embodiments of the present invention, also within SDV **202** is a communications transceiver **317**, which is able to receive and transmit electronic communication signals (e.g., RF messages) from and to other communications transceivers found in other vehicles, servers, monitoring systems, etc.

In one or more embodiments of the present invention, also within SDV **202** is a telecommunication device **325** (e.g., a smart phone, a cell phone, a laptop computer, etc.), which may be connected (e.g., via a near field communication—NFC connection) to the SDV on-board computer **301**.

In one or more embodiments of the present invention, also within SDV **202** is a biometric sensor **335**, which may be a camera that captures and analyzes certain facial expressions and/or body language (indicative of an anxious state), a respiration monitor (capturing shallow breathing, indicative of the anxious state), a blood pressure monitor (capturing high blood pressure, indicative of the anxious state), etc.

In one or more embodiments of the present invention, also within SDV **202** is a proximity sensor **341**, which uses motion detectors, radar (using Doppler shifting logic), etc. that detect an object (e.g., a vehicle in a next lane) near SDV **202**.

In one or more embodiments of the present invention, also within SDV **202** is a road safety flare deployment system **343**, which is a system that is able to 1) hold a road safety flare, 2) activate the road safety flare (e.g., pull a fuse tape on a pyrotechnic flare), and/or 3) deploy (e.g., drop onto a roadway) the road safety flare (as directed by the SDV on-board computer **301**).

With reference now to FIG. 4, details of the aerial drone **200** shown in FIG. 2 are presented in accordance with one or more embodiments of the present invention. The terms “aerial drone”, “drone”, and “unmanned aerial vehicle” (“UAV”) are used interchangeably herein to identify and describe an airborne vehicle that is capable of pilot-less flight.

As shown in FIG. 4, aerial drone **200** includes a body **402**, which is attached to supports such as support **404**. Supports such as support **404** support stanchions such as stanchion

406. Such stanchions provide a housing for a driveshaft within each of the stanchions, such as the depicted driveshaft 408 within stanchion 406. These driveshafts are connected to propellers. For example, driveshaft 408 within stanchion 406 is connected to propeller 410.

A power transfer mechanism 412 (e.g., a chain, a primary driveshaft, etc.) transfers power from a geared transmission 414 to the driveshafts within the stanchions (e.g., from geared transmission 414 to the driveshaft 408 inside stanchion 406), such that propeller 410 is turned, thus providing lift and steering to the aerial drone 400. Geared transmission 414 preferably contains a plurality of gears, such that a gear ratio inside geared transmission 414 can be selectively changed.

Power to the geared transmission 414 is selectively provided by an electric motor 416 (which is supplied with electrical power by a battery 418) or an internal combustion engine 420, which burns fuel from a fuel tank (not shown). In one or more embodiments of the present invention, the internal combustion engine 420 has greater power than the electric motor 416, since internal combustion engines are able to produce greater torque/power and have a greater range (can fly farther) than electric motors of the same size/weight.

Affixed to body 402 is a road safety flare support system 422 that holds one or more road safety flares, including the depicted road safety flare 426. Road safety flare support system 422 includes release mechanisms 434 (e.g., gears, hinges, etc. whose movement is controlled by the road safety flare support system controller 424) that allow the aerial drone 200 to pick up (take on board) and release (drop/deploy) the road safety flare 426.

Road safety flare 426 may be an electronic road safety device, a pyrotechnic device, etc. Furthermore, in one or more embodiments a control device (not shown) may be affixed to road safety flare 426. For example, a remotely controlled device may be able to pull the fuse tape off a pyrotechnic device, turn off, on, speed up, etc. battery-powered lights in an electronic road safety device, etc.

Also affixed to body 402 is a camera 419 (analogous to camera 119 shown in FIG. 1), which is able to take digital still and moving pictures under the control of the drone on-board computer 423.

Also affixed to body 402 is an environmental sensor 430, which is communicatively coupled to drone on-board computer 423. Environmental sensor 430 detects ambient conditions around the aerial drone 200. For example, environmental sensor 430 may be a light sensor that detects ambient lighting conditions; environmental sensor 430 may be a weather sensor that detects ambient weather conditions such as rain, snow, fog, etc. using one or more of a thermometer, barometer, microphone camera, moisture detector, etc.; environmental sensor 430 may be a traffic sensor that detects ambient traffic conditions using a light sensor (for detecting oncoming headlights), a microphone (for detecting the sound of traffic), a camera (for photographing local traffic), etc.

Also affixed to aerial drone 200 is a vehicle sensor 432. While environmental sensor 430 can detect traffic conditions (i.e., general pattern of local traffic), vehicle sensor 432 detects an individual oncoming vehicle and its state. For example, vehicle sensor 432 may be a Doppler-enabled transceiver that sends and receives an electromagnetic signal towards an oncoming vehicle (which is detected by camera 419), in order to detect the speed, direction, and current location of the oncoming vehicle.

With reference now to FIG. 5, exemplary control hardware within the aerial drone 200 presented in FIG. 4 is depicted.

The drone on-board computer 423 depicted in FIG. 4 is able to control a drone mechanisms controller 501, which is a computing device that controls a set of drone physical control mechanisms 503. The set of drone physical control mechanisms 503 includes, but is not limited to, throttles for internal combustion engine 420 and/or electric motor 416, selectors for selecting gear ratios within the geared transmission 414, controls for adjusting the pitch, roll, and angle of attack of propellers such as propeller 410 and other controls used to control the operation and movement of the aerial drone 200 depicted in FIG. 4.

Whether in autonomous mode or remotely-piloted mode, the drone on-board computer 423 controls the operation of aerial drone 200. This control includes the use of outputs from navigation and control sensors 505 to control the aerial drone 200. Navigation and control sensors 505 include hardware sensors that (1) determine the location of the aerial drone 200; (2) sense other aerial drones and/or obstacles and/or physical structures around aerial drone 200; (3) measure the speed and direction of the aerial drone 200; and (4) provide any other inputs needed to safely control the movement of the aerial drone 200.

With respect to the feature of (1) determining the location of the aerial drone 200, this is achieved in one or more embodiments of the present invention through the use of a positioning system such as positioning system 151 (shown in FIG. 1), which may be part of the drone on-board computer 423, combined with positioning sensor 553 (e.g., accelerometers, global positioning system (GPS) sensors, altimeters, etc.). That is, positioning system 151 may use a global positioning system (GPS), which uses space-based satellites that provide positioning signals that are triangulated by a GPS receiver to determine a 3-D geophysical position of the aerial drone 200. Positioning system 151 may also use, either alone or in conjunction with a GPS system, physical movement sensors (i.e., positioning sensor 553) such as accelerometers (which measure changes in direction and/or speed by an aerial drone in any direction in any of three dimensions), speedometers (which measure the instantaneous speed of an aerial drone), airflow meters (which measure the flow of air around an aerial drone), barometers (which measure altitude changes by the aerial drone), etc. Such physical movement sensors may incorporate the use of semiconductor strain gauges, electromechanical gauges that take readings from drivetrain rotations, barometric sensors, etc.

With respect to the feature of (2) sensing other aerial drones and/or obstacles and/or physical structures around aerial drone 200, the drone on-board computer 423 may utilize radar or other electromagnetic energy that is emitted from an electromagnetic radiation transmitter (e.g., transceiver 507 shown in FIG. 5), bounced off a physical structure (e.g., a building, bridge, or another aerial drone), and then received by an electromagnetic radiation receiver (e.g., transceiver 507). By measuring the time it takes to receive back the emitted electromagnetic radiation, and/or evaluating a Doppler shift (i.e., a change in frequency to the electromagnetic radiation that is caused by the relative movement of the aerial drone 200 to objects being interrogated by the electromagnetic radiation) in the received electromagnetic radiation from when it was transmitted, the presence and location of other physical objects can be ascertained by the drone on-board computer 423.

With respect to the feature of (3) measuring the speed and direction of the aerial drone **200**, this is accomplished in one or more embodiments of the present invention by taking readings from an on-board airspeed indicator (not depicted) on the aerial drone **200** and/or detecting movements to the control mechanisms (depicted in FIG. **4**) on the aerial drone **200** and/or the positioning system **151** discussed above.

With respect to the feature of (4) providing any other inputs needed to safely control the movement of the aerial drone **200**, such inputs include, but are not limited to, control signals to direct the aerial drone **200** to make an emergency landing, etc.

Also on aerial drone **200** in one or more embodiments of the present invention is the camera **419** also shown in FIG. **4**, which is capable of sending still or moving visible light digital photographic images (and/or infrared light digital photographic images) to the drone on-board computer **423**. These images can be used to determine the location of the aerial drone **200** (e.g., by matching to known landmarks), to sense other drones/obstacles, and/or to determine speed (by tracking changes to images passing by) of the aerial drone.

Also on aerial drone **200** in one or more embodiments of the present invention are sensors **515**. Examples of sensors **515** include, but are not limited to, air pressure gauges, microphones, barometers, chemical sensors, vibration sensors, etc., which detect a real-time operational condition of aerial drone **200** and/or an environment around aerial drone **200**. Another example of a sensor from sensors **515** is a light sensor, which is able to detect light from other drones, street lights, home lights, etc., in order to ascertain the environment in which the aerial drone **200** is operating.

Also on aerial drone **200** in one or more embodiments of the present invention are lights **509**. Lights **509** are activated by drone on-board computer **423** to provide visual warnings, alerts, etc.

Also on aerial drone **200** in one or more embodiments of the present invention is a speaker **511**. Speaker **511** is used by drone on-board computer **423** to provide aural warnings, alerts, etc.

Also on aerial drone **200** in one or more embodiments of the present invention is a microphone **517**. In an embodiment, microphone **517** is an omnidirectional sensor that measures ambient noise (e.g., sound produced by the aerial drone **200**). In the same or another embodiment, microphone **517** is a directional microphone (e.g., that captures sounds at some distance away from the aerial drone **200**).

With reference now to FIG. **6**, a high-level flow chart illustrating a process in accordance with one or more embodiments of the present invention is presented.

After initiator block **602**, one or more processors (e.g., within SDV **202** and/or SDV/drone controller system **201** shown in FIG. **2**) detect a driving problem severity level for a faulty SDV (e.g., faulty SDV **202** shown in FIG. **2**), as described in block **604**. That is, a vehicle that is disabled on a roadway due to a mechanical breakdown or a driver being incapacitated is detected by the SDV **202** and/or the SDV/drone controller system **201**. This detection may be made visually (e.g., using video images captured by the SDV **202** traveling near and/or SDV/drone controller system **201** mounted near the faulty SDV **202**), electronically (based on distress radio signals being sent from a transmitter within the faulty SDV **202**), etc.

For example, assume that some or all of the architecture shown in FIG. **3** is in faulty SDV **202**. As such, faulty SDV **202** is able not only to report on mechanical problems within faulty SDV **202**, but also any incapacity problems associated with a driver of the faulty SDV **202**.

As described in block **606**, one or more processors assess environmental conditions at the location of the faulty SDV. That is, sensors on the SDV **202** and/or the aerial drone **200** will detect traffic conditions, weather conditions, roadway conditions, etc. around the faulty SDV **202**.

As described in block **608**, one or more processors then determine an opportune position for deploying the road safety flare (e.g., the optimal distance **208** behind the faulty SDV **202**) based on the environmental conditions at the location of the faulty SDV.

As described in block **610**, the SDV **202** then issues directions to deploy the road safety flare at the opportune position.

The flow-chart ends at terminator block **612**.

In an embodiment of the present invention, the directions from the SDV **202** to deploy the road safety flare at the opportune position are issued to the SDV **202** itself (e.g., from the SDV on-board computer **301** to the road safety flare deployment system **343** shown in FIG. **3**).

In an embodiment of the present invention, the directions from the SDV **202** to deploy the road safety flare at the opportune position are issued to the aerial drone **200** shown in FIG. **4**. That is, the SDV **202** will transmit a wireless signal to the drone on-board computer **423** and/or the road safety flare support system controller **424** shown in FIG. **4** to deploy the road safety flare at the opportune position.

In an embodiment of the present invention in which the SDV **202** and/or other systems are able to control the operation of the aerial drone **200**, one or more processors (e.g., within aerial drone **200**) are able to detect a presence of airborne hazards above the opportune position. That is, sensors on aerial drone **200** are able to detect smoke or hazardous gasses (e.g., using environmental sensor **430** shown in FIG. **4** when configured to detect the presence of certain gasses), other flying objects such as other aerial drones (e.g., using camera **419** shown in FIG. **4**), etc. that are in the airspace above the faulty SDV **202**. The processor(s) then determine a safe altitude (e.g., above the airspace in which the hazardous gases, other drones, overhead obstructions such as bridges, tree branches, etc. exist) from which to deploy the road safety flare from the aerial drone. That is, the safe altitude, which is determined based on the presence of airborne hazards above at the opportune position, is the altitude above or below these airborne hazards. These regions (above or below the airborne hazards) are deemed to be the safe altitude. The processors then position the aerial drone at this safe altitude above the opportune position, in order to keep the aerial drone safe.

In an embodiment of the present invention, the severity level (for the faulty SDV) is based on hazards posed by the faulty SDV itself, such as the faulty SDV about to come to a stop (the faulty SDV imminently stopping), how much danger is posed to other vehicles by the faulty SDV being disabled on the roadway (a risk estimation of a risk presented by the faulty SDV while the faulty SDV is disabled on a road), what types of hazards (fire, explosion, traffic blockage) will be caused by an engine malfunction in the faulty SDV, a radiator malfunction in the faulty SDV, an electrical malfunction in the faulty SDV, a flat tire on the faulty SDV, and/or an accident involving the faulty SDV, etc.

In an embodiment of the present invention, the severity level (for the faulty SDV) is based on a safety hazard to an occupant of the faulty SDV. That is, in addition to (or rather than) determining the severity level for the faulty SDV based on what types of hazards/exposures the faulty SDV poses to other vehicles, the system will determine how much danger

occupants of the faulty SDV are in, and use this information to determine if and how to deploy the road safety flare. That is, if the occupant of the faulty SDV is merely stopping briefly on the side of the road (e.g., to make a phone call while parked), then no road safety flares are needed. However, if the occupant of the faulty SDV is having a heart attack (as detected by biometric sensors within the cabin of the faulty SDV), then one or more road safety flares will be deployed around the faulty SDV.

In accordance with various embodiments of the present invention, the road safety flare may be an electronic safety flare (e.g., a battery-operated light emitting diode (LED) device), a pyrotechnic safety flare (e.g., a solid fuel flare that is ignited by pulling off ignition tape), a radio signal transmitting safety flare (e.g., a device that broadcasts a warning signal to any radio receiver within a predetermined range, e.g., 500 feet), etc. That is, in the embodiment in which the road safety flare is a radio signal transmitting safety flare, the radio signal transmitting safety flare will broadcast a signal (e.g., a loud tone) across multiple radio frequencies, which are picked up on radio receivers in oncoming vehicles, which cause the loud tone to be generated by speakers in the cabin of the oncoming vehicles.

In an embodiment of the present invention, assume that the faulty SDV is on a roadway. In such an embodiment, the SDV may deploy the road safety flare directly onto the roadway in order to deploy the road safety flare from the SDV at the opportune position.

However, in another embodiment, the road safety flare is mounted to a remotely-maneuverable rolling platform (e.g., rolling platform **212** shown in FIG. 2). Thus, in this embodiment, the SDV will first deploy the remotely-maneuverable rolling platform with the road safety flare mounted thereon onto the roadway. One or more processors (e.g., within SDV **202** and/or SDV/drone controller system **201**) will then remotely control the remotely-maneuverable rolling platform with the road safety flare mounted thereon to the opportune position.

In an embodiment of the present invention, assume that the road safety flare is equipped with a communication system that electronically communicates with the SDV. For example, as shown in FIG. 7, a road safety flare **726** (analogous to one of the road safety flares **226** shown in FIG. 2) is attached to a road safety flare control logic **701**. Road safety flare control logic **701** is able to control electronics within road safety flare **726** (if road safety flare **726** is an electronic road safety flare), pull the fuse tape off of the road safety flare **726** (if the road safety flare **726** is a pyrotechnic safety flare) using an electromechanical fuse puller, etc. Thus, in this embodiment, the SDV receives a message from the communication system (part of the road safety flare control logic **701**) on the road safety flare describing a real-time state of the road safety flare. The SDV, based on the real-time state of the road safety flare, adjusts a functionality of the road safety flare by a remote transmission from the SDV to the communication system on the road safety flare.

That is, assume that the road safety flare **726** is an electronic flare that is in bidirectional communication with the SDV. The SDV may then control the operation of the electronic flare by changing the strobing, coloration, etc. of the electronic flare. This change in operation of the electronic flare may also indicate **1**) the state of the faulty SDV and/or **2**) the state of the electronic flare. That is, if the faulty SDV has been disabled for more than one hour, then the electronic flare may change from a fast flashing strobe to a slower flashing strobe. Similarly, if the electronic flare is

running low on battery power, has been struck by a vehicle, etc., then the color, strobe rate, brightness, etc. of the LEDs in the electronic flare may change accordingly.

In one or more embodiments of the present invention in which multiple road safety flares **226** are deployed, the SDV **202** and/or aerial drone **200** may place them in different patterns based on the severity level. That is, if the severity level (discussed above) is moderate, then the road safety flares **226** may be deployed in a straight line every ten feet. However, if the severity level is high, then the road safety flares **226** may be deployed in a zigzag pattern every two feet.

As described herein, the environmental conditions upon which the opportune position for deploying the road safety flare(s) is based may be current traffic conditions at the location of the faulty SDV, current weather conditions at the location of the faulty SDV, current ambient lighting conditions at the location of the faulty SDV, etc.

Thus, as described herein and in various embodiments of the present invention, a self-driving vehicle (SDV) detects a driving problem severity level, and, then, based on a severity of the level, the system deploys one or more road safety flares.

Flare selection and/or deployment may proceed during a breakdown process being experienced by the faulty SDV. Deployment of the flare occurs when the likelihood of a failure over the time interval required to deploy the flare reaches a threshold. The flare deployment may further be precisely timed to provide a determined spacing between the flare and the vehicle upon stopping. The spacing may be a function of 1) road conditions, 2) road curvature, 3) average speed of vehicles on road, 4) weather, 5) time of day, 6) traffic conditions, etc. Multiple flares may be deployed during the breakdown in order to form a particular alerting visual pattern for approaching vehicles (such as a curved pattern to move vehicles away from the stopped faulty SDV). Movements of the faulty SDV prior to breakdown can be coordinated for proper flare placement. Flares may be mobile and their position adjusted in order to optimize their position after deployment.

In one or more embodiments of the present invention, the deployed road safety flare(s) are both bright and provide 360-degree illumination. As one example, the system may make use of 360-degree LED flares. As one example, in one flare unit, eleven white LEDs may flash rapidly in the front, followed by eleven red LEDs flashing rapidly in the back for 360-degree flashing. Some of the road safety flares may have magnets to allow for sticking to the SDV itself for use as a mounted flare or flashlight. When on the ground, various shapes may help keep the flare from rolling away.

In one or more embodiments of the present invention other vehicles (including other SDVs or emergency vehicles) may be equipped with real-time road flare detectors. For example, a flare detector may be configured to identify the colors of pixels, device shape, flashing/blinking pattern, etc. on a road safety flare deployed by a faulty SDV. Similarly, the road safety flares may emit an electronic (wireless) signal, in order to alert other vehicles in advance of reaching the faulty SDV.

In an embodiment of the present invention, the SDV (e.g., SDV **202**) that has detected a driving problem (e.g., faulty SDV **202**) communicates directly with "first responders" according to the problem detected and the severity of the problem (ambulance for medical emergency, police for accident, fire department for car fire, roadside assistance for flat tire, gas station when out of gas, etc.)

The present invention may be implemented in one or more embodiments using cloud computing. Nonetheless, it is understood in advance that although this disclosure includes a detailed description on cloud computing, implementation of the teachings recited herein are not limited to a cloud computing environment. Rather, embodiments of the present invention are capable of being implemented in conjunction with any other type of computing environment now known or later developed.

Cloud computing is a model of service delivery for enabling convenient, on-demand network access to a shared pool of configurable computing resources (e.g. networks, network bandwidth, servers, processing, memory, storage, applications, virtual machines, and services) that can be rapidly provisioned and released with minimal management effort or interaction with a provider of the service. This cloud model may include at least five characteristics, at least three service models, and at least four deployment models.

Characteristics are as follows:

**On-demand self-service:** a cloud consumer can unilaterally provision computing capabilities, such as server time and network storage, as needed automatically without requiring human interaction with the service's provider.

**Broad network access:** capabilities are available over a network and accessed through standard mechanisms that promote use by heterogeneous thin or thick client platforms (e.g., mobile phones, laptops, and PDAs).

**Resource pooling:** the provider's computing resources are pooled to serve multiple consumers using a multi-tenant model, with different physical and virtual resources dynamically assigned and reassigned according to demand. There is a sense of location independence in that the consumer generally has no control or knowledge over the exact location of the provided resources but may be able to specify location at a higher level of abstraction (e.g., country, state, or datacenter).

**Rapid elasticity:** capabilities can be rapidly and elastically provisioned, in some cases automatically, to quickly scale out and rapidly released to quickly scale in. To the consumer, the capabilities available for provisioning often appear to be unlimited and can be purchased in any quantity at any time.

**Measured service:** cloud systems automatically control and optimize resource use by leveraging a metering capability at some level of abstraction appropriate to the type of service (e.g., storage, processing, bandwidth, and active user accounts). Resource usage can be monitored, controlled, and reported providing transparency for both the provider and consumer of the utilized service.

**Software as a Service (SaaS):** the capability provided to the consumer is to use the provider's applications running on a cloud infrastructure. The applications are accessible from various client devices through a thin client interface such as a web browser (e.g., web-based e-mail). The consumer does not manage or control the underlying cloud infrastructure including network, servers, operating systems, storage, or even individual application capabilities, with the possible exception of limited user-specific application configuration settings.

**Platform as a Service (PaaS):** the capability provided to the consumer is to deploy onto the cloud infrastructure consumer-created or acquired applications created using programming languages and tools supported by the provider. The consumer does not manage or control the underlying cloud infrastructure including networks, servers, operating systems, or storage, but has control over the deployed applications and possibly application hosting environment configurations.

**Infrastructure as a Service (IaaS):** the capability provided to the consumer is to provision processing, storage, networks, and other fundamental computing resources where the consumer is able to deploy and run arbitrary software, which can include operating systems and applications. The consumer does not manage or control the underlying cloud infrastructure but has control over operating systems, storage, deployed applications, and possibly limited control of select networking components (e.g., host firewalls).

Deployment Models are as follows:

**Private cloud:** the cloud infrastructure is operated solely for an organization. It may be managed by the organization or a third party and may exist on-premises or off-premises.

**Community cloud:** the cloud infrastructure is shared by several organizations and supports a specific community that has shared concerns (e.g., mission, security requirements, policy, and compliance considerations). It may be managed by the organizations or a third party and may exist on-premises or off-premises.

**Public cloud:** the cloud infrastructure is made available to the general public or a large industry group and is owned by an organization selling cloud services.

**Hybrid cloud:** the cloud infrastructure is a composition of two or more clouds (private, community, or public) that remain unique entities but are bound together by standardized or proprietary technology that enables data and application portability (e.g., cloud bursting for load-balancing between clouds).

A cloud computing environment is service oriented with a focus on statelessness, low coupling, modularity, and semantic interoperability. At the heart of cloud computing is an infrastructure comprising a network of interconnected nodes.

Referring now to FIG. 8, illustrative cloud computing environment 50 is depicted. As shown, cloud computing environment 50 comprises one or more cloud computing nodes 10 with which local computing devices used by cloud consumers, such as, for example, personal digital assistant (PDA) or cellular telephone 54A, desktop computer 54B, laptop computer 54C, and/or automobile computer system 54N may communicate. Nodes 10 may communicate with one another. They may be grouped (not shown) physically or virtually, in one or more networks, such as Private, Community, Public, or Hybrid clouds as described hereinabove, or a combination thereof. This allows cloud computing environment 50 to offer infrastructure, platforms and/or software as services for which a cloud consumer does not need to maintain resources on a local computing device. It is understood that the types of computing devices 54A-54N shown in FIG. 8 are intended to be illustrative only and that computing nodes 10 and cloud computing environment 50 can communicate with any type of computerized device over any type of network and/or network addressable connection (e.g., using a web browser).

Referring now to FIG. 9, a set of functional abstraction layers provided by cloud computing environment 50 (FIG. 8) is shown. It should be understood in advance that the components, layers, and functions shown in FIG. 9 are intended to be illustrative only and embodiments of the invention are not limited thereto. As depicted, the following layers and corresponding functions are provided:

Hardware and software layer 60 includes hardware and software components. Examples of hardware components include: mainframes 61; RISC (Reduced Instruction Set Computer) architecture based servers 62; servers 63; blade servers 64; storage devices 65; and networks and networking

components **66**. In some embodiments, software components include network application server software **67** and database software **68**.

Virtualization layer **70** provides an abstraction layer from which the following examples of virtual entities may be provided: virtual servers **71**; virtual storage **72**; virtual networks **73**, including virtual private networks; virtual applications and operating systems **74**; and virtual clients **75**.

In one example, management layer **80** may provide the functions described below. Resource provisioning **81** provides dynamic procurement of computing resources and other resources that are utilized to perform tasks within the cloud computing environment. Metering and Pricing **82** provide cost tracking as resources are utilized within the cloud computing environment, and billing or invoicing for consumption of these resources. In one example, these resources may comprise application software licenses. Security provides identity verification for cloud consumers and tasks, as well as protection for data and other resources. User portal **83** provides access to the cloud computing environment for consumers and system administrators. Service level management **84** provides cloud computing resource allocation and management such that required service levels are met. Service Level Agreement (SLA) planning and fulfillment **85** provide pre-arrangement for, and procurement of, cloud computing resources for which a future requirement is anticipated in accordance with an SLA.

Workloads layer **90** provides examples of functionality for which the cloud computing environment may be utilized. Examples of workloads and functions which may be provided from this layer include: mapping and navigation **91**; software development and lifecycle management **92**; virtual classroom education delivery **93**; data analytics processing **94**; transaction processing **95**; and road safety flare deployment processing **96** for performing one or more functions in accordance with the present invention.

The terminology used herein is for the purpose of describing particular embodiments only and is not intended to be limiting of the present invention. As used herein, the singular forms “a”, “an” and “the” are intended to include the plural forms as well, unless the context clearly indicates otherwise. It will be further understood that the terms “comprises” and/or “comprising,” when used in this specification, specify the presence of stated features, integers, steps, operations, elements, and/or components, but do not preclude the presence or addition of one or more other features, integers, steps, operations, elements, components, and/or groups thereof.

The corresponding structures, materials, acts, and equivalents of all means or step plus function elements in the claims below are intended to include any structure, material, or act for performing the function in combination with other claimed elements as specifically claimed. The description of various embodiments of the present invention has been presented for purposes of illustration and description, but is not intended to be exhaustive or limited to the present invention in the form disclosed. Many modifications and variations will be apparent to those of ordinary skill in the art without departing from the scope and spirit of the present invention. The embodiment was chosen and described in order to best explain the principles of the present invention and the practical application, and to enable others of ordinary skill in the art to understand the present invention for various embodiments with various modifications as are suited to the particular use contemplated.

Any methods described in the present disclosure may be implemented through the use of a VHDL (VHSIC Hardware Description Language) program and a VHDL chip. VHDL is an exemplary design-entry language for Field Programmable Gate Arrays (FPGAs), Application Specific Integrated Circuits (ASICs), and other similar electronic devices. Thus, any software-implemented method described herein may be emulated by a hardware-based VHDL program, which is then applied to a VHDL chip, such as a FPGA.

Having thus described embodiments of the present invention of the present application in detail and by reference to illustrative embodiments thereof, it will be apparent that modifications and variations are possible without departing from the scope of the present invention defined in the appended claims.

What is claimed is:

1. A computer-implemented method comprising:
  - detecting, by one or more processors, a driving problem severity level for a faulty self-driving vehicle (SDV), wherein the driving problem severity level describes an amount of danger that is posed to other vehicles by the faulty SDV;
  - assessing, by one or more processors, environmental conditions at the location of the faulty SDV;
  - determining, by one or more processors, an opportune position for deploying one or more road safety flares by the faulty SDV based on the environmental conditions at the location of the faulty SDV and the driving problem severity level; and
  - transmitting, from the faulty SDV to a drone controller system, directions to deploy the one or more road safety flares at the opportune position, wherein the directions cause the drone controller system to issue instructions to an aerial drone that cause the aerial drone to deploy the one or more road safety flares at the opportune position based on the amount of danger that is posed to the other vehicles by the faulty SDV.
2. The computer-implemented method of claim 1, further comprising:
  - detecting, by one or more processors, a presence of airborne hazards above the opportune position, wherein the airborne hazards are moving objects that are capable of striking the aerial drone;
  - determining, by one or more processors, a safe altitude from which to deploy the one or more road safety flares from the aerial drone, wherein the safe altitude is determined based on the presence of the airborne hazards above at the opportune position; and
  - positioning, by one or more processors, the aerial drone at the safe altitude above the opportune position before deploying the road safety flares.
3. The computer-implemented method of claim 1, further comprising:
  - detecting, by one or more processors, a presence of hazardous gasses above the opportune position;
  - determining, by one or more processors, a safe altitude below the hazardous gasses from which to deploy the one or more road safety flares from the aerial drone; and
  - positioning, by one or more processors, the aerial drone at the safe altitude below the hazardous gasses before deploying the road safety flares.
4. The computer-implemented method of claim 1, wherein the driving problem severity level is based on a safety concern expressed by an occupant of the faulty SDV.
5. The computer-implemented method of claim 1, wherein the one or more road safety flares are from a group

consisting of an electronic safety flare, a pyrotechnic safety flare, and a radio signal transmitting safety flare.

6. The computer-implemented method of claim 1, wherein the one or more road safety flares are equipped with a communication system that electronically communicates with the faulty SDV, and wherein the computer-implemented method further comprises:

receiving, by the faulty SDV, a message from the communication system on the one or more road safety flares describing a real-time state of the one or more road safety flares; and

activating, by the faulty SDV and based on the real-time state of the one or more road safety flares, the one or more road safety flares by a remote transmission from the faulty SDV to the communication system on the one or more road safety flares.

7. The computer-implemented method of claim 1, wherein the environmental conditions are current traffic conditions at the location of the faulty SDV.

8. The computer-implemented method of claim 1, wherein the environmental conditions are current weather conditions at the location of the faulty SDV.

9. The computer-implemented method of claim 1, wherein the environmental conditions are curvatures of the roadway at the location of the faulty SDV.

10. A computer program product for deploying one or more road safety flares at an opportune position near a faulty self-driving vehicle (SDV), the computer program product comprising a computer readable storage medium having program instructions embodied therewith, wherein the computer readable storage medium is not a transitory signal per se, the program instructions readable and executable by a processor to cause the processor to perform a method comprising:

detecting a driving problem severity level for a faulty self-driving vehicle (SDV), wherein the driving problem severity level describes an amount of danger that is posed to other vehicles by the faulty SDV;

assessing environmental conditions at the location of the faulty SDV;

determining an opportune position for deploying the one or more road safety flares based on the environmental conditions at the location of the faulty SDV and the driving problem severity level; and

transmitting, from the faulty SDV to a drone controller system, directions to deploy the one or more road safety flares at the opportune position, wherein the directions cause the drone controller system to issue instructions to an aerial drone that cause the aerial drone to deploy the one or more road safety flares at the opportune position based on the amount of danger that is posed to the other vehicles by the faulty SDV.

11. The computer program product of claim 10, wherein the method further comprises:

detecting a presence of moving hazards above the opportune position, wherein the moving hazards are moving objects that are capable of striking the aerial drone;

determining a safe altitude from which to deploy the one or more road safety flares from the aerial drone, wherein the safe altitude is determined based on the presence of moving hazards above at the opportune position; and

positioning the aerial drone at the safe altitude above the opportune position.

12. The computer program product of claim 10, wherein the one or more road safety flares are from a group consisting of an electronic safety flare, a pyrotechnic safety flare, and a radio signal transmitting safety flare.

13. The computer program product of claim 10, wherein the one or more road safety flares are equipped with a communication system that electronically communicates with the faulty SDV, and wherein the method further comprises:

receiving, by the faulty SDV, a message from the communication system on the one or more road safety flares describing a real-time state of the one or more road safety flares; and

adjusting, by the faulty SDV and based on the real-time state of the one or more road safety flares, a functionality of the one or more road safety flares by a remote transmission from the faulty SDV to the communication system on the one or more road safety flares.

14. The computer program product of claim 10, wherein the program instructions are provided as a service in a cloud environment.

15. A computer system comprising:

one or more processors, one or more computer readable memories communicably coupled to the one or more processors, and

program instructions stored on at least one of the one or more computer readable memories for execution by at least one of the one or more processors via at least one of the one or more computer readable memories, the stored program instructions comprising:

program instructions to detect a driving problem severity level for a faulty self-driving vehicle (SDV), wherein the driving problem severity level describes an amount of danger that is posed to other vehicles by the faulty SDV;

program instructions to assess environmental conditions at the location of the faulty SDV;

program instructions to determine an opportune position for deploying one or more road safety flares based on the environmental conditions at the location of the faulty SDV and the driving problem severity level; and

program instructions to transmit, from the faulty SDV to a drone controller system, directions to deploy, the one or more road safety flares at the opportune position, wherein the directions cause the drone controller system to issue instructions to an aerial drone that cause the aerial drone to deploy the one or more road safety flares at the opportune position based on the amount of danger that is posed to the other vehicles by the faulty SDV.

\* \* \* \* \*