

(12) **United States Patent**
Parazynski et al.

(10) **Patent No.:** **US 10,664,002 B2**
(45) **Date of Patent:** **May 26, 2020**

(54) **MULTI-DEGREES-OF-FREEDOM HAND HELD CONTROLLER**

(71) Applicant: **Fluidity Technologies Inc.**, Houston, TX (US)

(72) Inventors: **Scott Edward Parazynski**, Houston, TX (US); **Nicholas Michael Degnan**, Redondo Beach, CA (US)

(73) Assignee: **Fluidity Technologies Inc.**, Houston, TX (US)

(*) Notice: Subject to any disclaimer, the term of this patent is extended or adjusted under 35 U.S.C. 154(b) by 0 days.

(21) Appl. No.: **15/796,744**

(22) Filed: **Oct. 27, 2017**

(65) **Prior Publication Data**

US 2019/0025869 A1 Jan. 24, 2019

Related U.S. Application Data

(60) Provisional application No. 62/413,685, filed on Oct. 27, 2016.

(51) **Int. Cl.**
G05G 1/00 (2006.01)
G05G 1/04 (2006.01)

(Continued)

(52) **U.S. Cl.**
CPC **G05G 1/01** (2013.01); **B64C 13/04** (2013.01); **G05G 1/02** (2013.01); **G05G 1/04** (2013.01); **G05G 9/04788** (2013.01); **G05G 2009/04718** (2013.01); **G05G 2009/04774** (2013.01); **G05G 2009/04781** (2013.01); **G06F 2203/015** (2013.01)

(58) **Field of Classification Search**
CPC .. G05G 1/01; G05G 1/02; G05G 1/04; G05G

1/06; G05G 9/047; G05G 2009/04774; G05G 9/04788; G05G 2009/04718; G05G 2009/04781; G06F 3/0346; G06F 3/016; G06F 3/038; G06F 2203/015; B64C 13/04

USPC 74/471 XY
See application file for complete search history.

(56) **References Cited**

U.S. PATENT DOCUMENTS

3,028,126 A 4/1962 Holleman
3,260,826 A 7/1966 Johnson
(Continued)

FOREIGN PATENT DOCUMENTS

GB 2091423 A 7/1982
JP H11154031 A 6/1999

OTHER PUBLICATIONS

“[Review] JJRC H37 Baby Elfie: Is It a Worthy Successor?” DronesGlobe, <http://www.dronesglobe.com/review/baby-elfie/>, dated Oct. 7, 2017.

(Continued)

Primary Examiner — Adam D Rogers

(57) **ABSTRACT**

A controller including a first control member and a second control member that extends from a portion of the first control member. A controller processor is operable to produce a rotational movement output signal in response to movement of the first control member, and a translational movement output signal in response to movement of the second control member relative to the first control member. The first control member may be gripped and moved using a single hand, and the second control member may be moved using the thumb of the single hand.

16 Claims, 15 Drawing Sheets

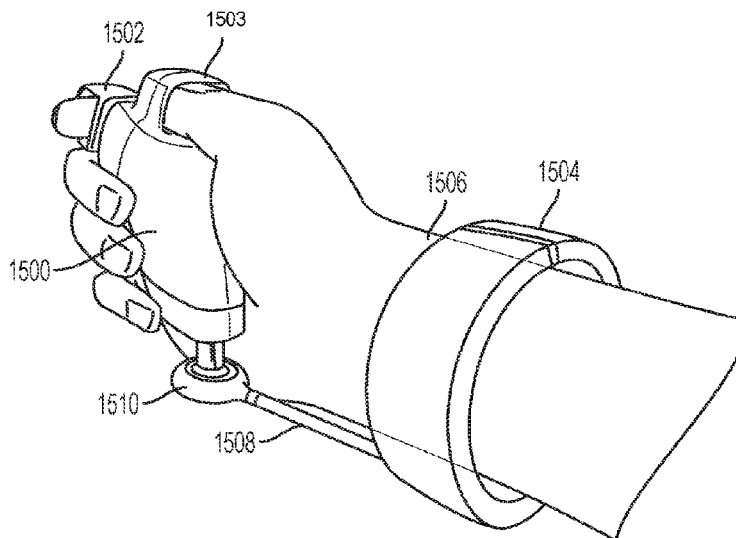

(51)	Int. Cl.			8,887,597 B2 *	11/2014	Black	E02F 9/2004
	B64C 13/02	(2006.01)					74/471 XY
	G05G 1/01	(2008.04)		9,501,084 B1 *	11/2016	Bannister	G05G 9/047
	G05G 9/047	(2006.01)		9,547,380 B2 *	1/2017	Parazynski	G08C 19/16
	B64C 13/04	(2006.01)		9,727,076 B2 *	8/2017	Smith	G05G 9/047
	G05G 1/02	(2006.01)		10,152,853 B2 *	12/2018	Provancher	G06F 3/016
				10,198,086 B2	2/2019	Parazynski et al.	
				10,222,794 B2	3/2019	Deng et al.	
				10,324,487 B2 *	6/2019	Parazynski	G05G 5/03
(56)	References Cited			10,331,232 B2 *	6/2019	Parazynski	G06F 3/0346
				10,331,233 B2 *	6/2019	Parazynski	G06F 3/0346
	U.S. PATENT DOCUMENTS			2002/0128064 A1	9/2002	Sobota	
				2003/0006956 A1	1/2003	Wu et al.	
				2003/0058219 A1	3/2003	Shaw	
	4,012,014 A *	3/1977	Marshall	2003/0214484 A1	11/2003	Haywood	
			B64C 13/04	2004/0083940 A1	5/2004	Shelton et al.	
	4,216,467 A *	8/1980	Colston	2005/0104742 A1	5/2005	Phifer	
			B25J 13/02	2005/0159850 A1 *	7/2005	Melman	F16H 59/0217
			341/176				701/1
	4,420,808 A	12/1983	Diamond et al.	2005/0277470 A1	12/2005	Watanachote	
	4,584,510 A *	4/1986	Hollow	2006/0156848 A1	7/2006	Gosselin et al.	
			B64C 13/04	2006/0164383 A1	7/2006	Machin et al.	
			244/234	2006/0224280 A1	10/2006	Flanigan et al.	
	4,590,339 A	5/1986	Scott-Jackson et al.	2006/0262000 A1	11/2006	Strong	
	4,733,214 A	3/1988	Andresen	2007/0080934 A1	4/2007	Chen et al.	
	5,042,314 A	8/1991	Rytter et al.	2007/0156286 A1	7/2007	Yamauchi	
	5,128,671 A	7/1992	Thomas, Jr.	2008/0063400 A1	3/2008	Hudson et al.	
	5,223,776 A	6/1993	Radke et al.	2008/0132334 A1	6/2008	Nonaka et al.	
	5,317,301 A	5/1994	DeVolpi	2008/0174550 A1	7/2008	Laurila et al.	
	5,459,382 A	10/1995	Jacobus et al.	2008/0278448 A1 *	11/2008	Nilsagard	G05G 9/053
	5,503,040 A	4/1996	Wright				345/161
	5,559,432 A	9/1996	Logue	2009/0152782 A1	6/2009	Larson et al.	
	5,565,891 A	10/1996	Armstrong	2009/0179869 A1	7/2009	Slotznick	
	D375,765 S	11/1996	Kawasaki	2009/0213073 A1	8/2009	Obermeyer et al.	
	5,607,158 A	3/1997	Chan	2009/0248220 A1	10/2009	Ecton et al.	
	5,643,087 A	7/1997	Marcus et al.	2010/0097309 A1	4/2010	Nishida et al.	
	D389,198 S	1/1998	Hama	2010/0302017 A1	12/2010	Guglielmo	
	5,749,577 A	5/1998	Couch et al.	2011/0148667 A1	6/2011	Yeh	
	5,781,180 A	7/1998	Couch et al.	2011/0213384 A1	9/2011	Jeong	
	5,831,408 A	11/1998	Jacobus et al.	2011/0219899 A1	9/2011	Dize et al.	
	5,963,196 A	10/1999	Nishiumi et al.	2012/0187238 A1 *	7/2012	Lam	A63H 27/12
	H001822 H *	12/1999	Kelley				244/17.21
	6,068,554 A	5/2000	Tyler	2012/0249455 A1	10/2012	Nagata et al.	
	6,198,471 B1	3/2001	Cook	2013/0147611 A1	6/2013	Brendel	
	6,222,525 B1	4/2001	Armstrong	2013/0178293 A1	7/2013	Nakayama et al.	
	6,429,849 B1 *	8/2002	An	2013/0293362 A1 *	11/2013	Parazynski	G08C 19/16
			G05G 9/047				340/12.52
			345/161	2014/0083225 A1	3/2014	Downs et al.	
	6,580,418 B1	6/2003	Grome et al.	2014/0247119 A1	9/2014	Robbins et al.	
	6,597,347 B1	7/2003	Yasutake	2014/0249695 A1	9/2014	Gettings et al.	
	6,613,997 B2	9/2003	Oster et al.	2015/0253801 A1	9/2015	Wuisan et al.	
	6,624,806 B2	9/2003	Hsu	2016/0077589 A1	3/2016	Chataignier et al.	
	6,644,141 B2 *	11/2003	Oikarinen	2016/0195939 A1	7/2016	Parazynski	
			G05G 9/047	2016/0241767 A1	8/2016	Cho et al.	
			188/333	2017/0121000 A1	5/2017	Forslund et al.	
	6,865,342 B2 *	3/2005	Hirata	2017/0233983 A1	8/2017	Wright	
			G05G 9/047	2017/0246533 A1	8/2017	LaChappelle et al.	
			348/211.7	2017/0269587 A1	9/2017	Hong	
	7,131,389 B1	11/2006	Hawkes	2018/0356907 A1 *	12/2018	Parazynski	G06F 3/0346
	7,170,420 B2	1/2007	Phifer	2019/0033987 A1	1/2019	Parazynski	
	7,548,697 B2 *	6/2009	Hudson	2019/0041891 A1	2/2019	Parazynski	
			A63H 30/04	2019/0041894 A1	2/2019	Parazynski et al.	
			398/106	2019/0042003 A1	2/2019	Parazynski et al.	
	7,575,491 B1	8/2009	Martin	2019/0042004 A1	2/2019	Parazynski et al.	
	7,793,890 B2	9/2010	Scherer				
	7,823,685 B2	11/2010	Blind et al.				
	7,931,239 B2	4/2011	Pedersen et al.				
	8,089,225 B2	1/2012	Goossen				
	8,100,218 B2	1/2012	Case et al.				
	8,212,770 B2 *	7/2012	Obourn				
			G05G 9/047				
			345/156				
	8,258,917 B2	9/2012	Cai et al.				
	8,276,476 B2 *	10/2012	Diccion				
			E02F 9/2004				
			180/315				
	8,300,012 B2	10/2012	Yamamoto				
	8,344,914 B2 *	1/2013	Yeh				
			G05G 9/047				
			341/20				
	8,371,187 B2	2/2013	Payandeh et al.				
	8,380,402 B2	2/2013	Hobenshield				
	D678,281 S	3/2013	Yung				
	8,576,168 B2	11/2013	Kabasawa et al.				
	8,716,973 B1	5/2014	Lammertse				
	8,866,597 B2	10/2014	Brendel				
	8,881,616 B2 *	11/2014	Dize				
			G05G 9/047				
			345/161				

OTHER PUBLICATIONS

“CES 2018: TIE Develop World’s First One-Hand Drone Controller System,” Live at PC.com, <https://liveatpc.com/ces-2018-tie-develops-worlds-first-one-hand-drone-controller-system/>, dated Jan. 2018.

“Feel Your Drone With MotionPilot’s Haptic Joystick”, Engadget, <https://www.engadget.com/2018/01/19/motionpilot-haptic-drone-joystick/>, dated Jan. 19, 2018.

“H.E.A.R.T.—Hall Effect Accurate Technology: A Unique 3D Technological Innovation Built Into the New Thrustmaster Joystick,” Thrustmaster, <http://www.thrustmaster.com/press/heart-hall-effect-accurate-technology-unique-3d-technological-innovation-built-new-thrustmaste>, dated Jan. 7, 2009.

(56)

References Cited

OTHER PUBLICATIONS

"InnovRC Firmware v1.2", InnovRC, <http://www.innovrc.de/ivrcwiki/index.php?title=Hauptseite>, dated Mar. 2013.

"Learn How to Pilot in Less Than 2 Minutes". Wepulsit, <http://www.wepulsit.com/>, dated 2017.

International Search Report and Written Opinion received in Patent Cooperation Treaty Application No. PCT/US17/058905, dated Feb. 23, 2018, 5 pages.

International Search Report and Written Opinion received in Patent Cooperation Treaty Application No. PCT/US18/057862, dated Jan. 11, 2019, 16 pages.

International Search Report and Written Opinion received in Patent Cooperation Treaty Application No. PCT/US18/057864, dated Feb. 26, 2019, 15 pages.

International Search Report and Written Opinion received in Patent Cooperation Treaty Application No. PCT/US18/057865, dated Jan. 4, 2019, 11 pages.

International Search Report and Written Opinion received in Patent Cooperation Treaty Application No. PCT/US18/057874, dated Jan. 10, 2019, 11 pages.

Office Action received in U.S. Appl. No. 13/797,184, filed Mar. 12, 2013, dated Mar. 2, 2015, 19 pages.

Office Action received in U.S. Appl. No. 13/797,184, filed Oct. 16, 2015, dated Oct. 16, 2015, 19 pages.

Office Action received in U.S. Appl. No. 15/071,624, filed Mar. 16, 2016, dated May 17, 2016, 24 pages.

Office Action received in U.S. Appl. No. 15/394,490, filed Dec. 29, 2016, dated Nov. 21, 2018, 14 pages.

Office Action received in U.S. Appl. No. 16/163,563, filed Dec. 12, 2018, dated Dec. 12, 2018, 23 pages.

Office Action received in U.S. Appl. No. 16/163,565, filed Oct. 17, 2018, dated Dec. 19, 2018, 40 pages.

Office Action received in U.S. Appl. No. 16/163,561, filed Oct. 17, 2018, dated Dec. 11, 2018, 14 pages.

Pamplona, Vitror F., et al., "The Image-Based Data Glove", Proceedings of X Symposium on Virtual Reality (SVR'2008), João Pessoa, 2008. Anais do SVR 2008, Porto Alegre: SBC, 2008, (ISBN: 857669174-4). pp. 204-211.

Parazynski, Scott Edward, et al., U.S. Appl. No. 13/797,184, filed Mar. 12, 2013.

Parazynski, Scott Edward, et al., U.S. Appl. No. 15/071,624, filed Mar. 16, 2016.

Parazynski, Scott Edward, et al., U.S. Appl. No. 15/394,490, filed Dec. 29, 2016.

Paazynski, Scott Edward, et al., U.S. Appl. No. 16/114,190, filed Aug. 27, 2018.

Parazynski, Scott Edward, et al., U.S. Appl. No. 16/163,563, filed Oct. 17, 2018.

Parazynski, Scott Edward, et al., U.S. Appl. No. 16/163,565, filed Oct. 17, 2018.

Parazynski, Scott Edward, et al., U.S. Appl. No. 16/163,561, filed Oct. 17, 2018.

Parazynski, Scott Edward, U.S. Appl. No. 15/964,064, filed Apr. 26, 2018.

Wilbert, Jurgen, et al., "Semi-Robotic 6 Degree of Freedom Positioning for Intracranial High Precision Radiotherapy; First Phantom and Clinical Results," Radiation Oncology 2010, 5:42 (May 2010).
Zhai, X, "Human Performance in Six Degree of Freedom Input Control," (Ph.D. Thesis) Graduate Department of Industrial Engineering, University of Toronto (1995).

Office Action received in U.S. Appl. No. 15/964,064, filed Apr. 26, 2018, dated Mar. 18, 2019, 14 pages.

* cited by examiner

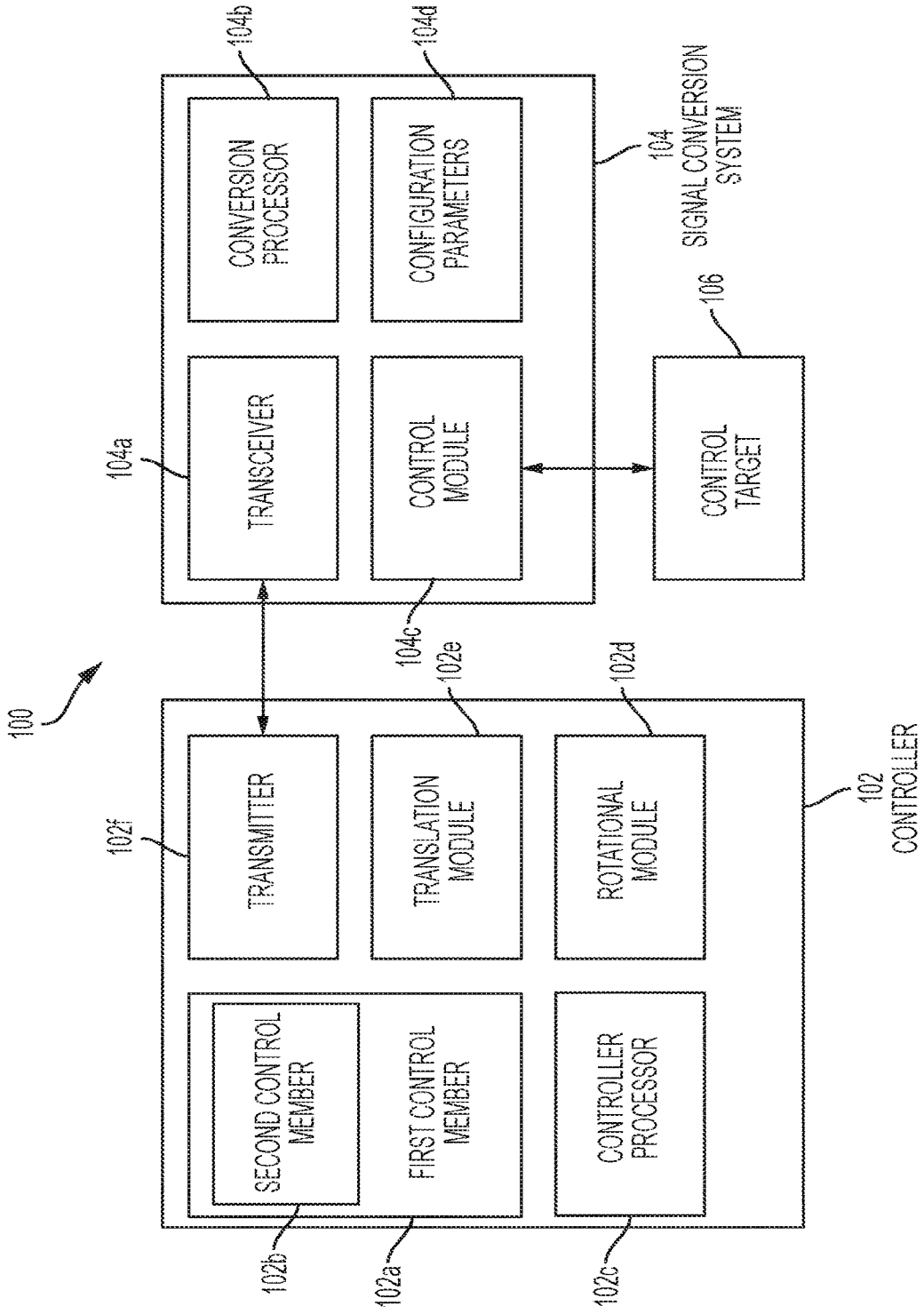

FIG. 1

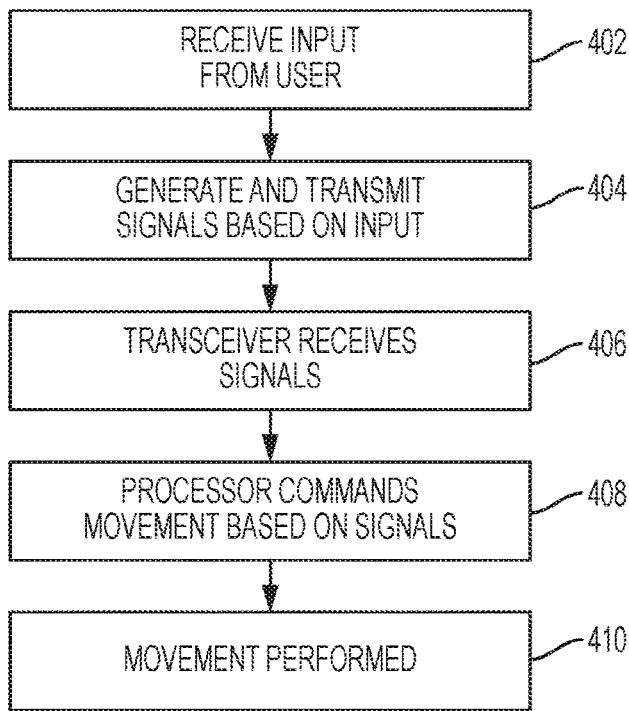

FIG. 2

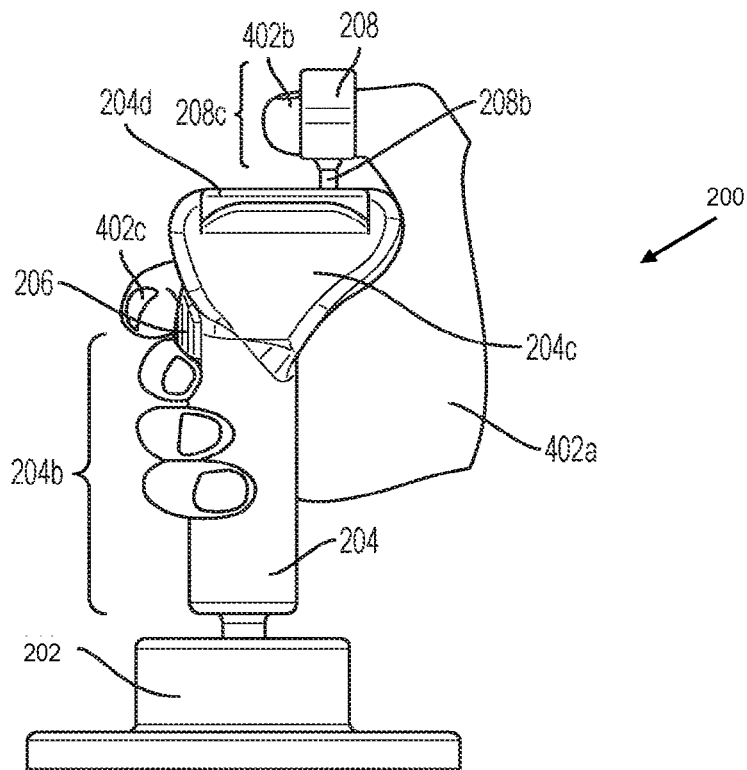

FIG. 3

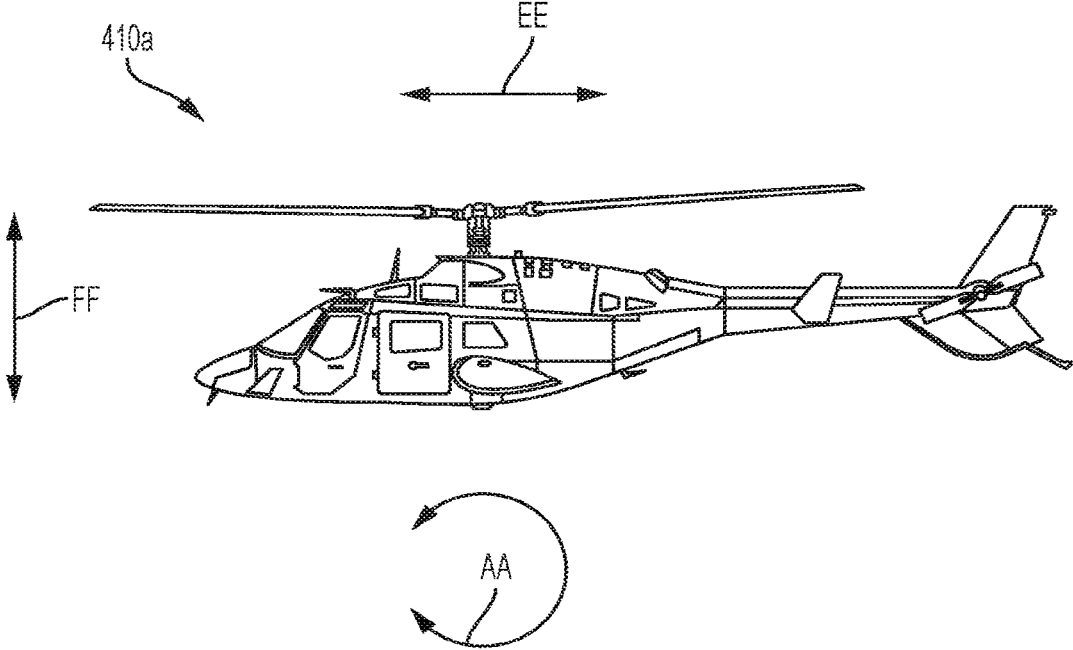

FIG. 4A

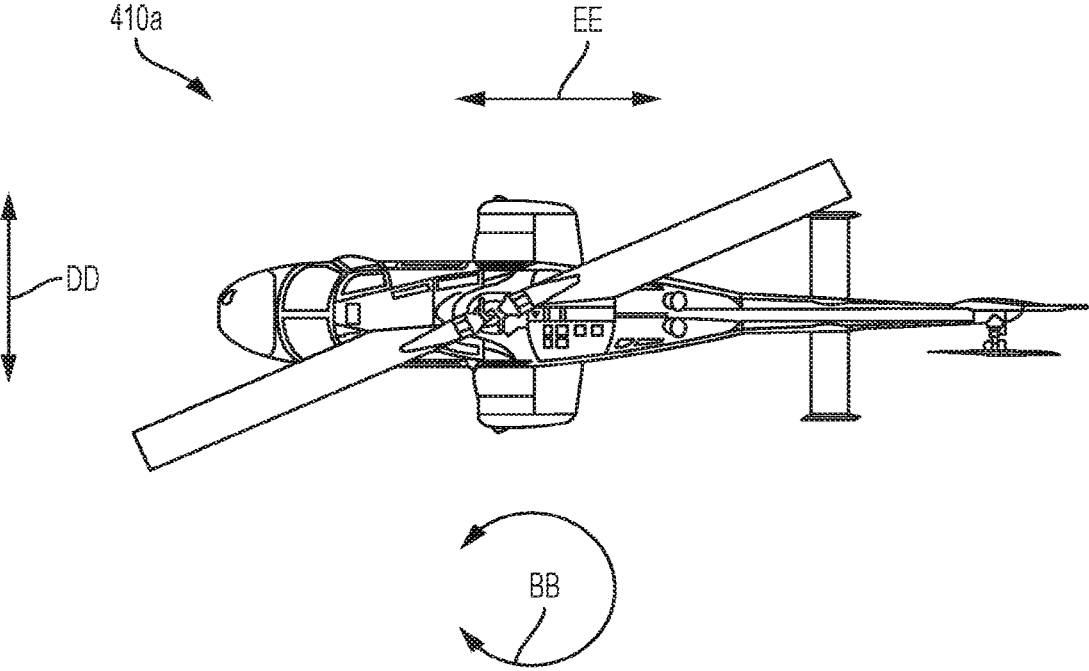

FIG. 4B

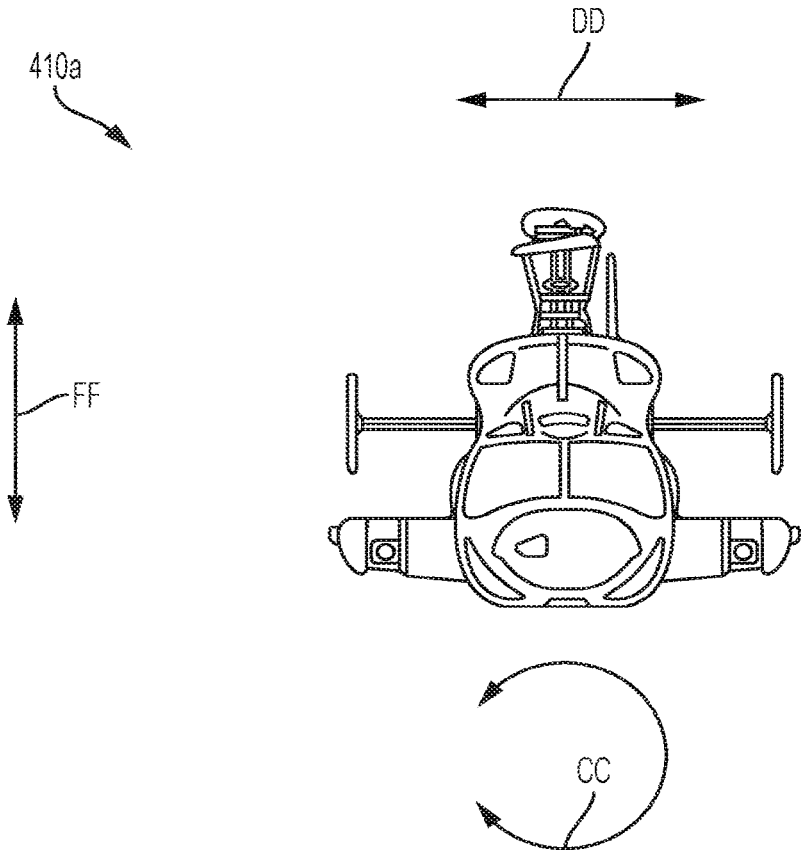

FIG. 4C

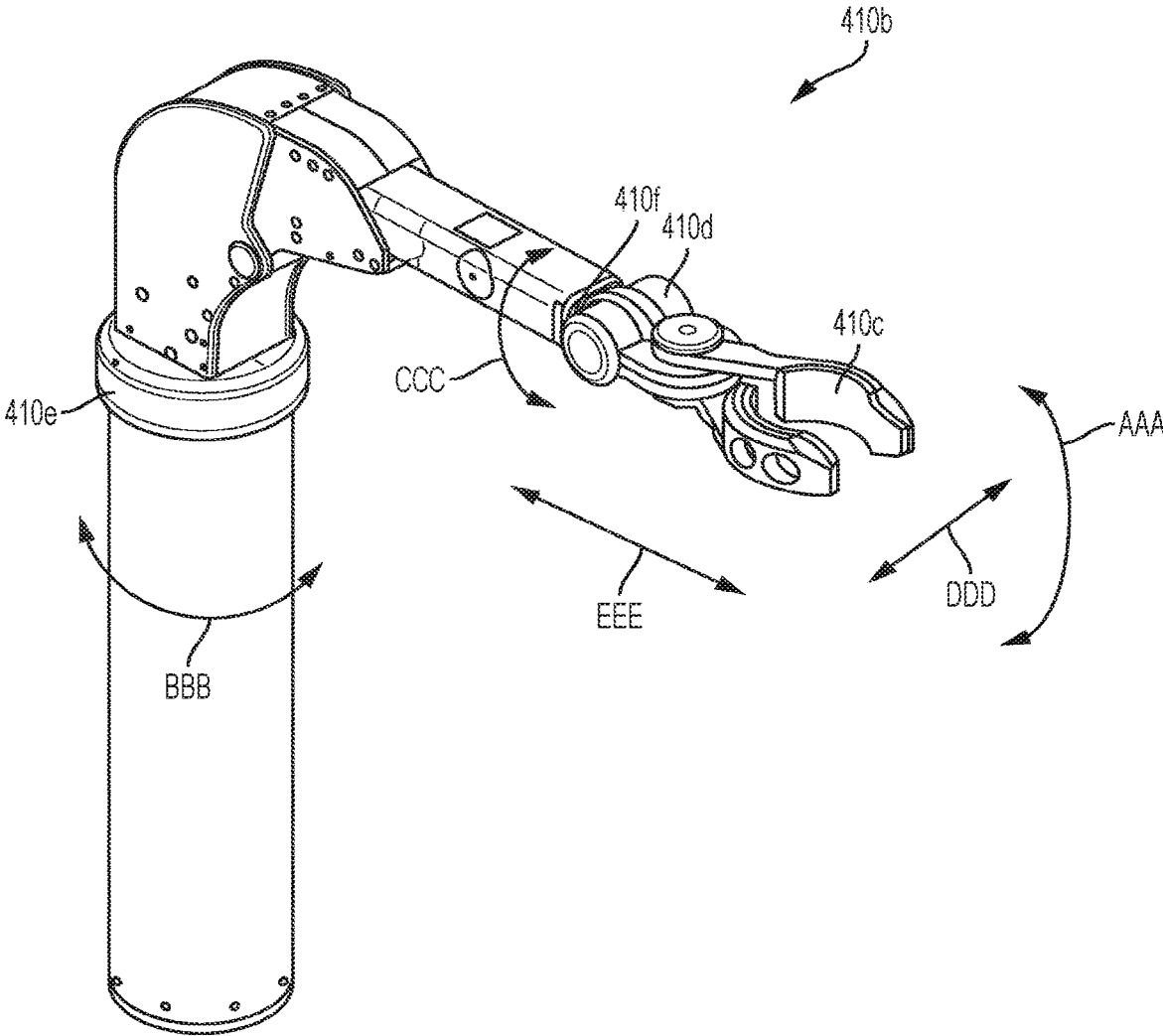

FIG. 4D

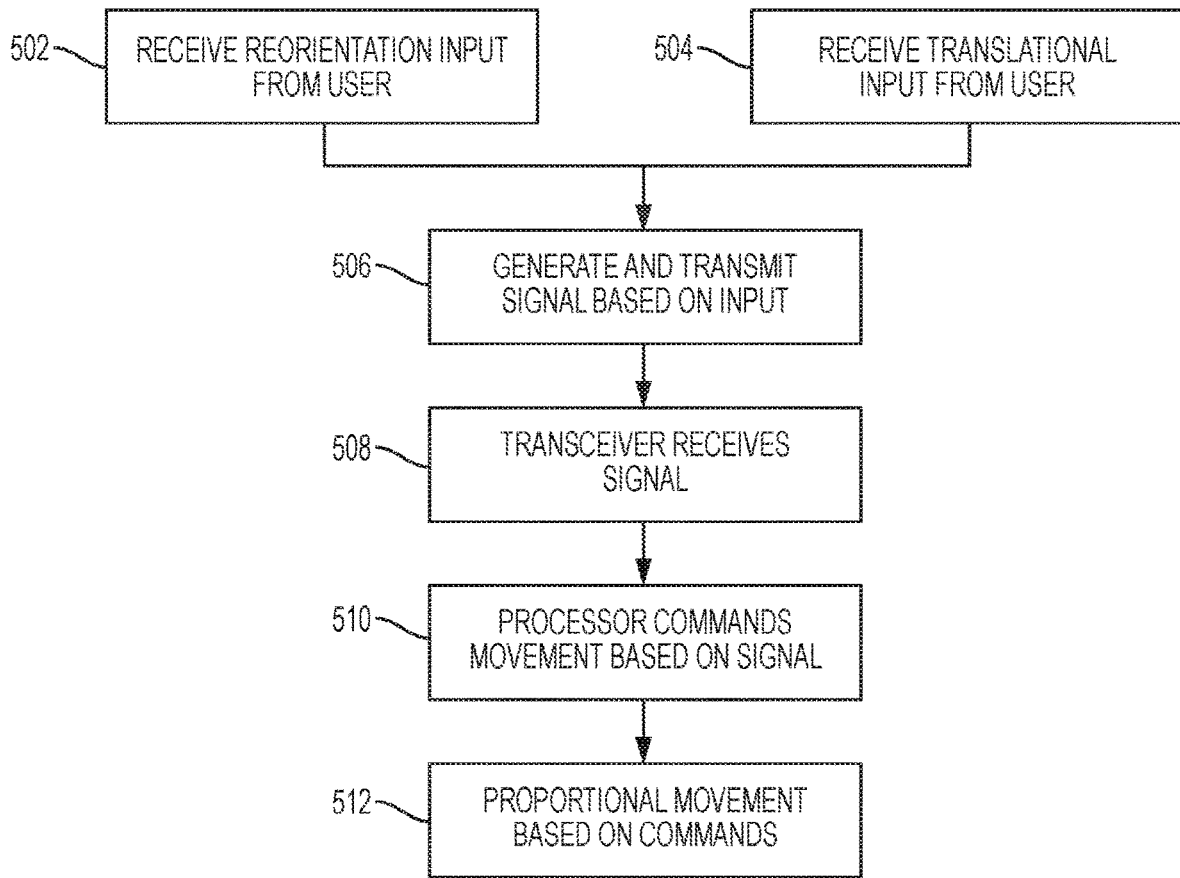

FIG. 5

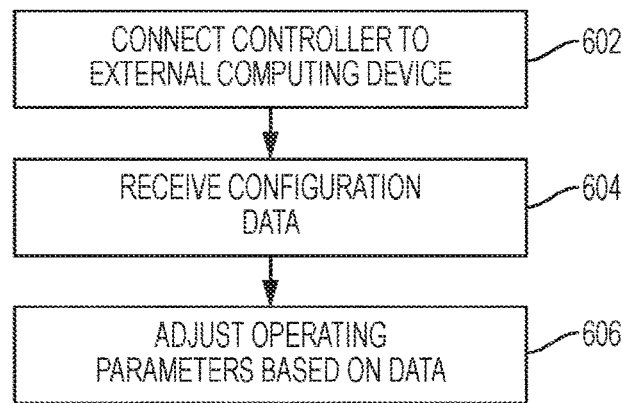

FIG. 6

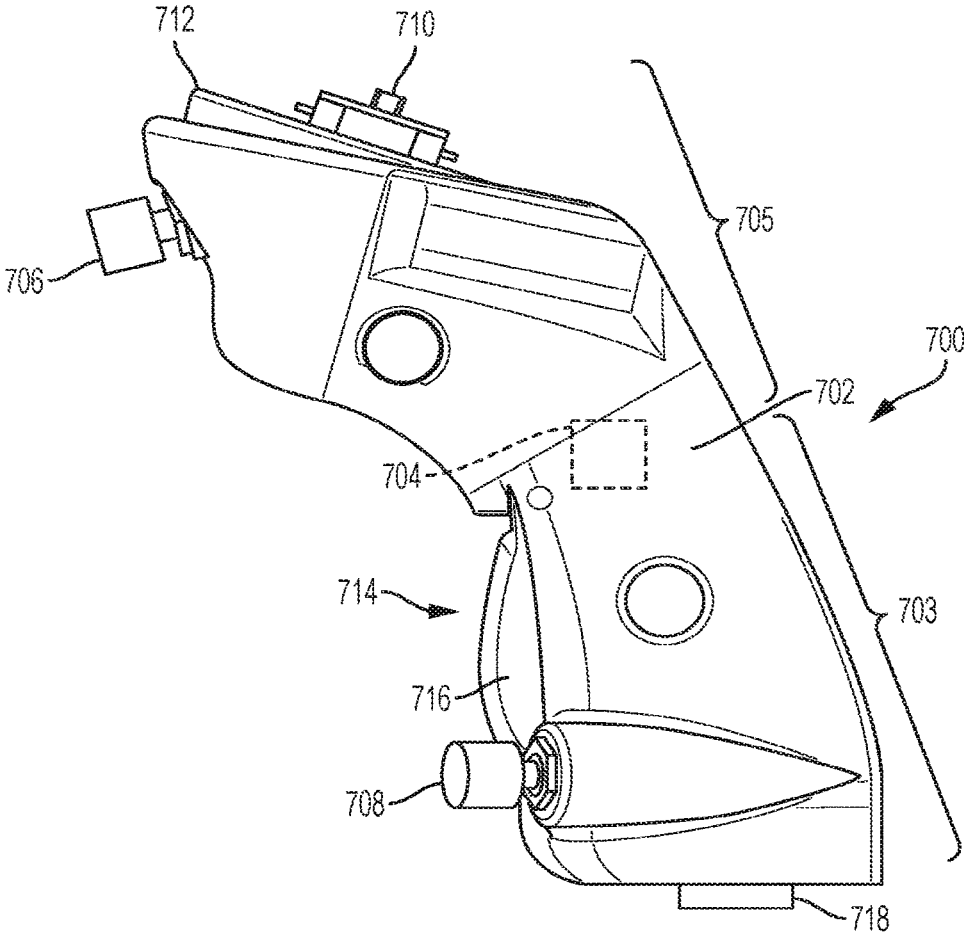

FIG. 7

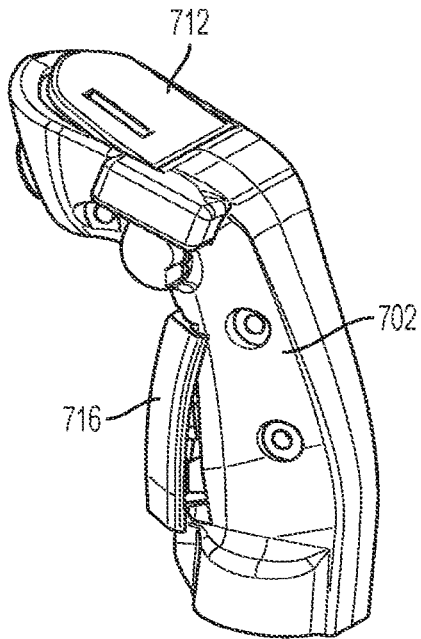

FIG. 8A

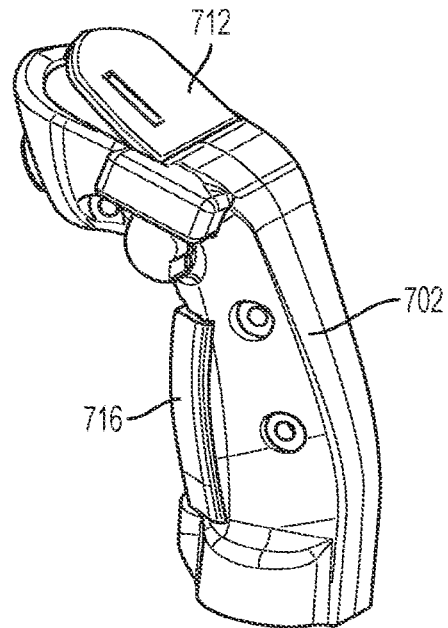

FIG. 8B

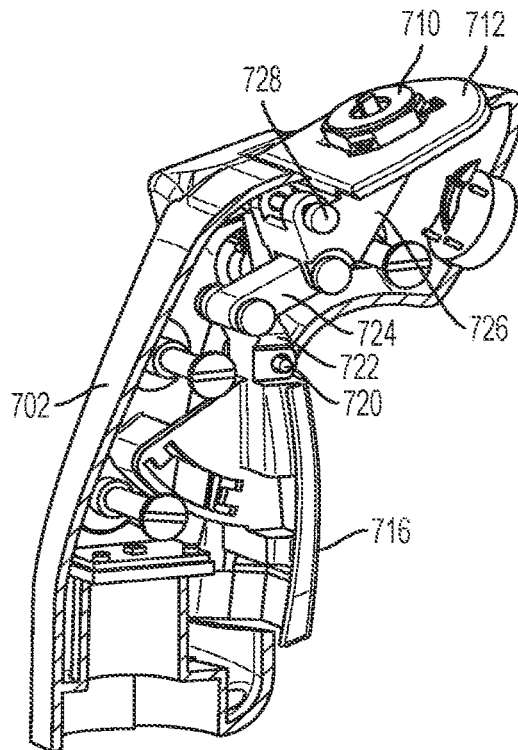

FIG. 8C

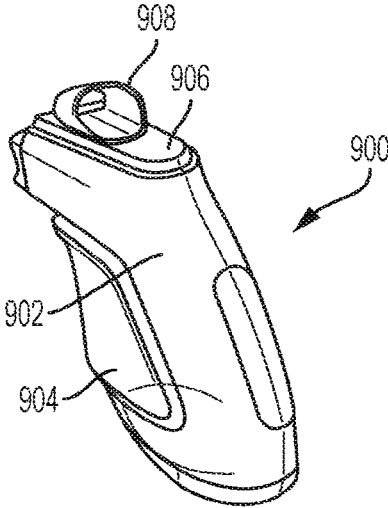

FIG. 9

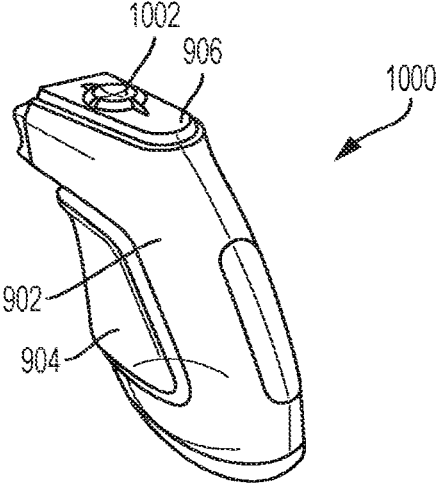

FIG. 10

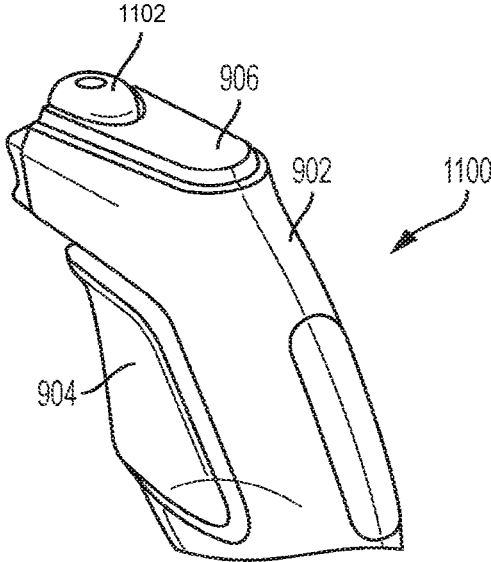

FIG. 11

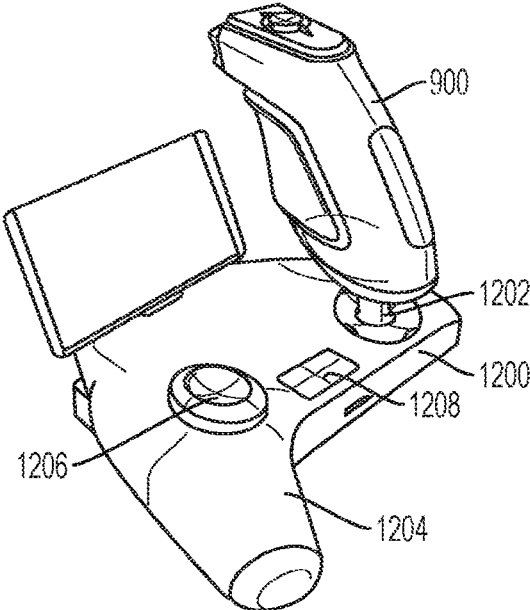

FIG. 12

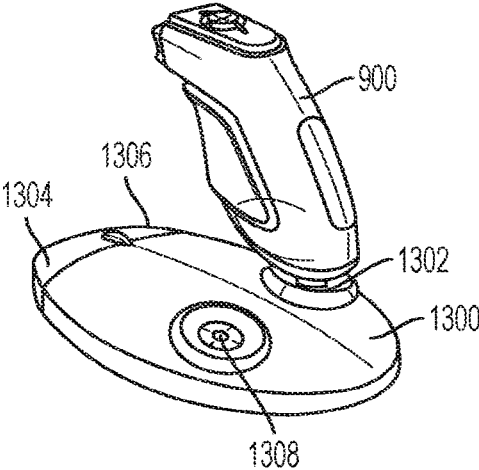

FIG. 13

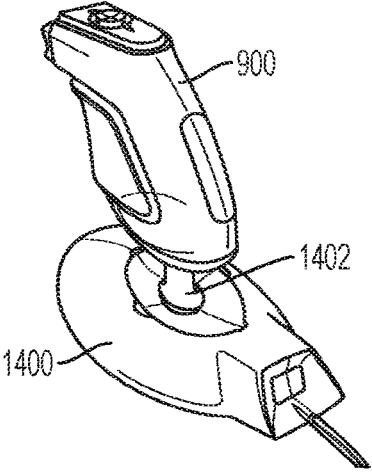

FIG. 14

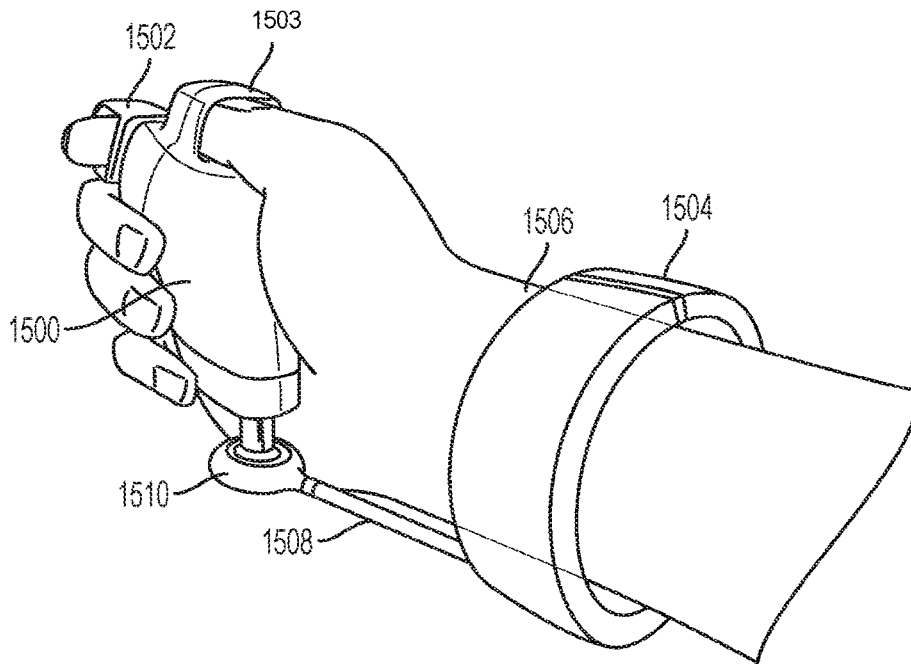

FIG. 15

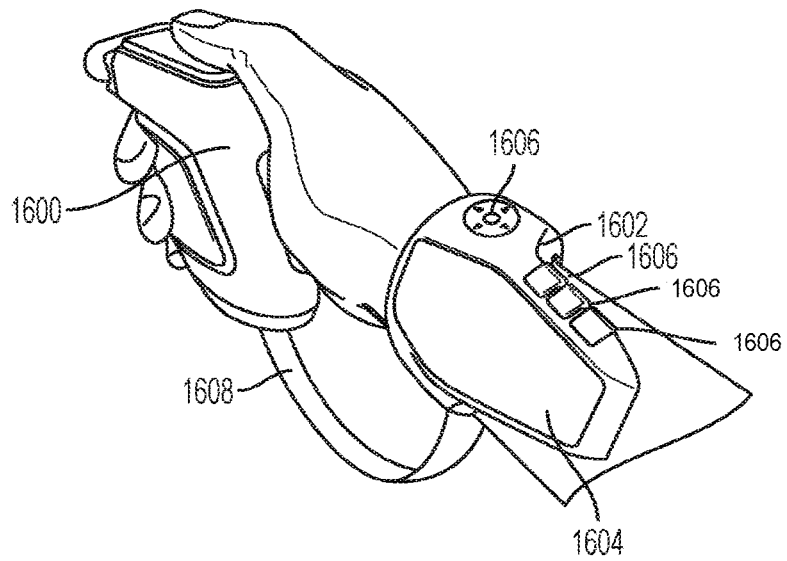

FIG. 16

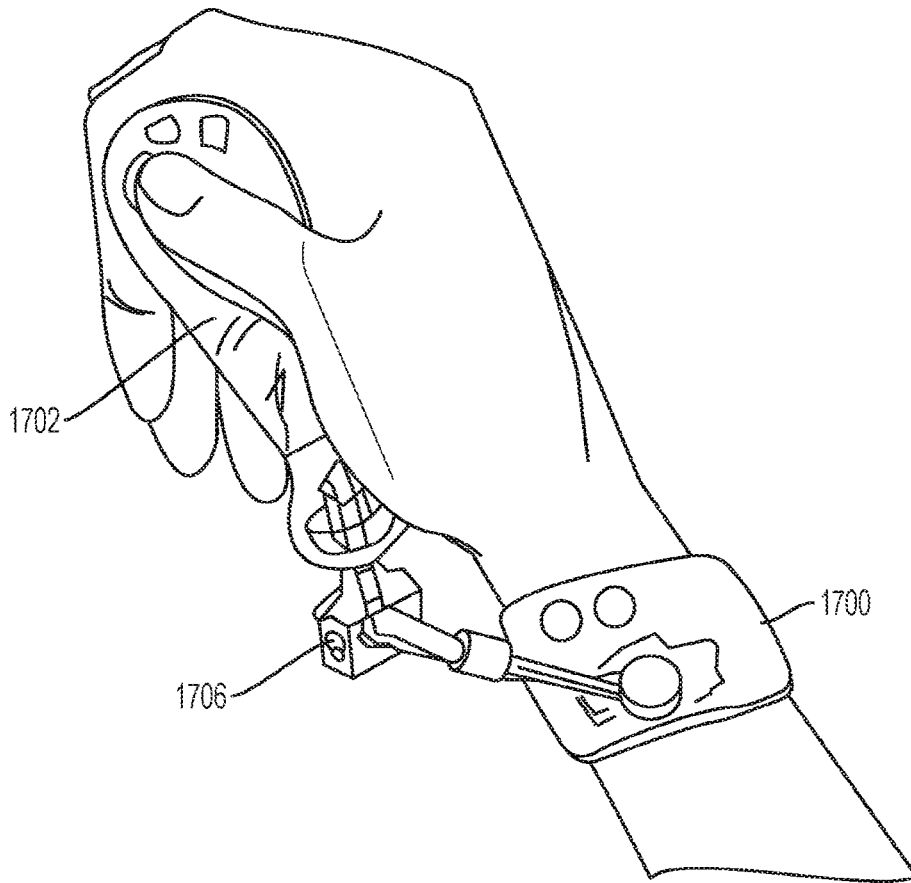

FIG. 17

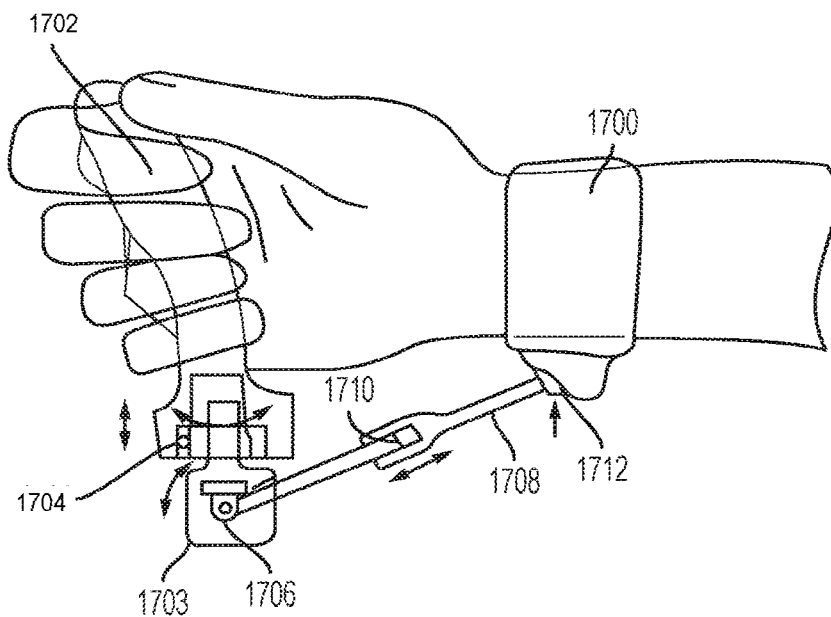

FIG. 18

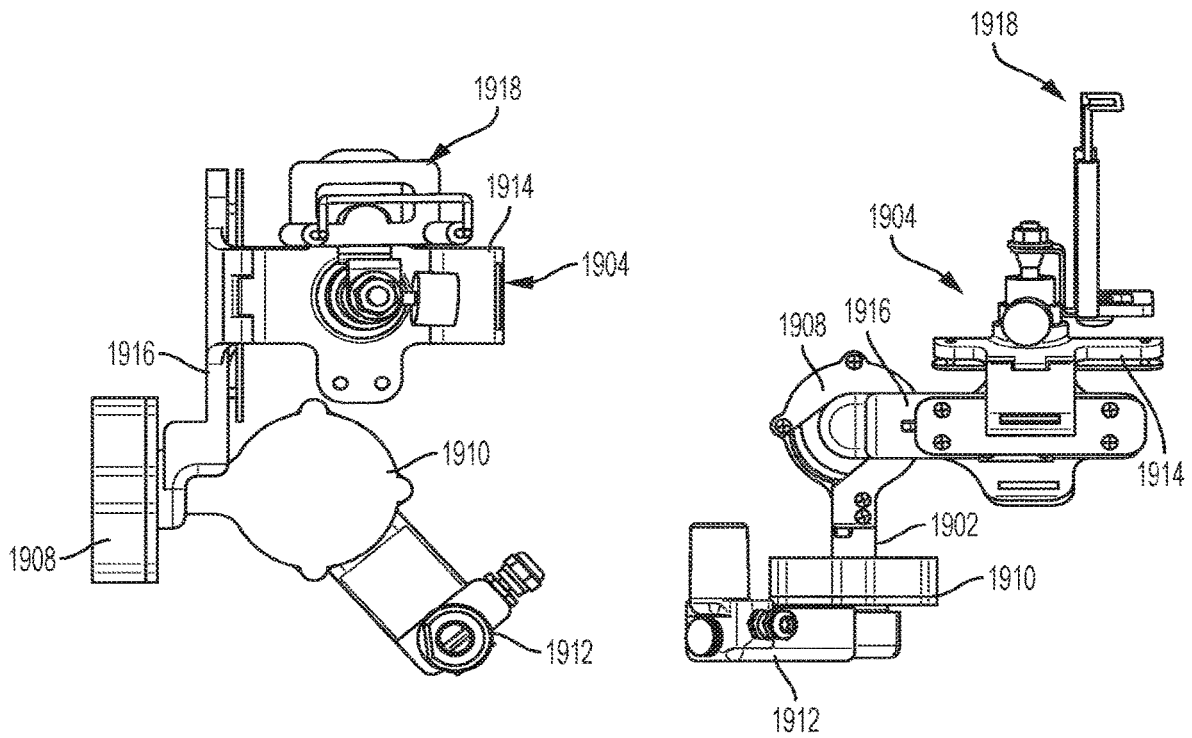

FIG. 19A

FIG. 19B

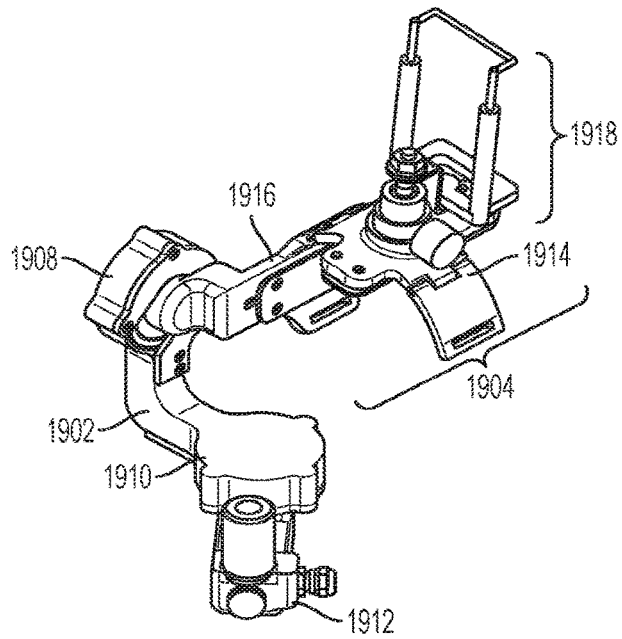

FIG. 19C

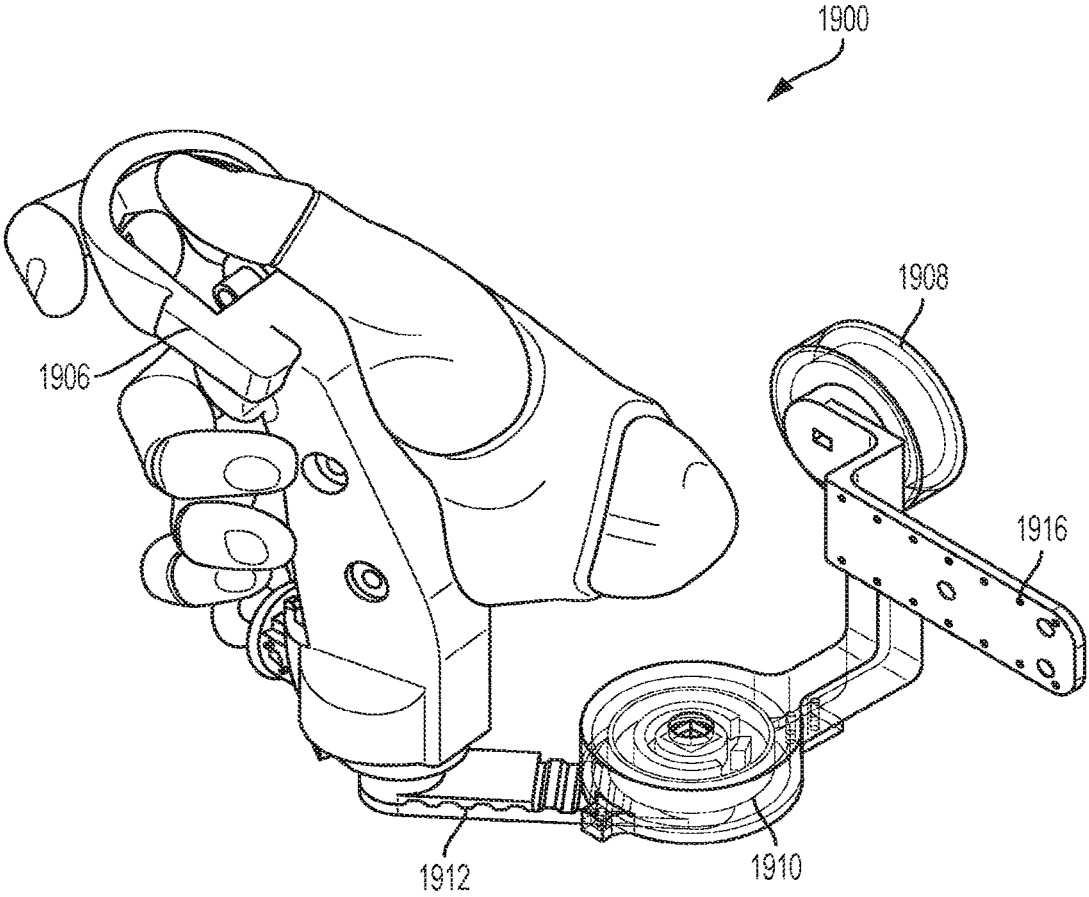

FIG. 19D

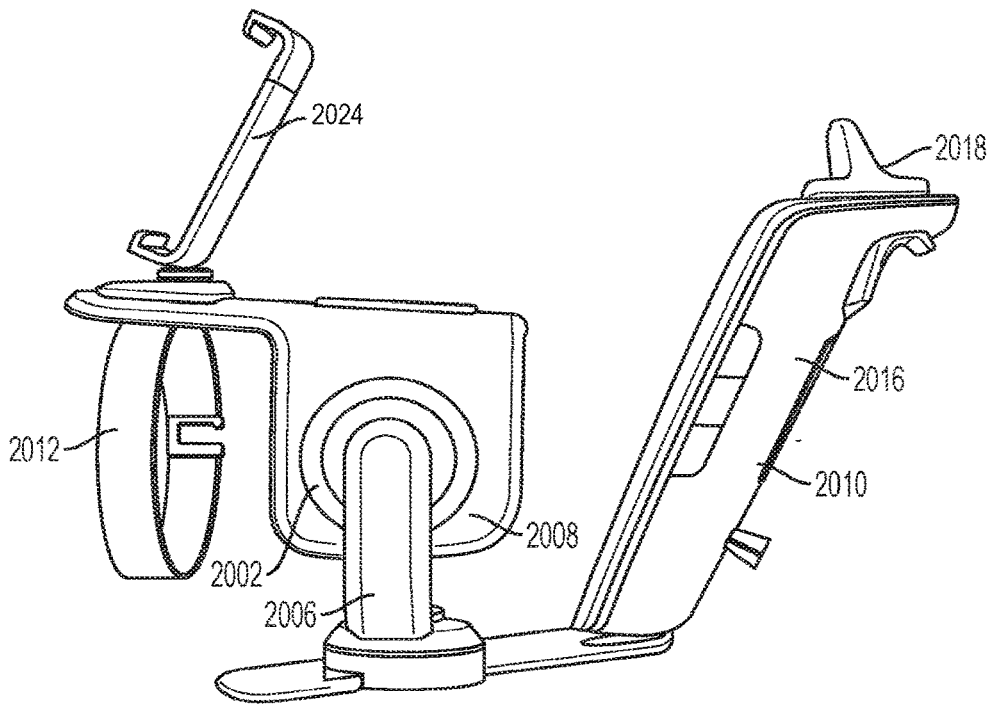

FIG. 20A

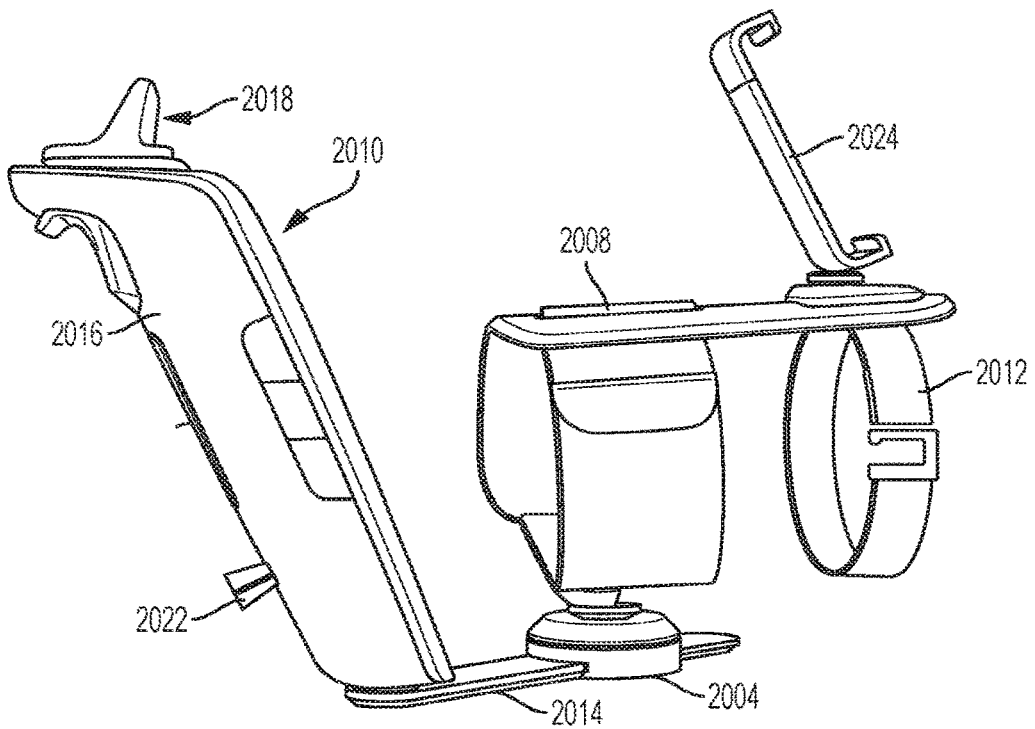

FIG. 20B

MULTI-DEGREES-OF-FREEDOM HAND HELD CONTROLLER

This application claims the benefit of U.S. provisional patent application No. 62/413,685 filed Oct. 27, 2016, the entirety of which is incorporated herein by reference for all purposes.

FIELD OF THE INVENTION

The present disclosure relates generally to control systems and more particularly to a controller that provides a user with the ability to send command signals for up to six independent degrees of freedom, substantially limiting cross-coupling, using a controller that is operable with a single hand.

BACKGROUND OF THE INVENTION

Conventionally, multiple discrete controllers are utilized to allow a user to control a control target having more than three degrees of freedom. Furthermore, multiple discrete controllers have been required for any conventional control system that controls a control target having six degrees of freedom. For example, a set of independent controllers or input devices (e.g., joysticks, control columns, cyclic sticks, foot pedals, and/or other independent controllers as may be known by one or more of ordinary skill in the art) may be provided to receive a variety of different rotational parameters (e.g., pitch, yaw, and roll) from a user for a control target (e.g., an aircraft, submersible vehicles, spacecraft, a control target in a virtual environment, and/or a variety of other control targets as may be known by one or more of ordinary skill in the art). Similarly, a set of independent controllers may be provided to control other navigational parameters such as translation (e.g., x-, y-, and z-axis movement) in a three-dimensional (3D) space, velocity, acceleration, and/or a variety of other command parameters.

U.S. patent application Ser. Nos. 13/797,184 and 15/071,624, respectively filed on Mar. 12, 2013, and Mar. 16, 2016, which are both incorporated herein by reference in their entireties, describe several embodiments of a control system that allows a user to control a control target in up to six degrees of freedom (6-DOF) simultaneously and independently, using a single controller. In one embodiment, a unified hand controller may include a first control member for receiving rotational inputs (e.g., pitch, yaw, and roll) and a second control member that extends from the first control member and that is for receiving translational inputs (e.g., movement along x, y, and z axes). The first control member and the second control member on the unified hand controller may be repositioned by a user using a single hand to control the control target in 6-DOF. Vital to precise and intuitive control is knowledge of when a command is being issued in a particular degree of freedom and when it is not. Each independent controller provides tactile feedback to the user, such that s/he knows when inputs are being made in up to six degrees of freedom motion, simultaneously and independently.

SUMMARY

Previously known drone, virtual reality, augmented reality, computer and gaming input devices are not intuitive, require substantial initial and proficiency training, and are operated with two hands. They are also typically not mobile.

Various aspects of the single-handed controllers described below can allow a computer augmented or virtual reality gamer or other users-in-motion (hikers, skiers, security/SAR personnel, war-fighters, and others, for example) to control assets in physical and/or virtual three-dimensional space, by enabling up to 6-DoF motion in all axes simultaneously while also limiting cross-coupling (unintended motions).

According to one aspect of the disclosure, a hand controller includes first, second, and third control members. The first control member is movable with three degrees of freedom and provides in response a first set of three independent control inputs. Movement of the first member may be sensed, and control inputs generated, by, for example, an inertial motion unit, potentiometers gimbals or a combination thereof. The first control member is configured to be gripped in a user's single hand, by the user placing it in the palm of the hand and wrapping at least several of their fingers at least partially around the body of the first member to hold it. The second control member is disposed on a top end of the first member, near where the thumb of a hand might rest when the first member is gripped, and is movable with three independent degrees of freedom independently of the movement of the first control member. In response to its independent degrees of freedom, the second control member provides a second set of three independent control inputs. The control inputs of the second set are independent of the control inputs of the first set, and the second control member is configured to be manipulated by the thumb of the user's hand that is gripping of the first control member.

Extended operation of a controller with a second member with a thumb for independent control inputs might lead to thumb fatigue. The third control member is positioned to be manipulated by one or more digits other than the index finger of the user's single hand and is coupled with the second member to move in opposition to movement of the second control member in one of the degrees of freedom of the second control member. The third control member, such as a paddle, is mounted on the first member in a position for the third, fourth and fifth digits on the user's hand (or a sub-set of these) to squeeze or rotate the third member. The third member is coupled to the second member to push it up, along a Z-axis, when the third member is moved to thereby hold the thumb up. The thumb is less likely to be fatigued. Pushing down the second control member may, if desired, also push outwardly from the controller the third control member, allowing the thumb and accessory digits to be in a dynamic balance.

A controller with these features can be used to allow the controller to decouple translation from attitude adjustments in the control requirements of computer aided design, drone flight, various types of computer games, virtual and augmented reality and other virtual and physical tasks where precise movement through space is required.

In a separate aspect of the disclosure, a hand controller having at least first and second control members (and, optionally, a third control member), which is configured for gripping by a user's single hand, may be coupled with a wrist or forearm brace that serves as a reference for rotational axes, particularly yaw. Yaw is difficult to measure with an inertial measurement unit (IMU) within a hand-held controller. For example, although an IMU in the hand controller might be able to sense and measure with sufficient precision and sensitivity pitch and roll (rotation about the X and Y axes) of the first member, it has been found that outputs of an IMU for rotation about the Z-axis corresponding to yaw of the first control member can be noisy. A

linkage between the first control member and a user's wrist or forearm and a potentiometer, optical encoder, or other types of sensor for measuring rotation can be used to sense yaw.

According to one aspect of the several representative embodiments described below, a single-handed controller that mounts on the wrist and that registers displacement from a neutral position defined relative to the wrist, allowing flight, gaming or augmented reality motion control in up to six degrees of freedom of motion (6-DoF) with precision. Passive mechanical, vibration haptic or active mechanical feedback may inform the user of their displacement from zero in each of these 6-DoF. With such a single-handed control, movement through the air like a fighter pilot with intuitive (non-deliberate cognitive) inputs is possible.

In accordance with another aspect of the disclosure, a forearm brace coupled with a controller can be used in combination with an index finger loop to open or close a grasp on an object in a virtual world.

Another aspect of different ones of the representative embodiments of hand controllers described below, involves a two-handed controller that provides a consistent, known reference frame stabilized by the non-dominant hand even while moving, e.g., walking, skiing, running, driving. The hand controller can be plugged into the surface of a base, allowing the non-flying hand to stabilize the base as it is being flown. Moving a point of reference (POR) through physical or virtual space by way of a hand controller raises the problem of requiring insight into displacement in every degree of freedom being controlled so that the location of the "zero input" is known for each degree of freedom. For example, for drones, the zero input positions for x, y, and z axes and yaw need to be always known. Other flight regimes, such as virtual and augmented reality, computer gaming and surgical robotics may require as many as six independent degrees of freedom simultaneously (movement along x, y, and z axes, and pitch, yaw, and roll). Moreover, for drone flight and virtual and augmented reality systems in particular, the ability to be mobile while maintaining precise control of the point of reference is desirable.

In one of these representative embodiments, a first control member in the form of a joystick mounted to a base allows for pitch, yaw and roll inputs where it connects to the base, with centering mechanisms to generate forces to inform the user of zero. A second control member on top of the joystick, in a position that can operated with a thumb (or possibly another digit), being displaced or moved along x and y axes to generate control outputs for x-axis and y-axis movement and being displaceable up or down to receive input for z-axis movement

Various aspects, advantages, features and embodiments are included in the following description of exemplary examples thereof, which description should be taken in conjunction with the accompanying drawings. All patents, patent applications, articles, other publications, documents and things referenced herein are hereby incorporated herein by this reference in their entirety for all purposes. To the extent of any inconsistency or conflict in the definition or use of terms between any of the incorporated publications, documents or things and the present application, those of the present application shall prevail.

BRIEF DESCRIPTION OF THE DRAWINGS

For promoting an understanding of the principles of the invention that is claimed below, reference will now be made to the embodiments, or examples, illustrated in the appended

drawings. It will be understood that, by describing specific embodiments and examples, no limitation of the scope of the invention, beyond the express terms set out in the claims, is intended. Alterations and further modifications to the described embodiments and examples are possible while making use of the claimed subject matter, and therefore are contemplated as being within the scope of the invention as claimed.

FIG. 1 is a schematic view of an embodiment of a control system.

FIG. 2 is a flowchart illustrating an embodiment of a method for controlling a control target.

FIG. 3 is a side view illustrating an embodiment of a user using the controller depicted in FIG. 2A-FIG. 2G with a single hand.

FIG. 4A is a side view illustrating an embodiment of a physical or virtual vehicle control target executing movements according to the method of FIG. 2.

FIG. 4B is a top view illustrating an embodiment of the physical or virtual vehicle control target of FIG. 4A executing movements according to the method of FIG. 4A.

FIG. 4C is a front view illustrating an embodiment of the physical or virtual vehicle control target of FIG. 4A executing movements according to the method of FIG. 2.

FIG. 4D is a perspective view illustrating an embodiment of a tool control target executing movements according to the method of FIG. 2.

FIG. 5 is a flowchart illustrating an embodiment of a method for controlling a control target.

FIG. 6 is a flowchart illustrating an embodiment of a method for configuring a controller.

FIG. 7 is a side view of a first, representative embodiment of a single-hand controller.

FIG. 8A is a perspective view of a second, representative embodiment of a single-hand controller that is partially assembled, with a pivoting platform for a second control member in a first position.

FIG. 8B is a perspective view of the second, representative embodiment of a single-hand controller that is partially assembled, with the pivoting platform for the second control member in a second position.

FIG. 8C is a perspective view of the second, representative embodiment of a single-hand controller in a different state of assembly than shown in FIGS. 8A and 8B, with one-half of a housing forming a first control member removed.

FIG. 9 illustrates a perspective view of a third, representative embodiment of a controller having a secondary control member in the form of a thumb loop.

FIG. 10 illustrates a perspective view of a fourth, representative embodiment of a controller having a gantry-type secondary control member.

FIG. 11 illustrates a perspective view of a fifth, representative embodiment of a controller having a trackball-type secondary control member.

FIG. 12 is a perspective view of a mobile, two-handed control system having a controller mounted to a base.

FIG. 13 is a perspective view of a controller mounted to a base having input buttons.

FIG. 14 is a perspective view of a single-handed controller mounted to a wired base.

FIG. 15 is a perspective illustration of another, representative example and embodiment single-handed controller that is amounted to a bracket connected with a user's forearm.

5

FIG. 16 is a perspective view of yet another representative example and embodiment of a hand controller connected with to a forearm attachment worn by a user.

FIG. 17 is a perspective view of a representative example of a handle controller coupled with a cuff mounted on a user's forearm.

FIG. 18 is a side view of the representative example of a handle controller coupled with a cuff mounted on a user's forearm shown in FIG. 17.

FIG. 19A is a top view of a representative example of a control system having a double-gimbal link between a forearm attachment and a hand controller.

FIG. 19B is a side view of the control system of FIG. 19A.

FIG. 19C is a perspective view of the control system of FIG. 19A.

FIG. 19D is a perspective view of a second, representative example of a control system having a double-gimbal link between a forearm attachment and a hand controller.

FIG. 20A is a side view of another, representative example of a control system of a control system having a double-gimbal link between a forearm attachment and a hand controller.

FIG. 20B is a different side view of the control system of FIG. 20A.

DESCRIPTION OF ILLUSTRATIVE EMBODIMENTS

In the drawings and description that follows, the drawings are not necessarily to scale. Certain features of the invention may be shown exaggerated in scale or in somewhat schematic form and some details of conventional elements may not be shown in the interest of clarity and conciseness. The present disclosure is susceptible to embodiments of different forms. Specific embodiments are described in detail and are shown in the drawings, with the understanding that the present disclosure is to be considered an exemplification of the principles of the invention, and is not intended to limit the invention to that illustrated and described herein. It is to be fully recognized that the different teachings of the embodiments discussed below may be employed separately or in any suitable combination to produce desired results. The various characteristics mentioned above, as well as other features and characteristics described in more detail below, will be readily apparent to those skilled in the art upon reading the following description of illustrative embodiments of the invention, and by referring to the drawings that accompany the specification.

The present disclosure describes several embodiments of a control system that allows a user to control a control target in up to six degrees of freedom (6-DOF) using a single controller. In one embodiment, a unified hand controller may include a first control member for receiving a first set of one, two or three inputs from a user and a second control member that extends from the first control member that can receive a second set of one, two or three additional inputs from the user. These controller maps inputs to preselected outputs that are used to control a target control system. The first control member and the second control member on the unified hand controller may be repositioned by a user using a single hand to control the control target in up to six degrees of freedom.

More specifically, in some of the embodiments of a control system described below, a user is able to control a control target in six DOF (6-DOF) using a single controller. In one embodiment, a unified hand controller may include a first control member for receiving rotational inputs (e.g., pitch, yaw, and roll) and a second control member that

6

extends from the first control member and that is for receiving translational inputs (e.g., movement along x, y, and z axes). As described in further detail below, the first control member and the second control member on the unified hand controller may be repositioned by a user using a single hand to control the control target in 6-DOF.

The embodiments described below are examples of an improved single-hand controller with one or more additional features as compared to prior art hand controllers. These additional features and enhancements include: improved Z-axis spring forces and self-centering/zeroing capability for a second member that is controlled by a user's thumb when gripping a first member of a controller; a larger gantry on top of first member for moving the second member in along X and Y axes; a replaceable or resizable thumb loop for the second control member; a forearm or wrist stabilization for ambulatory use (potentiometers or optical encoders for translations along X, Y and Z axes, such as for use in drone applications and for integrating with virtual/augmented reality); a mouse-based implementation for improved CAD object manipulation; and combinations of any two or more of the preceding features.

The hand controller with any one or more of these features, and their variations, can be used in applications such as flight simulation, computer aided design (CAD), drone flight, fixed wing and rotary wing flight, computer gaming, virtual and augmented reality navigation, terrestrial and marine robotic control, and many others, some of which are described below.

Referring initially to FIG. 1, a control system 100 for controlling a control target in 6-DOF. The control system 100 includes a controller 102 that is coupled to a signal conversion system 104 that is further coupled to a control target 106. In an embodiment, the control target 106 may include end effectors (e.g., the end of a robotic forceps, a robotic arm end effector with snares), camera field-of-views (e.g., including a camera center field-of-view and zoom), vehicle velocity vectors, etc. While the controller 102 and the signal conversion system 104 are illustrated separately, one of ordinary skill in the art will recognize that some or all of the controller 102 and the signal conversion system 104 may be combined without departing from the scope of the present disclosure.

The controller 102 includes a first control member 102a and a second control member 102b that is located on the first control member 102a. In this description, controller 102 is intended to be representative of the all of the controllers described herein, unless otherwise indicated. A controller processor 102c is coupled to each of the first control member 102a and the second control member 102b. In an embodiment, the controller processor 102c may be a central processing unit, a programmable logic controller, and/or a variety of other processors as may be known by one or more of ordinary skill in the art. The controller processor 102c is also coupled to each of a rotational module 102d, a translation module 102e, and a transmitter 102f. While not illustrated or described in any further detail, other connections and coupling may exist between the first control member 102a, the second control member 102b, the controller processor 102c, the rotation module 102d, the translation module 102e, and the transmitter 102f while remaining within the scope of the present disclosure. Furthermore, components of the controller may be combined or substituted with other components as may be known by one or more of ordinary skill in the art while remaining with the scope of the present disclosure.

The signal conversion system **104** in the control system **100** includes a transceiver **104a** that may couple to the transmitter **102f** in the controller **102** through a wired connection, a wireless connection, and/or a variety of other connections as may be known by one or more of ordinary skill in the art. A conversion processor **104b** is coupled to the transceiver **104a**, a control module **104c**, and configuration parameters **104d** that may be included on a memory, a storage device, and/or other computer-readable mediums as may be known by one or more of ordinary skill in the art. In an embodiment, the conversion processor **104b** may be a central processing unit, a programmable logic controller, and/or a variety of other processors known to those of ordinary skill in the art. While not illustrated or described in any further detail, other connections and coupling may exist between the transceiver **104a**, the conversion processor **104b**, the control module **104c**, and the configuration parameters **104d** while remaining within the scope of the present disclosure. Furthermore, components of the signal conversion system **104** may be combined or substituted with other components as may be known by one or more of ordinary skill in the art while remaining within the scope of the present disclosure. The control module **104c** may be coupled to the control target **106** through a wired connection, a wireless connection, and/or a variety of other connections as may be known by one or more of ordinary skill in the art.

In an embodiment, the controller **102** is configured to receive input from a user through the first control member **102a** and/or the second control member **102b** and transmit a signal based on the input. For example, the controller **102** may be provided as a “joystick” for navigating in a virtual environment (e.g., in a video game, on a real-world simulator, as part of a remote control virtual/real-world control system, and/or in a variety of other virtual environments as may be known by one or more of ordinary skill in the art.) In another example, the controller **102** may be provided as a control stick for controlling a vehicle (e.g., an aircraft, a submersible, a spacecraft, and/or a variety of other vehicles as may be known by one or more of ordinary skill in the art). In another example, the controller **102** may be provided as a control stick for controlling a robot or other non-vehicle device (e.g., a surgical device, an assembly device, and/or variety of other non-vehicle devices known to one of ordinary skill in the art).

In the embodiment discussed in further detail below, the controller **102** includes a control stick as the first control member **102a** that is configured to be repositioned by the user. The repositioning of the control stick first control member **102a** allows the user to provide rotational inputs using the first control member **102a** that include pitch inputs, yaw inputs, and roll inputs, and causes the controller processor **102c** to output rotational movement output signals including pitch movement output signals, a yaw movement output signals, and roll movement output signals. In particular, tilting the control stick first control member **102a** forward and backward may provide the pitch input that produces the pitch movement output signal, rotating the control stick first control member **102a** left and right about its longitudinal axis may provide the yaw input that produces the yaw movement output signal, and tilting the control stick first control member **102a** side to side may provide the roll input that produces the roll movement output signal. As discussed below, the movement output signals that result from the repositioning of the first control member **102a** may be reconfigured from that discussed above such that similar movements of the first control member **102a** to those discussed above result in different

inputs and movement output signals (e.g., tilting the control stick first control member **102a** side to side may be configured to provide the yaw input that produces the yaw movement output signal while rotating the control stick first control member **102a** about its longitudinal axis may be configured provide the roll input that produces the roll movement output signal.)

Rotational inputs using the control stick first control member **102a** may be detected and/or measured using the rotational module **102d**. For example, the rotational module **102d** may include displacement detectors for detecting the displacement of the control stick first control member **102a** from a starting position as one or more of the pitch inputs, yaw inputs, and roll inputs discussed above. Displacement detectors may include photo detectors for detecting light beams, rotary and/or linear potentiometers, inductively coupled coils, physical actuators, gyroscopes, switches, transducers, and/or a variety of other displacement detectors as may be known by one or more of ordinary skill in the art. In some embodiments, the rotational module **102d** may include accelerometers for detecting the displacement of the control stick first control member **102a** from a starting position in space. For example, the accelerometers may each measure the proper acceleration of the control stick first control member **102a** with respect to an inertial frame of reference.

In other embodiments, inputs using the control stick first control member **102a** may be detected and/or measured using breakout switches, transducers, and/or direct switches for each of the three ranges of motion (e.g., front to back, side to side, and rotation about a longitudinal axis) of the control stick first control member **102a**. For example, breakout switches may be used to detect when the control stick first control member **102a** is initially moved (e.g., 2°) from a null position for each range of rotation, transducers may provide a signal that is proportional to the displacement of the control stick first control member **102a** for each range of motion, and direct switches may detect when the control stick first control member **102a** is further moved (e.g., 12°) from the null position for each range of motion. The breakout switches and direct switches may also allow for acceleration of the control stick first control member **102a** to be detected. In an embodiment, redundant detectors and/or switches may be provided in the controller **102** to ensure that the control system **100** is fault tolerant.

In the embodiment discussed in further detail below, the second control member **102b** extends from a top, distal portion of the control stick first control member **102a** and is configured to be repositioned by the user independently from and relative to the control stick first control member **102a**. The repositioning of the second control member **102b** discussed below allows the user to provide translational inputs using the second control member **102b** that include x-axis inputs, y-axis inputs, and z-axis inputs, and causes the control processor **102c** to output a translational movement output signals including x-axis movement output signals, y-axis movement output signals, and z-axis movement output signals. For example, tilting the second control member **102b** forward and backward may provide the x-axis input that produces the x-axis movement output signal, tilting the second control member **102b** side to side may provide the y-axis input that produces the y-axis movement output signal, and moving the second control member **102b** up and down may provide the z-axis input that produces the z-axis movement output signal. As discussed below, the signals that result from the repositioning of the second control member **102b** may be reconfigured from that discussed

above such that similar movements of the second control member **102b** to those discussed above result in different inputs and movement output signals (e.g., tilting the second control member **102b** forward and backward may be configured to provide the z-axis input that produces the z-axis movement output signal while moving the second control member **102b** up and down may be configured to provide the x-axis input that produces the x-axis movement output signal.) In an embodiment, the second control member **102b** is configured to be repositioned solely by a thumb of the user while the user is gripping the control stick first control member **102a** with the hand that includes that thumb.

Translational inputs using the second control member **102b** may be detected and/or measured using the translation module **102e**. For example, the translation module **102e** may include translational detectors for detecting the displacement of the second control member **102b** from a starting position as one or more of the x-axis inputs, y-axis inputs, and z-axis inputs discussed above. Translation detectors may include physical actuators, translational accelerometers, and/or a variety of other translation detectors as may be known by one or more of ordinary skill in the art (e.g., many of the detectors and switches discussed above for detecting and/or measuring rotational input may be repurposed for detecting and/or measuring translation input.)

In an embodiment, the controller processor **102c** of the controller **102** is configured to generate control signals to be transmitted by the transmitter **102f**. As discussed above, the controller processor **102c** may be configured to generate a control signal based on one or more rotational inputs detected and/or measured by the rotational module **102d** and/or one or more translational inputs detected and/or measured by the translation module **102e**. Those control signals generated by the controller processor **102c** may include parameters defining movement output signals for one or more of 6-DOF (i.e., pitch, yaw, roll, movement along an x-axis, movement along a y-axis, movement along a z-axis). In several embodiments, a discrete control signal type (e.g., yaw output signals, pitch output signals, roll output signals, x-axis movement output signals, y-axis movement output signals, and z-axis movement output signals) is produced for each discrete predefined movement (e.g., first control member **102a** movement for providing pitch input, first control member **102a** movement for providing yaw input, first control member **102a** movement for providing roll input, second control member **102b** movement for providing x-axis input, second control member **102b** movement for providing y-axis input, and second control member **102b** movement for providing z-axis input) that produces that discrete control signal. Beyond 6-DOF control, discrete features such as ON/OFF, trim, and other multi-function commands may be transmitted to the control target. Conversely, data or feedback may be received on the controller **102** (e.g., an indicator such as an LED may be illuminated green to indicate the controller **102** is on.)

In an embodiment, the transmitter **102f** of the controller **102** is configured to transmit the control signal through a wired or wireless connection. For example, the control signal may be one or more of a radio frequency (“RF”) signal, an infrared (“IR”) signal, a visible light signal, and/or a variety of other control signals as may be known by one or more of ordinary skill in the art. In some embodiments, the transmitter **102f** may be a BLUETOOTH® transmitter configured to transmit the control signal as an RF signal according to the BLUETOOTH® protocol (BLUETOOTH® is a registered trademark of the Bluetooth

Special Interest Group, a privately held, not-for-profit trade association headquartered in Kirkland, Wash., USA).

In an embodiment, the transceiver **104a** of the signal conversion system **104** is configured to receive the control signal transmitted by the transmitter **102f** of the controller **102** through a wired or wireless connection, discussed above, and provide the received control signal to the conversion processor **104b** of the signal conversion system **104**.

In an embodiment, the conversion processor **104b** is configured to process the control signals received from the controller **102**. For example, the conversion processor **104b** may be coupled to a computer-readable medium including instructions that, when executed by the conversion processor **104b**, cause the conversion processor **104b** to provide a control program that is configured to convert the control signal into movement commands and use the control module **104c** of the signal conversion system **104** to control the control target **106** according to the movement commands. In an embodiment, the conversion processor **104b** may convert the control signal into movement commands for a virtual three-dimensional (“3D”) environment (e.g., a virtual representation of surgical patient, a video game, a simulator, and/or a variety of other virtual 3D environments as may be known by one or more of ordinary skill in the art.). Thus, the control target **106** may exist in a virtual space, and the user may be provided a point of view or a virtual representation of the virtual environment from a point of view inside the control target (i.e., the control system **100** may include a display that provides the user a point of view from the control target in the virtual environment). In another example, the control target **106** may be a physical device such as a robot, an end effector, a surgical tool, a lifting system, etc., and/or a variety of steerable mechanical devices, including, without limitation, vehicles such as unmanned or remotely-piloted vehicles (e.g., “drones”); manned, unmanned, or remotely-piloted vehicles and land-craft; manned, unmanned, or remotely-piloted aircraft; manned, unmanned, or remotely-piloted watercraft; manned, unmanned, or remotely-piloted submersibles; as well as manned, unmanned, or remotely-piloted space vehicles, rocketry, satellites, and such like.

In an embodiment, the control module **104c** of the signal conversion system **104** is configured to control movement of the control target **106** based on the movement commands provided from the control program in signal conversion system **104**. In some embodiments, if the control target **106** is in a virtual environment, the control module **104c** may include an application programming interface (API) for moving a virtual representation or point of view within the virtual environment. APIs may also provide the control module **104c** with feedback from the virtual environment such as, for example, collision feedback. In some embodiments, feedback from the control target **106** may allow the control module **104c** to automatically adjust the movement of the control target to, for example, avoid a collision with a designated region (e.g., objects in a real or virtual environment, critical regions of a real or virtual patient, etc.). In other embodiments, if the control target **106** is a physical device, the control module **104c** may include one or more controllers for controlling the movement of the physical device. For example, the signal conversion system **104** may be installed on-board a vehicle, and the control module **104c** may include a variety of physical controllers for controlling various propulsion and/or steering mechanisms of the vehicle.

In an embodiment, the signal conversion system **104** includes operating parameters **104d** for use by the conver-

sion processor **104b** when generating movement commands using the signals from the controller **102**. Operating parameters may include, but are not limited to, gains (i.e., sensitivity), rates of onset (i.e., lag), deadbands (i.e., neutral), limits (i.e., maximum angular displacement), and/or a variety of other operating parameters as may be known by one or more of ordinary skill in the art. In an embodiment, the gains of the first control member **102a** and the second control member **102b** may be independently defined by a user. In this example, the second control member **102b** may have increased sensitivity compared to the control stick first control member **102a** to compensate, for example, for the second control member **102b** having a smaller range of motion that the control stick first control member **102a**. Similarly, the rates of onset for the first control member **102a** and the second control member **102b** may be defined independently to determine the amount of time that should pass (i.e., lag) before a repositioning of the first control member **102a** and the second control member **102b** should be converted to actual movement of the control target **106**. The limits and deadbands of the first control member **102a** and the second control member **102b** may be independently defined as well by calibrating the neutral and maximal positions of each.

In an embodiment, operating parameters may also define how signals sent from the controller **102** in response to the different movements of the first control member **102a** and the second control member **102b** are translated into movement commands that are sent to the control target. As discussed above, particular movements of the first control member **102a** may produce pitch, yaw, and roll rotational movement output signals, while particular movements of the second control member **102b** may produce x-axis, y-axis, and z-axis translational movement output signals. In an embodiment, the operating parameters may define which movement commands are sent to the control target **106** in response to movements and resulting movement output signals from the first control member **102a** and second control member **102b**.

A single hand controller like the ones described shown in FIGS. 7-20B, can provide up to 6 degrees of freedom control. For applications in many types of physical and virtual 3-D environments, all 6 degrees of freedom may be required, such as moving a spacecraft or many types of aircraft, or certain computer games and virtual reality and augmented reality environments. In many of these cases, the best way to manage them is to map the x-axis, y-axis, and z-axis translational output signals generated by displacement of the second control member to x-axis, y-axis and z-axis movements in the target application, and use the pitch, roll and yaw rotational output signals generated by displacement of the first control member to provide rotational control output signals that control pitch, roll and yaw in the target application.

However, for many other applications like drone flight, when only 4 command axes are needed, a user's inputs might be split in different ways, depending whether the hand controller is mounted on a fixed base for the controller, stabilized by the non-dominant hand, or coupled with a forearm brace. For example, when using a forearm brace to support the hand controller and provide a frame of reference, it might be more desirable to control the y-axis movement of the drone using the second member, but use the first control member to control x-axis movement and yaw. Because the controller's individual input "devices" are easily programmable, you have the ability to choose whatever combination of inputs and axes you'd like.

In some embodiments, the configuration parameters **104d** may be received from an external computing device (not shown) operated by the user. For example, the external computing device may be preconfigured with software for interfacing with the controller **102** and/or the signal conversion system **104**. In other embodiments, the configuration parameters **104d** may be input directly by a user using a display screen included with the controller **102** or the signal conversion system **104**. For example, the first control member **102a** and/or second control member **102b** may be used to navigate a configuration menu for defining the configuration parameters **104d**.

Referring now to FIGS. 2 and 3, a method **400** for controlling a control target is illustrated using one of as single hand controller. The illustrated controller in FIG. 3 is representative of single hand controllers having a first control member gripped by a user's hand, which can be displaced to generate a first set of control outputs and a second control member that is positioned on the first control member, to be manipulated by the thumb on the hand gripping the first control member, to generate a second set of control outputs. Any of the single hand controllers described herein may be used with the methods described in connection with these figures, unless otherwise specifically stated. As is the case with the other methods described herein, various embodiments may not include all of the steps described below, may include additional steps, and may sequence the steps differently. Accordingly, the specific arrangement of steps shown in FIG. 2 should not be construed as limiting the scope of controlling the movement of a control target.

The method **400** begins at block **402** where an input is received from a user. As previously discussed, a user may grasp the first control member with a hand, while using a thumb on a second control member. As illustrated in FIG. 3, a user may grasp the first control member **204** with a hand **402a**, while extending a thumb **402b** through the thumb channel defined by the second control member **208**. Furthermore, the user may position a finger **402c** over the control button **206**. One of ordinary skill in the art will recognize that while a specific embodiment having the second control member **208** positioned for thumb actuation and control button **206** for finger actuation are illustrated, other embodiments that include repositioning of the second control member **208** (e.g., for actuation by a finger other than the thumb), repositioning of the control button **206** (e.g., for actuation by a finger other than the finger illustrated in FIG. 3), additional control buttons, and a variety of other features will fall within the scope of the present disclosure.

In an embodiment, the input from the user at block **402** of the method **400** may include one or more rotational inputs (i.e., a yaw input, a pitch input, and a roll input) and one or more translational inputs (i.e., movement along an x-axis, a y-axis, and/or a z-axis) that are provided by the user using, for example, the controllers. The user may reposition the first control member to provide rotational inputs and reposition the second control member to provide translational inputs. The controller is "unified" in that it is capable of being operated by a single hand of the user. In other words, the controller allows the user to simultaneously provide rotational and translational inputs with a single hand without cross-coupling inputs (i.e., the outputs from the hand controller are "pure").

As discussed above, the rotational and translational input may be detected using various devices such as photo detectors for detecting light beams, rotary and/or linear potentiometers, inductively coupled coils, physical actuators, gyroscopes, accelerometers, and a variety of other devices as

13

may be known by one or more of ordinary skill in the art. A specific example of movements of the first control member and the second control member and their results on the control target **106** are discussed below, but as discussed above, any movements of the first control member and the second control member may be reprogrammed or repurposed to the desires of the user (including reprogramming reference frames by swapping the coordinate systems based on the desires of a user), and thus the discussion below is merely exemplary of one embodiment of the present disclosure.

As illustrated in FIG. 3, the user may use his/her hand **402a** to move the first control member **204** back and forth along a line A (e.g., on its coupling to the base **202** for the controller **200**, by tilting the grip portion **204c** that is coupled to the first section **204b** of the first control member **204** along the line A relative to the bottom portion of the first control member **204** for the controller **200**), in order to provide pitch inputs to the controller **200**. The grip portion **204c** of the first control member **204** includes a top surface **204d** that is located opposite the grip portion **204c** from the first section of **204b** of the first control member **204**. As illustrated in FIG. 3, the user may use his/her hand **402a** to rotate the first control member **204** back and forth about its longitudinal axis on an arc B (e.g., on its coupling to the base **202** for the controller **200**, by rotating the grip portion **204c** of the first control member **204** along the line B relative to the bottom portion of the first control member **204** for the controller **200**), in order to provide yaw inputs to the controller **200** or **300**. As illustrated in FIG. 3, the user may use their hand **402a** to move the first control member **204** side to side along a line C (e.g., on its coupling to the base **202** for the controller **200**, by tilting the grip portion **204c** of the first control member **204** along the line B relative to the bottom portion of the first control member **204** for the controller **200**), in order to provide roll inputs to the controller **200**. Furthermore, additional inputs may be provided using other features of the controller **200**. For example, the resilient member may provide a neutral position of the first control member **204** such that compressing the resilient member using the first control member **204** provides a first input and extending the resilient member using the first control member **204** provides a second input.

The second control member **208** includes a support portion **208b** that extends from the first control member. The second control member also includes an actuation portion **208c** that is coupled to the support portion of **208b** of the first control member **204**. As illustrated in FIG. 3, the user may use the thumb **402b** to move the second control member **208** forwards and backwards along a line E (e.g., on its coupling to the first control member **204**), in order to provide x-axis inputs to the controller **200**. As illustrated in FIG. 3, the user may use the thumb **402b** to move the second control member **208** back and forth along a line D (e.g., on its coupling to the first control member **204**), in order to provide y-axis inputs to the controller **200**. As illustrated in FIG. 3, the user may use the thumb **402b** to move the second control member **208** up and down along a line F (e.g., on its coupling to the first control member **204** including, in some embodiments, with resistance from the resilient member), in order to provide z-axis inputs to the controller **200**. In an embodiment, the resilient member may provide a neutral position of the second control member **208** such that compressing the resilient member using the second control member **208** provides a first z-axis input for z-axis movement of the control target **106** in a first direction, and extending the resilient member using the second control member **208**

14

provides a second z-axis input for z-axis movement of the control target **106** in a second direction that is opposite the first direction.

The method **400** then proceeds to block **404** where a control signal is generated based on the user input received in block **402** and then transmitted. As discussed above, the controller processor **102c** and the rotational module **102d** may generate rotational movement output signals in response to detecting and/or measuring the rotational inputs discussed above, and the control processor **102c** and the translation module **102e** may generate translational movement output signals in response to detecting and/or measuring the translation inputs discussed above. Furthermore, control signals may include indications of absolute deflection or displacement of the control members, rate of deflection or displacement of the control members, duration of deflection or displacement of the control members, variance of the control members from a central deadband, and/or a variety of other control signals known in the art.) For example, control signals may be generated based on the rotational and/or translational input or inputs according to the BLUETOOTH® protocol. Once generated, the control signals may be transmitted as an RF signal by an RF transmitter according to the BLUETOOTH® protocol. Those skilled in the art will appreciate that an RF signal may be generated and transmitted according to a variety of other RF protocols such as the ZIGBEE® protocol, the Wireless USB protocol, etc. In other examples, the control signal may be transmitted as an IR signal, a visible light signal, or as some other signal suitable for transmitting the control information. (ZIGBEE® is a registered trademark of the ZigBee Alliance, an association of companies headquartered in San Ramon, Calif., USA).

The method **400** then proceeds to block **406** where a transceiver receives a signal generated and transmitted by the controller. In an embodiment, the transceiver **102** of the signal conversion system **104** receives the control signal generated and transmitted by the controller **102**, **200**, **300**. In an embodiment in which the control signal is an RF signal, the transceiver **104a** includes an RF sensor configured to receive a signal according to the appropriate protocol (e.g., BLUETOOTH®, ZIGBEE®, Wireless USB, etc.).

In other embodiments, the control signal may be transmitted over a wired connection. In this case, the transmitter **102f** of the controller **102** and the transceiver **104a** of the signal conversion system **104** may be physically connected by a cable such as a universal serial bus (USB) cable, serial cable, parallel cable, proprietary cable, etc.

The method **400** then proceeds to block **408** where control program provided by the conversion processor **104b** of the signal conversion system **104** commands movement based on the control signals received in block **406**. In an embodiment, the control program may convert the control signals to movement commands that may include rotational movement instructions and/or translational movement instructions based on the rotational movement output signals and/or translational movement output signals in the control signals. Other discrete features such as ON/OFF, camera zoom, share capture, and so on can also be relayed. For example, the movement commands may specify parameters for defining the movement of the control target **106** in one or more DOF. Using the example discussed above, if the user uses their hand **402a** to move the first control member **204** back and forth along a line A (illustrated in FIG. 3), the resulting control signal may be used by the control program to generate a movement command including a pitch movement instruction for modifying a pitch of the control target **106**. If

the user uses their hand **402a** to rotate the first control member **204** back and forth about its longitudinal axis about an arc B (illustrated in FIG. 3), the resulting control signal may be used by the control program to generate a movement command including a yaw movement instruction for modifying a yaw of the control target **106**. If the user uses their hand **402a** to move the first control member **204** side to side along a line C (illustrated in FIG. 3), the resulting control signal may be used by the control program to generate a movement command including a roll movement instruction for modifying a roll of the control target **106**.

Furthermore, if the user uses their thumb **402b** to move the second control member **208** forward and backwards along a line E (illustrated in FIG. 3), the resulting control signal may be used by the control program to generate a movement command including an x-axis movement instruction for modifying the position of the control target **106** along an x-axis. If the user uses their thumb **402b** to move the second control member **208** back and forth along a line E (illustrated in FIG. 3), the resulting control signal may be used by the control program to generate a movement command including a y-axis movement instruction for modifying the position of the control target **106** along a y-axis. If the user uses their thumb **402b** to move the second control member **208** side to side along a line D (illustrated in FIG. 3), the resulting control signal may be used by the control program to generate a movement command including a z-axis movement instruction for modifying the position of the control target **106** along a z-axis.

The method **400** then proceeds to block **410** where the movement of the control target **106** is performed based on the movement commands. In an embodiment, a point of view or a virtual representation of the user may be moved in a virtual environment based on the movement commands at block **410** of the method **400**. In another embodiment, an end effector, a propulsion mechanism, and/or a steering mechanism of a vehicle may be actuated based on the movement commands at block **410** of the method **400**.

FIG. 4A, FIG. 4B, and FIG. 4C illustrate a control target **410a** that may be, for example, the control target **106** discussed above, with reference to FIG. 1. As discussed above, the control target **410a** may include a physical vehicle in which the user is located, a remotely operated vehicle where the user operates the vehicle remotely from the vehicle, a virtual vehicle operated by the user through the provision of a point-of-view to the user from within the virtual vehicle, and/or a variety of other control targets as may be known by one or more of ordinary skill in the art. Using the example above, if the user uses their hand **402a** to move the first control member **204** back and forth along a line A (illustrated in FIG. 3), the movement command resulting from the control signal generated will cause the control target **410a** to modify its pitch about an arc AA, illustrated in FIG. 4B. If the user uses their hand **402a** to rotate the first control member **204** back and forth about its longitudinal axis about an arc B (illustrated in FIG. 3), the movement command resulting from the control signal generated will cause the control target **410a** to modify its yaw about an arc BB, illustrated in FIG. 4B. If the user uses their hand **402a** to move the first control member **204** side to side along a line C (illustrated in FIG. 3), the movement command resulting from the control signal generated will cause the control target **410a** to modify its roll about an arc CC, illustrated in FIG. 4C.

Furthermore, if the user uses his/her thumb **402b** to move the second control member **208** forward and backwards along a line E (illustrated in FIG. 3), the movement com-

mand resulting from the control signal generated will cause the control target **410a** to move along a line EE (i.e., its x-axis), illustrated in FIG. 4B and FIG. 4C. If the user uses his/her thumb **402b** to move the second control member **208** side to side along a line D (illustrated in FIG. 3), the movement command resulting from the control signal generated will cause the control target **410a** to move along a line DD (i.e., its y-axis), illustrated in FIG. 4A and FIG. 4B. If the user uses his/her thumb **402b** to move the second control member **208** back and forth along a line F (illustrated in FIG. 3), the movement command resulting from the control signal generated will cause the control target **410a** to move along a line FF (i.e., its z-axis), illustrated in FIG. 4A and FIG. 4C. In some embodiments, the control button **206** and/or other control buttons on the controller **102**, **200**, or **300** may be used to, for example, actuate other systems in the control target **410a** (e.g., weapons systems).

FIG. 4D illustrates a control target **410b** that may be, for example, the control target **106** discussed above, with reference to FIG. 1. As discussed above, the control target **410b** may include a physical device or other tool that executed movements according to signals sent from the controller **102**, **200**, or **300**. Using the example above, if the user uses their hand **402a** to move the first control member **204** back and forth along a line A (illustrated in FIG. 3), the movement command resulting from the control signal generated will cause the control target **410b** to rotate a tool member or end effector **410c** about a joint **410d** along an arc AAA, illustrated in FIG. 4D. If the user uses their hand **402a** to rotate the first control member **204** back and forth about its longitudinal axis about an arc B (illustrated in FIG. 3), the movement command resulting from the control signal generated will cause the control target **410b** to rotate the tool member or end effector **410c** about a joint **410e** along an arc BBB, illustrated in FIG. 4D. If the user uses his/her hand **402a** to move the first control member **204** side to side along a line C (illustrated in FIG. 3), the movement command resulting from the control signal generated will cause the control target **410b** to rotate the tool member or end effector **410c** about a joint **410f** along an arc CCC, illustrated in FIG. 4D.

Furthermore, if the user uses his/her thumb **402b** to move the second control member **208** forwards and backwards along a line E (illustrated in FIG. 3), the movement command resulting from the control signal generated will cause the tool member or end effector **410c** to move along a line EEE (i.e., its x-axis), illustrated in FIG. 4D. If the user uses his/her thumb **402b** to move the second control member **208** back and forth along a line E (illustrated in FIG. 3), the movement command resulting from the control signal generated will cause the control target **410b** to move along a line EEE (i.e., its y-axis through the joint **410f**), illustrated in FIG. 4D. If the user uses his/her thumb **402b** to move the second control member **208** side to side along a line D (illustrated in FIG. 3), the movement command resulting from the control signal generated will cause the tool member or end effector **410c** to move along a line DDD (i.e., its z-axis), illustrated in FIG. 4D. In some embodiments, the control button **206** and/or other control buttons on the controller **102**, **200**, or **300** may be used to, for example, perform actions using the tool member **210c**. Furthermore one of ordinary skill in the art will recognize that the tool member or end effector **410c** illustrated in FIG. 4D may be replaced or supplemented with a variety of tool members (e.g., surgical instruments and the like) without departing from the scope of the present disclosure. As discussed above, the control target **410a** may include a camera on or

adjacent the tool member or end effector **410c** to provide a field of view to allow navigation to a target.

Referring now to FIG. 5, a method **500** for controlling a control target is illustrated. As is the case with the other methods described herein, various embodiments may not include all of the steps described below, may include additional steps, and may sequence the steps differently. Accordingly, the specific arrangement of steps shown in FIG. 5 should not be construed as limiting the scope of controlling the movement of a control target.

The method **500** may begin at block **502** where rotational input is received from a user. The user may provide rotational input by repositioning the first control member **204** of the controller **200** or **300** similarly as discussed above. In some embodiments, the rotational input may be manually detected by a physical device such as an actuator. In other embodiments, the rotational input may be electrically detected by a sensor such as an accelerometer.

The method **500** may proceed simultaneously with block **504** where translational input is received from the user. The user may provide translational input by repositioning the second control member **208** of the controller **200** or **300** similarly as discussed above. The rotational input and the translational input may be provided by the user simultaneously using a single hand of the user. In some embodiments, the translational input may be manually detected by a physical device such as an actuator.

In an embodiment, the rotational and translational input may be provided by a user viewing the current position of a control target **106** on a display screen. For example, the user may be viewing the current position of a surgical device presented within a virtual representation of a patient on a display screen. In this example, the rotational input and translational input may be provided using the current view on the display screen as a frame of reference.

The method **500** then proceeds to block **506** where a control signal is generated based on the rotational input and translational input and then transmitted. In the case of the rotational input being manually detected, the control signal may be generated based on the rotational input and translational input as detected by a number of actuators, which convert the mechanical force being asserted on the first control member **204** and the second control member **208** to an electrical signal to be interpreted as rotational input and translational input, respectively. In the case of the rotational input being electronically detected, the control signal may be generated based on rotational input as detected by accelerometers and translational input as detected by actuators.

In an embodiment, a control signal may be generated based on the rotational input and translational input according to the BLUETOOTH® protocol. Once generated, the control signal may be transmitted as an RF signal by an RF transmitter according to the BLUETOOTH® protocol. One of ordinary skill in the art will appreciate that an RF signal may be generated and transmitted according to a variety of other RF protocols such as the ZIGBEE® protocol, the Wireless USB protocol, etc. In other examples, the control signal may be transmitted as an IR signal, visible light signal, or as some other signal suitable for transmitting the control information.

The method **500** then proceeds to block **508**, the transceiver **104a** of the signal conversion system **104** receives the control signal. In the case that the control signal is an RF signal, the transceiver **104a** includes an RF sensor configured to receive a signal according to the appropriate protocol (e.g., BLUETOOTH®, ZIGBEE®, Wireless USB, etc.). In other embodiments, the control signal may be transmitted

over a wired connection. In this case, the transmitter **102f** and the transceiver **104a** are physically connected by a cable such as a universal serial bus (USB) cable, serial cable, parallel cable, proprietary cable, etc.

The method **500** then proceeds to block **510** where the conversion processor **104b** commands movement in 6 DOF based on the received control signal. Specifically, the control signal may be converted to movement commands based on the rotational and/or translational input in the control signal. The movement commands may specify parameters for defining the movement of a point of view or a virtual representation of the user in one or more DOF in a virtual 3D environment. For example, if the second control member is repositioned upward by the user, the resulting control signal may be used to generate a movement command for moving a point of view of a surgical device up along the z-axis within a 3D representation of a patient's body. In another example, if the first control member is tilted to the left and the second control member is repositioned downward, the resulting control signal may be used to generate movement commands for rolling a surgical device to the left while moving the surgical device down along a z-axis in the 3D representation of the patient's body. Any combination of rotational and translational input may be provided to generate movement commands with varying combinations of parameters in one or more DOF.

The method **500** then proceeds to block **512** where a proportional movement is performed in the virtual and/or real environment based on the movement commands. For example, a point of view of a surgical device in a virtual representation of a patient may be repositioned according to the movement commands, where the point of view corresponds to a camera or sensor affixed to a surgical device. In this example, the surgical device may also be repositioned in the patient's body according to the movement of the surgical device in the virtual representation of the patient's body. The unified controller allows the surgeon to navigate the surgical device in 6-DOF within the patient's body with a single hand.

Referring now to FIG. 6, a method **600** for configuring a controller is illustrated. As is the case with the other methods described herein, various embodiments may not include all of the steps described below, may include additional steps, and may sequence the steps differently. Accordingly, the specific arrangement of steps shown in FIG. 6 should not be construed as limiting the scope of controlling the movement of a control target.

The method **600** begins at block **602** where the controller **102** is connected to an external computing device. The controller **102** may be connected via a physical connection (e.g., USB cable) or any number of wireless protocols (e.g., BLUETOOTH® protocol). The external computing device may be preconfigured with software for interfacing with the controller **102**.

The method **600** then proceeds to block **604** where configuration data is received by the controller **102** from the external computing device. The configuration data may specify configuration parameters such as gains (i.e., sensitivity), rates of onset (i.e., lag), deadbands (i.e., neutral), and/or limits (i.e., maximum angular displacement). The configuration data may also assign movement commands for a control target to movements of the first control member and second control member. The configuration parameters may be specified by the user using the software configured to interface with the controller **102**.

The method **600** then proceeds to block **606** where the operating parameters of the controller **102** are adjusted

based on the configuration data. The operating parameters may be stored in memory and then used by the controller **102** to remotely control a control target as discussed above with respect to FIG. 2 and FIG. 5. In some embodiments, the method **600** may include the ability to set “trim”, establish rates of translation (e.g., cm/sec) or reorientation (e.g., deg/sec), or initiate “auto-sequences” to auto-pilot movements (on a display or on the controller **102** itself.)

In other embodiments, the controller **102** may be equipped with an input device that allows the user to directly configure the operating parameters of the controller **102**. For example, the controller **102** may include a display screen with configuration menus that are navigable using the first control member **204** and/or the second control member **208**.

A computer readable program product stored on a tangible storage media may be used to facilitate any of the preceding embodiments such as, for example, the control program discussed above. For example, embodiments of the invention may be stored on a computer readable medium such as an optical disk e.g., compact disc (CD), digital versatile disc (DVD), etc., a diskette, a tape, a file, a flash memory card, or any other computer readable storage device. In this example, the execution of the computer readable program product may cause a processor to perform the methods discussed above with respect to FIG. 2, FIG. 5, and FIG. 6.

In the following examples of single hand controllers, various aspects allow the controller to separate individual translation from attitude adjustments in the control requirements of computer aided design, drone flight, various types of computer games, virtual and augmented reality and other virtual and physical tasks where precise movement through space is required, while simultaneously providing tactile feedback when away from the “null command” or zero input position.

For example, extended operation of a controller using the thumb for independent control inputs can lead to a “hitch-hiker’s thumb” fatigue issue. By adding a third control member, such as a linked paddle for the 3rd, 4th and 5th digits (or some sub-set of these) of the user’s hand to squeeze or rotate while gripping the first control member, the second controller can be held up or pushed up (in +z direction), thus providing relief. Furthermore, the third control member and the second control member can be linked so that pushing down the second control member pushes out the paddle or third control member. As such, the thumb and accessory digits are in a dynamic balance, which can be quickly mastered.

In other embodiments, the single hand controller can be used as part of a control system that has a wrist or forearm brace to serve as a reference for the rotational axes, particularly yaw that is difficult to measure with an inertial measurement unit (IMU). For example, although an IMU within the body of the first control member of the hand controller may work well for pitch and roll, but yaw can be noisy. Although this may be improved with software modifications, some exemplary embodiments described herein have a linkage to the wrist allows for potentiometers or optical encoders to measure all three rotational axes with precision. In some variants of a forearm brace implementation can use an index finger loop, used to open or close a grasp on an object in a virtual world.

The hand controller examples presented in connection with FIGS. 7-20B and their variations can be used in applications such as those presented above in the preceding section, such flight simulation, CAD, drone flight, and so on. Optional additional features, which may be used alone or, in several case, in combination with one or more of the other

features, include: adjustable z spring forces and self-centering/zeroing capability; a relatively large x-y gantry on top of joystick for the second control member; a replaceable or resizable thumb loop for the second control member; forearm or wrist stabilization for ambulatory use (potentiometers or optical encoders for X/Y/Z translations, such as for use in drone applications and for integrating with virtual/augmented reality); and a mouse-based implementation for improved CAD object manipulation.

Referring now FIGS. 7 to 11, controllers **700**, **900**, **1000** and **1100** illustrate different, representative embodiments of a single-hand controller having three control members, one of which provides Z-axis secondary control.

The exemplary controllers **700**, **900**, **1000**, **1000**, as well as the controllers shown and described in FIGS. 12-20B, translational inputs for indicating movement along the X, Y and Z axes are preferably received from a user’s the thumb. The thumb is mapped to the brain in greatest detail relative to other parts of the hand. These controllers exploit its greater dexterity to provide input along the X, Y, and Z axes. As the thumb movements are relative to the first control member, which in is these examples are in the form of a joy stick, translation can be decoupled from attitude control of the target control object. Squeezing a third control member located on the first control member allows any one or more of the third, fourth or fifth digits on a user’s hand to support the user’s thumb by applying an upward force or upward motion. The force and movement of the third control member is transmitted or applied to the second control member, and thus to the thumb, through an internal coupling.

These embodiments use an inertial measurement units for measuring displacements of the first control member. However, in alternative, these controllers can be adapted to use external sensors when the controller is mounted to pivot on a base, in which case sensors for sensing roll, pitch and yaw, could be located within the base, or when coupled with a user’s wrist to provide a frame of reference, in which case one or more of the sensors for pitch, roll and yaw can be incorporated into the coupling. Examples of these arrangements are shown in later figures.

In the following description, the first control member may be generally referred to as a “joystick” or “control stick,” as it resembles structurally a portion of previously known types of joysticks, at least where it is gripped, and functions, in some respects, as a might other types of joysticks because it is intended to be gripped by a person’s hand and displaced (translated and/or rotated) or otherwise moved to indicate pitch, roll, and yaw, or motion. However, it should not imply any other structures that might be found in a conventional or other joysticks, and is intend only to signify an elongated structural element that can be gripped.

Referring now to the embodiment of FIGS. 7 and 8A, 8B, and 8C, controller **700** comprises a first control member, which may be referred to a joystick, having a pistol-grip-shaped body **702** formed by a grip portion **703**, where it can be gripped at least two or more of the thumb and third, fourth and fifth fingers of a hand, and a top portion **705** located above where it is gripped. Within the first control member are one or more an integrated inertial measurement units (IMU) **704** (indicated only schematically with dashed lines because the internal structure with the body **702** is not visible in this view) to sense pitch, roll, and yaw control of the first control member. This embodiment includes an optional quick-connection **718** for connecting to a base or other structure. This particular embodiment also incorporates optional buttons, such as trigger **706** (positioned for operation by an index finger) and attitude hold button **708**.

That can be operated by digits on the hand holding the controller or by the user's other hand.

Mounted on top of the first control member, in a position that can be manipulated by a thumb of a person gripping the body **702** of the first control member is mounted is a second control member. The second control member comprises a gantry arrangement **710** for the user to displace fore and aft, and left to right, to generate an input to indicate movement along a y-axis and an x-axis, as well displace up or down to generate an input to indicate movement along a z-axis. In this particular example, the gantry arrangement **710** is mounted on a platform **712** that moves the gantry arrangement up and down. Although different ways of moving the platform (or the gantry **710**), up and down can be employed, this particular example places the gantry **710** at one end of the hinged platform **712**. This allows the gantry arrangement to move up and with respect to the first control member. Pushing down on the gantry displaces the platform **712** downwardly, thereby indicating an input for Z-axis control, while pulling up on the thumb loop (not shown) moves in the opposite direction along the Z-axis.

Part of the Z-axis input arrangement on this controller also includes in this example a third control member **714**. In this example the third control member takes the form of a paddle **716** where the third, fourth and/or fifth finger on a user's hand is located when gripping the first control member around the body **702**, so that the paddle **716** can be selectively squeezed by the user when gripping the controller. The paddle **716** and the platform **712** can be spring loaded so that they are in a zero position to allow for z-axis input to indicate motion in either direction from the zero position. The third control member acts as a secondary Z-axis control. The third control member is linked or coupled with the second control member. The inclusion of a third control member, such as the finger paddle **716**, "balances" the second control member, helping to relieve hitchhiker thumb fatigue in the user and gives finer motor control of user input along the Z-axis (up/down) while allowing also for simultaneous movement of the gantry along the X-axis and Y-axis.

FIGS. **8A** and **8B** show controller **700** with a number of elements removed to more clearly show the cooperative movement of the paddle **716** and platform **712**. In FIG. **8A**, the platform is in a fully depressed position, and in FIG. **8B** the platform **712** is in a fully extended position, the difference corresponding to the full travel of the second control member along a z-axis. In FIG. **8A** the paddle **716** is in a fully extended position with respect to the body **702**, and in FIG. **8B** is fully depressed with respect to the body at **702**.

As shown in FIG. **8C**, which is a perspective view of the controller **700** with one-half of the body removed along with most of its other internal components to reveal one example of a mechanical linkage. In this example, paddle **716** pivots about a pivot axis **720**. A lever **722** connected with the paddle **716**, but opposite of it with respect to the pivot axis **720**, is pivotally connected to a linkage **724**. The other end of linkage **724** is connected to a lever arm **726**, to which platform **712** is connected. Platform **712** pivots about a pin forming an axis **728**. Although not shown in the figure, a spring can be placed in an area indicated by reference number **730** to bias the paddle **716**, and thus the entire linkage, toward a zero or neutral position. Additional springs can also be used to provide balance and to bias the linkage to place the paddle and gantry in the zero positions on the Z-axis.

Turning to FIGS. **9**, **10** and **11**, controllers **900**, **1000**, and **1100** share the same external components that make up the

first and third control members. Each has body **902** that forms the first control member and has, generally speaking, a shape like a joystick or pistol-grip that is intended to be gripped and held in the hand of a user. Each incorporates, like controller **700**, paddles **904** (which pivot from the top, for example) that can be operated by one or more of the fingers of the user that is gripping the first control member. Each also has a programmable button **905**, for which a second finger loop can be substituted.

Similarly, each has a second control member on top of the body. Each second control member includes a platform **906** that moves up and down (by way of a hinge or other mechanism) to provide the Z-axis input. However, each differs in the nature of the second control member. Controller **900** uses a thumb loop **908** mounted to a gantry (TBD #) to provide x and y axis input, while also enabling force to be applied to the z-axis platform **906**. This thumb loop can, preferably, be made in different sizes using an insert (not shown) that can accommodate different sizes. (The thumb loops shown on other controllers in this disclosure can also be made resizable using an insert, if desired.) Controller **1000** of FIG. **10** uses a gantry-type control member **1002**, similar to the one shown on FIG. **7**. And controller **1100** of FIG. **11** uses a trackball **1102** mounted on platform **906** for x and y axis input. Pushing down on the track ball is a z-axis input. The paddle **904** is used to provide input in the other direction along the z-axis.

In each of the controllers **900**, **1000**, **1100**, as well as the hand controllers illustrated in the remaining figures, the second and third control members are coupled by a mechanical linkage disposed within the body of the first control member, like linkage shown in FIG. **8C**. The linkage of FIG. **8C** is, however, intended to be representative of such linkages in general, as different arrangements and numbers of links can be used depending on the particular geometries of the various parts and elements. Although other types of couplings or transmissions could be used to transmit displacement and force between the primary and secondary z-axis control elements in any of the controllers shown and described in FIGS. **7-20B**. These could be other types of types of mechanical transmissions (for example cables), as well as electrical and magnetic transmissions that transmit position and, optionally, force, and combination any two or more of these types. A mechanical linkage, however, has an advantage since it is relatively simple and reliable for providing a direct coupling between the two control members, and since it immediately communicates force and position to provide a comfortable dynamic balance.

Furthermore, all of the controllers shown in FIGS. **7-11**, as well as those shown in FIGS. **12-21**, preferably have re-centering mechanisms for each degree of freedom to give the user a sense of "zero" or null command. When a control member is displaced along one of the degrees of freedom, it preferably generates a tactile feedback, such as force, shake or other haptic signal, of the control members to return them to a position for zero input (the zero position). The mechanisms can consist of a spring that simply reacts with a spring force, or they can be active systems that sense displacement and/or force, and generate a reactive motion, force, other type of vibration haptic feedback, or combination of them.

Although not shown in FIGS. **7-11**, each of the controllers **700**, **900**, **1000** and **1100**, as well as the other controllers shown in the remaining figures, include at least the elements shown in FIG. **1**. For example, it includes sensors (for example, inertial measurement units, potentiometers, optical encoders, or the like) for sensing displacement of the first, second and third control members; a processor for process-

ing signals from the sensors; and a transmitter for transmitting the input signals from the controller, which can be radio frequency, optical or wired (electrical or optical). Such sensors can take the form of inertial measurement units, potentiometers, optical encoders and the like.

In any of the embodiments of controllers described in connection with FIGS. 1 to 21, user feedback can be supplied from the controller by one or more of a number of mechanisms. For example, haptic vibration can provide a subtle vibration feedback. Force feedback can provide feedback in some or all degrees of freedom. Ambient heat and air can provide radiant heating and blowing air. Virtual reality multi-sensory integration can generate precise control within the virtual world. Integrated audio can provide sound feedback from a control target, such as a drone or other target device. The controller can also provide surface heat and cold to give feedback through a heat and cooling sensation. The user interface (UI/UX) can include an integrated touchscreen and visual indicators such as light, flashing colors, and so on.

Turning now to FIGS. 12, 13, and 14, shown are three variations of base structures 1200, 1300 and 1400 to which any one of controllers 700, 900, 1000, and 1100 can be connected. Those shown in any of the other figures, could be adapted as well. In the figures, controller 900 is used as an example, but the other controllers could be adapted for use with any of the bases.

FIG. 12 shows a mobile, two-handed controller system. A two-handed controller provides a consistent, known reference frame (stabilized by the non-dominant hand) even while moving, e.g., walking, skiing, running, driving. For certain types of applications, for example inspection, security and cinematographic drone missions, a hand controller may be mounted on a platform that can be held or otherwise stabilized by the user's other hand. The platform may include secondary controls and, if desired, a display unit. The platform is stabilized by the non-dominant hand. In one example, all 6-DoF inputs can be reacted through the platform. With such an arrangement, this example of a control system facilitates movement through the air like a fighter pilot with intuitive (non-deliberate cognitive) inputs.

A hand controller, such as hand controller 900, is plugged (or alternatively, permanently mounted), into the top surface of the base. A handle or grip 1204 in the shape of, for example, a pistol grip, is provided on the opposite side of the base for the user's other hand to grip while using the hand controller 900. (Other shapes and types of handles can also be envisioned by anyone skilled in the art.) This allows the user's other hand most likely the non-dominant hand, to stabilize the base. The base may, optionally, incorporate additional user interface elements 1206 and 1208, such as keys, buttons, dials, touchpads, trackpads, trackballs balls, etc. Display 1210 is mounted on, or incorporated into, the base in a position where the user can view it. One or more videos or graphical images from the application being controlled can be displayed in real time on the display, such as live video from a drone, or a game. Alternatively, the base may include a mount on which a smartphone or similar device can be placed or mounted. Alternate or optional features include one or a combination of any two or more of the following features. The base can be reconfigurable for either hand with a quick disconnect for the joystick and two mounting points. It can be either asymmetric (as shown) or symmetric in shape, with ample room for secondary controls. It can include a smartphone attachment with tilt capability on its top surface. It may include secondary joystick to allow for pan and tilt control of the drone camera,

and a capacitive deadman switch (or pressure deadman switch). It may also include large display mount and surface area for secondary controls. In an alternative embodiment a grip or handle can be located more midline to the controller, thus reducing some off-axis moments.

FIG. 13 is an example of a base that can be moved to provide another input, in this case it is a mouse 1300 with additional input buttons 1304 and 1306. In this example, a secondary connection point 1308 for a hand controller is provided to accommodate both left and right-handed users. One example would be for navigation through 3-D images on a computer screen, where traditional mouse features would be used to move a cursor in the field of view, and to manipulate drop-down menus, while the controller 900 would be used to reorient and/or move the 3-D object in multiple degrees of freedom of motion.

FIG. 14 shows an example of a wired, fixed base, single handed controller 1400.

Although not required, each of the figures show an example embodiment in which the controller can be quickly connected at its bottom to the base. In each example of a base, the controller is connected to a joystick-like, small lever (1202, 1302 and 1402). This lever could be used to provide pitch, roll and yaw input, with sensors located within the base, but it does not have to be. It can instead (or in addition) be used to center the first control member at a zero position and provide feedback to the user. An RF or wired connection between the controller and the base can be used to communicate signals from sensors within the controller.

FIG. 15 shows an example of an embodiment of a hand controller 1500, like controller 900, that includes an index finger loop 1502 in addition to a thumb loop 1503 that functions as a second control member. This index finger loop can be used to control opening and closing a physical or virtual end effector, say a hand grasp on an object in a virtual world. The design can ergonomically fit within the palm of the hand in very low profile and can be optimized for, virtual/augmented reality or drone flight. The addition of an index finger loop to open and close an end effector, for example, can benefit virtual/augmented reality applications.

Also schematically shown in FIG. 15 is an attachment 1504 for placement on a forearm 1506 of a user. A coupling 1508 between the attachment 1504 and the hand controller 1500 supports the hand controller and allows for use of potentiometers or optical encoders to precisely measure angular displacement of pitch, roll, and yaw of controller 1500 when it is connected to a pivot point 1510 that is in a fixed relation to the forearm attachment 1504, even if removed from a base station. The indexing off of the wrist or forearm allows for this. In one embodiment, the hand controller does not use an IMU to sense one or more of the pitch, roll or yaw, using instead the other types of sensors. Alternately the system can use two or more IMUs and software filtering of the data to measure relative displacement and to command flight control.

Moving any point of reference through physical or virtual space by way of a hand controller requires constant insight into displacement in every degree of freedom being controlled. Stated differently, it is important to know where "zero input" is at all times for movement along x, y, and z directions and yaw for a drone. Other flight regimes, such as virtual and augmented reality, computer gaming and surgical robotics may require as many as six independent degrees of freedom simultaneously (X, Y, Z, pitch, yaw, roll). Moreover, for drone flight and virtual reality and augmented

reality in particular, the ability to be mobile while maintaining precise control of the point of reference (POR) is desirable.

FIGS. 15 to 20B illustrate several, representative embodiments of control systems having two parts: a hand-held controller and a forearm attachment in the form of a brace adapted or configured for mounting to a forearm or wrist of the user that provides a consistent, known reference frame (anchored to a user's wrist) even while the user or the user's arm is moving or accelerating, such as by walking, skiing, running, or driving.

In the examples shown in these figures, the forearm attachment might take any one of a number of forms. For example, it might comprise a brace, wrist wrap (which can be wrapped around a forearm or wrist and fastened using, for example, Velcro), slap-bracelet, or other items that conforms to at least a portion of the forearm. However, it may also comprise a relatively stiff support structure. The forearm attachment may be referred to as a brace, cuff or "gauntlet" because, structurally and/or functionally, it resembles these items in some respects. However, use of these terms should not imply structures beyond what is shown or required for the statement function.

The hand controller and the forearm attachment are connected by a mechanical linkage, strut or support. In one embodiment, it is a passive linkage, that it other embodiments it is not. One type of passive mechanical linkage used in the examples described below is a two-axis gimbal pivot with centering springs and potentiometers to measure displacement. Alternately, cables, double piston mechanisms (compression springs), pneumatic cylinders or passive stiffeners/battens, possibly built into a partial glove, could be used. In the examples, the linkage imparts a force to the user with which the user can sense zero input at least one, or at least two, or in all three axes of rotation on the joystick.

Small inertial measurement units (IMUs) may also be placed within the controller and mounted to the wrist or forearm using the forearm attachment, for example, allowing detection of pure differential (relative) motion between the forearm and the controller. Noisy signals would be managed by oversampling and subsequent decimation with digital+/-adaptive filtering, thereby achieving measurement of relative motion of the hand versus the arm in mechanically noisy environments (while hiking, running or otherwise moving). However, the embodiments that can measure one or more of pitch, roll or yaw may be able to limit the use of an IMU to sensing just one or two rotational inputs, or omit them altogether from the controller.

In an alternative embodiment, an active mechanical feedback can be used to inform the user of displacement in a given axis of rotation might also include vibration haptics and force feedback.

For drone flight, one embodiment involves two gimballed degrees of freedom at the wrist, and two at the thumb: wrist pitch (X or forwards/backwards) and wrist yaw (pivot left/right); thumb/Z paddle (translate up/down) and thumb Y (translate left/right).

Alternately, it is possible to record displacement in roll of the forearm as well, but it requires a gauntlet that extends at least half way up the forearm and perhaps more. A full 6-degrees of freedom control, including measurement forearm roll, isn't necessary for drone flight, although it would be desirable for augmented reality applications. The yaw and Y translation inputs described above might be swapped, at user preference, based on flight testing and personal preference.

The thumb loop/"Z paddle" is preserved while using a "gantry" on top of the joystick to measure intended displacement laterally. Other methods of measuring forearm roll might include EMG detection of forearm muscle electrical potential, a conformal forearm wrap with pressure sensors that pick up differential contours of the forearm as a function of rotation, and differential IMUs or a combination of an IMU and a camera system (wrist vs elbow), showing rotation. The latter solutions would likely require vibration haptics or force feedback to inform the user of the zero position in roll.

One or more of the following features may be incorporated: reconfigurable for either hand; symmetric shape with buttons available from either side; quick don and doff of wrist wrap or disconnect of joystick; smartphone attachment with tilt capability on wrist wrap; secondary joystick at the base of the joystick to allow for (pan)/tilt of the drone camera; secondary joystick retracts/extends from base of joystick like a ball point pen; capacitive Deadman Switch (or Pressure Deadman Switch)—fail safe; a modular joystick that is able to remove and place on tabletop base, operate standalone or on other types of function-specific bases, such as those described above.

Gimbal pivots shown in the drawings contain centering torsion springs and potentiometers. Preferably, couplings or linkages that connect the joystick to that the gimbals are designed to be to be adjustable for different sized users.

A universal smart phone holder may also attached to a bracket mounted to the forearm attachment or brace.

The hand controllers in the following figures comprise six degrees-of-freedom single hand control device, with first control member in the form of joystick (or joystick like device), and second control member for the user's thumb (whether a loop, gantry, track ball, touch pad or other input device) has its Z-axis travel augmented by other third control member configured to be used by one or more non-index fingers of the same hand and that move in conjunction with, and in opposition to, the second control member.

Further features useful in, for example, applications to drone flight or to virtual/augmented reality, can include a forearm brace to allow mobile potentiometer or optical encoder sensing of pitch, roll, and yaw; pan/tilt controls can be integrated into the controller, as can a smart device (smartphone, tablet) holder. A base structure to which the hand controller is attached can also include a second handle (for the non-dominant hand) to allow for mobile potentiometer or optical encoder sensing.

Alternate solutions for yaw precision can include one or more of: induced magnetic field wrist bracelet, differential IMUs, software filtering of the IMU to reduce yaw related noise, reaction wheels (high precision gyro), and inertial (high precision yaw gyro) balanced yaw with potentiometers or optical encoders. Software filtering of IMU data can include dynamic re-zeroing.

The control signals from the controller can be further augmented by additional inputs. For example, a head or body mounted "connect sensor" can be used. This could use a grid-type infrared input or other optically based variations, such as RF directional or omnidirectional tracking. The connect sensors could be head mounted, such as for interactive virtual reality applications, or wrist mounted. Magnetic "dot" tracking can be used for more general body position inputs.

Referring now to FIG. 16, controller 1600 is substantially similar to other hand controllers described in the preceding paragraphs. In this example, it is connected to a forearm

attachment **1602** that includes a video display **1604** and additional user inputs **1606** in the form of buttons and other types of user input. Connection **1608** between the controller **1600** and the forearm attachment **1602** is a relatively stiff linkage that maintains the relative position of controller **1600** with the forearm attachment **1602**, provide a pivot point around which pitch, yaw, and roll can be measured using either internal sensors or external sensors mounted at the end of connection **1608**.

Referring now to FIGS. **17** and **18**, which illustrate an alternate embodiment of a cuff **1700** that acts as a forearm attachment. In this example, hand controller **1702** is schematically represented. It is representative of any of the hand controllers that have been described herein. Any of the hand controllers described herein can be adapted for use in this example. In this example, the controller is connected with a pitch sensor **1706** that is located below the controller and attached to the cuff **1700** with a mechanical link or strut **1708** that it is adjustable as indicated by length adjustment **1710**. The end of the mechanical link **1708** is attached to the forearm attachment using a spherical bearing **1712** to allow for different angles. Like the length adjustment **1710**, it will be tightened down once the user adjust the position of the controller to their satisfaction.

This example contemplates that an IMU is not used in the controller, at least for pitch and yah measurements. Rather, a yaw, roll and pitch sensors are incorporated into the bottom of the hand controller **1702**, or the base **1703** of a mechanical connection or support between the forearm attachment and the controller. Such sensors can take, in one example, the form of gimbal with a potentiometer and a torsion spring to provide feedback from zero position. In this example, pitch sensor is incorporated into the bottom of the controller **1702**, though it could also be incorporated into the base of the link or strut **1708** in which the pitch sensor **1706** is placed. A roll sensor, which is not visible, can be placed in either the base of the linkage **1708**, in which the pitch sensor is placed, or in the bottom or base portion **1704** of the controller **1702**.

Referring now to FIGS. **19A**, **19B**, **19C** and **19D**, illustrated is an embodiment of a control system **1900** with a specific example of a double gimbal link **1902** between a forearm attachment **1904** and a hand controller **1906** (FIG. **19D** only.). The double gimbal link **1902** attaches gimbals **1908** and **1910** placed at ninety degrees to each other to measure, respectively, pitch and yaw. The hand controller is connected to hand controller mount **1912** which acts as a lever arm and is connected to yaw gimbal **1910**. The forearm attachment, which includes a sleeve or brace **1914**, to which a strap may be connected to attach it to the arm, is supported on a lever arm **1916** that is connected to one side of the pitch gimbal **1908**. Note that, in FIG. **19C**. the hand controller mount **1912** that is shown is a variation of the one shown in FIGS. **19A** and **19B**, in that it is adjustable. A phone holder **1918** may be mounted or attached to the arm attachment **1904** so that it can be seen by the user. The phone holder is adjustable in this example so that hold different types and sizes of phones.

Turning now to FIGS. **20A** and **20B**, shown is another example of a control system similar to the one of FIGS. **19A-19D**. In this example, the control system uses a pitch gimbal **2002** and a yaw gimbal **2004**, which measure pitch and yaw, respectively, connected with a bracket **2006**, in a manner similar to that shown in FIGS. **19A-19D**. The pitch gimbal **2002** is mounted to a forearm attachment in the form of a brace **2008** placed near where the wrist joint pivots when gripping and rotating the controller **2010**. The brace is held on by a strap **2012**. The brace, as in the foregoing

embodiments, acts as a stabilizer. The controller **2010** is mounted to an adjustable length lever arm **2014**. In this example, controller **2010**, like other hand controllers in the foregoing embodiments, has a body **2016** that forms a first control member that is graspable by the user that is used to input rotational displacements (two of which are measure by the gimbals), a second control member on top of the body **2016** in the form of a thumb loop **2018** for X, Y, Z input. On the front, near the bottom, of the body is a joy stick **2022**, which can be used as input for camera pan and tilt, for example, or to manipulate tools.

Thus, systems and methods have been described that that include a controller that allows a user to provide rotational and translational commands in six independent degrees of freedom using a single hand. The system and method may be utilized in a wide variety of control scenarios. While a number of control scenarios are discussed below, those examples are not meant to be limiting, and one of ordinary skill in the art will recognize that many control scenarios may benefit from being able to provide rotational and translational movement using a single hand, even if fewer than all control outputs for all six degrees of freedom are required.

In an embodiment, the control systems and methods discussed above may be utilized in a wide variety of medical applications. While a number of medical applications are discussed below, those examples are not meant to be limiting, and one of ordinary skill in the art will recognize that many other medical applications may benefit from being able to provide rotational and translational movement using a single hand. Furthermore, in such embodiments, in addition to the rotational and translational movement provided using first and second control members discussed above, control buttons may be configured for tasks such as, for example, end-effector capture, biopsy, suturing, radiography, photography, and/or a variety of other medical tasks as may be known by one or more of ordinary skill in the art.

For example, the control systems and methods discussed above may provide a control system for performing laparoscopic surgery and/or a method for performing laparoscopic surgery. Conventional laparoscopic surgery is performed using control systems that require both hands of a surgeon to operate the control system. Using the control systems and/or the methods discussed above provide several benefits in performing laparoscopic surgery, including fine dexterous manipulation of one or more surgical instruments, potentially without a straight and rigid path to the end effector.

In another example, the control systems and methods discussed above may provide a control system for performing minimally invasive or natural orifice surgery and/or a method for performing minimally-invasive or natural-orifice surgery. Conventional minimally invasive or natural orifice surgery is performed using control systems that require both hands of a surgeon to operate the control system. Using the control systems and/or the methods discussed above provide several benefits in performing minimally invasive or natural orifice surgery, including fine dexterous manipulation of one or more surgical tools, potentially without a straight and rigid path to the end effector.

In another example, the control systems and methods discussed above may provide a control system for performing prenatal intrauterine surgery and/or a method for performing prenatal surgery. Conventional prenatal surgery is performed using control systems that require both hands of a surgeon to operate the control system in very tight confines. Using the control systems and/or the methods discussed above provide several benefits in performing prenatal

surgery, including fine dexterous manipulation of one or more surgical tools, potentially without a straight and rigid path to the end effector.

For any of the above surgical examples, the control systems and methods discussed above may provide a very stable control system for performing microscopic surgery and/or a method for performing microscopic surgery. Using the control systems and/or the methods discussed above provide several benefits in performing microscopic surgery, including highly accurate camera and end effector pointing.

In another example, the control systems and methods discussed above may provide a control system for performing interventional radiology and/or a method for performing interventional radiology. Conventional interventional radiology is performed using control systems that require both hands of a surgeon to operate the control system. Using the control systems and/or the methods discussed above provide several benefits in performing interventional radiology, including highly accurate navigation through for interventional radiology. In another example, the control systems and methods discussed above may provide a control system for performing interventional cardiology and/or a method for performing interventional cardiology. Conventional interventional cardiology is performed using control systems that require both hands of an interventionist to operate the control system. Using the control systems and/or the methods discussed above provide several benefits in performing interventional cardiology, including highly accurate navigation through the vascular tree using one hand.

In another example, the control systems and methods discussed above may provide a control system including Hansen/Da Vinci robotic control and/or a method for performing Hansen/Da Vinci robotic control. Conventional Hansen/Da Vinci robotic control is performed using control systems that require both hands of a surgeon to operate the control system. Using the control systems and/or the methods discussed above provide several benefits in performing Hansen/Da Vinci robotic control, including fluid, continuous translation and reorientation without shuffling the end effector for longer motions.

In another example, the control systems and methods discussed above may provide a control system for performing 3D- or 4D-image guidance and/or a method for performing 3D- or 4D-image guidance. Conventional 3D- or 4D-image guidance is performed using control systems that require both hands of a surgeon to operate the control system. Using the control systems and/or the methods discussed above provide several benefits in performing 3D- or 4D-image guidance, including fluid, continuous translation and reorientation without shuffling the end effector for longer motions.

In another example, the control systems and methods discussed above may provide a control system for performing endoscopy and/or a method for performing endoscopy. Conventional endoscopy is performed using control systems that require both hands of a surgeon to operate the control system. Using the control systems and/or the methods discussed above provide several benefits in performing endoscopy, including fluid, continuous translation and reorientation without shuffling the end effector for longer motions. This also applies to colonoscopy, cystoscopy, bronchoscopy, and other flexible inspection scopes.

In an embodiment, the control systems and methods discussed above may be utilized in a wide variety of defense or military applications. While a number of defense or military applications are discussed below, those examples are not meant to be limiting, and one of ordinary skill in the

art will recognize that many other defense or military applications may benefit from being able to provide rotational and translational movement using a single hand.

For example, the control systems and methods discussed above may provide a control system for unmanned aerial systems and/or a method for controlling unmanned aerial systems. Conventional unmanned aerial systems are controlled using control systems that require both hands of an operator to operate the control system. Using the control systems and/or the methods discussed above provide several benefits in controlling unmanned aerial systems, including intuitive single-handed, precise, non-cross-coupled motion within the airspace.

In another example, the control systems and methods discussed above may provide a control system for unmanned submersible systems and/or a method for controlling unmanned submersible systems. Conventional unmanned submersible systems are controlled using control systems that require both hands of an operator to operate the control system. Using the control systems and/or the methods discussed above provide several benefits in controlling unmanned submersible systems, including intuitive single-handed, precise, non-cross-coupled motion within the submersible space. As shown in FIG. 20B, the control system can include a smart device (e.g., smartphone, tablet) holder **2024**.

In another example, the control systems and methods discussed above may provide a control system for weapons targeting systems and/or a method for controlling weapons targeting systems. Conventional weapons targeting systems are controlled using control systems that require both hands of an operator to operate the control system. Using the control systems and/or the methods discussed above provide several benefits in controlling weapons targeting systems, including precise, intuitive, single-handed targeting.

In another example, the control systems and methods discussed above may provide a control system for counter-improvised-explosive-device (IED) systems and/or a method for controlling counter-IED systems. Conventional counter-IED systems are controlled using control systems that require both hands of an operator to operate the control system. Using the control systems and/or the methods discussed above provide several benefits in controlling counter-IED systems, including precise, intuitive, single-handed pointing or targeting.

In another example, the control systems and methods discussed above may provide a control system for heavy mechanized vehicles and/or a method for controlling heavy mechanized vehicles. Conventional heavy mechanized vehicles are controlled using control systems that require both hands of an operator to operate the control system. Using the control systems and/or the methods discussed above provide several benefits in controlling heavy mechanized vehicles, including precise, intuitive, single-handed targeting.

In another example, the control systems and methods discussed above may provide a control system for piloted aircraft (e.g., rotary wing aircraft) and/or a method for controlling piloted aircraft. Conventional piloted aircraft are controlled using control systems that require both hands of an operator to operate the control system. Using the control systems and/or the methods discussed above provide several benefits in controlling piloted aircraft, including precise, intuitive, single-handed, non-cross-coupled motion within the airspace for the piloted aircraft.

In another example, the control systems and methods discussed above may provide a control system for spacecraft

rendezvous and docking and/or a method for controlling spacecraft rendezvous and docking. Conventional spacecraft rendezvous and docking is controlled using control systems that require both hands of an operator to operate the control system. Using the control systems and/or the methods discussed above provide several benefits in controlling spacecraft rendezvous and docking, including precise, intuitive, single-handed, non-cross-coupled motion within the space for rendezvous and/or docking.

In another example, the control systems and methods discussed above may provide a control system for air-to-air refueling (e.g., boom control) and/or a method for controlling air-to-air refueling. Conventional air-to-air refueling is controlled using control systems that require both hands of an operator to operate the control system. Using the control systems and/or the methods discussed above provide several benefits in controlling air-to-air refueling, including precise, intuitive, single-handed, non-cross-coupled motion within the airspace for refueling.

In another example, the control systems and methods discussed above may provide a control system for navigation in virtual environments (e.g., operational and simulated warfare) and/or a method for controlling navigation in virtual environments. Conventional navigation in virtual environments is controlled using control systems that require both hands of an operator to operate the control system. Using the control systems and/or the methods discussed above provide several benefits in controlling navigation in virtual environments, including precise, intuitive, single-handed, non-cross-coupled motion within the virtual environment.

In an embodiment, the control systems and methods discussed above may be utilized in a wide variety of industrial applications. While a number of industrial applications are discussed below, those examples are not meant to be limiting, and one of ordinary skill in the art will recognize that many other industrial applications may benefit from being able to provide rotational and translational movement using a single hand.

For example, the control systems and methods discussed above may provide a control system for oil exploration systems (e.g., drills, 3D visualization tools, etc.) and/or a method for controlling oil exploration systems. Conventional oil exploration systems are controlled using control systems that require both hands of an operator to operate the control system. Using the control systems and/or the methods discussed above provide several benefits in controlling oil exploration systems, including precise, intuitive, single-handed, non-cross-coupled motion within the formation.

In another example, the control systems and methods discussed above may provide a control system for overhead cranes and/or a method for controlling overhead cranes. Conventional overhead cranes are controlled using control systems that require both hands of an operator to operate the control system. Using the control systems and/or the methods discussed above provide a benefit in controlling overhead cranes where single axis motion is often limited, by speeding up the process and increasing accuracy.

In another example, the control systems and methods discussed above may provide a control system for cherry pickers or other mobile industrial lifts and/or a method for controlling cherry pickers or other mobile industrial lifts. Conventional cherry pickers or other mobile industrial lifts are often controlled using control systems that require both hands of an operator to operate the control system, and often allow translation (i.e., x, y, and/or z motion) in only one direction at a time. Using the control systems and/or the

methods discussed above provide several benefits in controlling cherry pickers or other mobile industrial lifts, including simultaneous multi-axis motion via a single-handed controller.

In another example, the control systems and methods discussed above may provide a control system for firefighting systems (e.g., water cannons, ladder trucks, etc.) and/or a method for controlling firefighting systems. Conventional firefighting systems are often controlled using control systems that require both hands of an operator to operate the control system, and typically do not allow multi-axis reorientation and translation. Using the control systems and/or the methods discussed above provide several benefits in controlling firefighting systems, including simultaneous multi-axis motion via a single-handed controller.

In another example, the control systems and methods discussed above may provide a control system for nuclear material handling (e.g., gloveboxes, fuel rods in cores, etc.) and/or a method for controlling nuclear material handling. Conventional nuclear material handling systems are controlled using control systems that require both hands of an operator to operate the control system. Using the control systems and/or the methods discussed above provide several benefits in controlling nuclear material handling, including very precise, fluid, single-handed, multi-axis operations with sensitive materials.

In another example, the control systems and methods discussed above may provide a control system for steel manufacturing and other high temperature processes and/or a method for controlling steel manufacturing and other high temperature processes. Conventional steel manufacturing and other high temperature processes are controlled using control systems that require both hands of an operator to operate the control system. Using the control systems and/or the methods discussed above provide several benefits in controlling steel manufacturing and other high temperature processes, including very precise, fluid, single-handed, multi-axis operations with sensitive materials.

In another example, the control systems and methods discussed above may provide a control system for explosives handling (e.g., in mining applications) and/or a method for controlling explosives handling. Conventional explosives handling is controlled using control systems that require both hands of an operator to operate the control system. Using the control systems and/or the methods discussed above provide several benefits in controlling explosives handling, including very precise, fluid, single-handed, multi-axis operations with sensitive materials.

In another example, the control systems and methods discussed above may provide a control system for waste management systems and/or a method for controlling waste management systems. Conventional waste management systems are controlled using control systems that require both hands of an operator to operate the control system. Using the control systems and/or the methods discussed above provide several benefits in controlling waste management systems, including very precise, fluid, single-handed, multi-axis operations with sensitive materials.

In an embodiment, the control systems and methods discussed above may be utilized in a wide variety of consumer applications. While a number of consumer applications are discussed below, those examples are not meant to be limiting, and one of ordinary skill in the art will recognize that many other consumer applications may benefit from being able to provide rotational and translational movement using a single hand.

For example, the control systems and methods discussed above may provide a control system for consumer electronics devices e.g., Nintendo Wii® (Nintendo of America Inc., Redmond, Wash., USA), Nintendo DS®, Microsoft XBox® (Microsoft Corp., Redmond, Wash., USA), Sony Playstation® (Sony Computer Entertainment Inc., Corp., Tokyo, Japan), and other video consoles as may be known by one or more of ordinary skill in the art) and/or a method for controlling consumer electronics devices. Conventional consumer electronics devices are controlled using control systems that require both hands of an operator to operate the control system (e.g., a hand controller and keyboard, two hands on one controller, a Wii® “nunchuck” z-handed I/O device, etc.) Using the control systems and/or the methods discussed above provide several benefits in controlling consumer electronics devices, including the ability to navigate with precision through virtual space with fluidity, precision and speed via an intuitive, single-handed controller.

In another example, the control systems and methods discussed above may provide a control system for computer navigation in 3D and/or a method for controlling computer navigation in 3D. Conventional computer navigation in 3D is controlled using control systems that either require both hands of an operator to operate the control system or do not allow fluid multi-axis motion through space. Using the control systems and/or the methods discussed above provide several benefits in controlling computer navigation in 3D, including very precise, fluid, single-handed, multi-axis operations.

In another example, the control systems and methods discussed above may provide a control system for radio-controlled vehicles and/or a method for controlling radio-controlled vehicles. Conventional radio-controlled vehicles are controlled using control systems that require both hands of an operator to operate the control system. Using the control systems and/or the methods discussed above provide several benefits in controlling radio-controlled vehicles, including intuitive single-handed, precise, non-cross-coupled motion within the airspace for radio-controlled vehicles.

In another example, the control systems and methods discussed above may provide a control system for 3D computer aided drafting (CAD) image manipulation and/or a method for controlling 3D CAD image manipulation. Conventional 3D CAD image manipulation is controlled using control systems that either require both hands of an operator to operate the control system or do not allow fluid multi-axis motion through 3D space. Using the control systems and/or the methods discussed above provide several benefits in controlling 3D CAD image manipulation, including intuitive single-handed, precise, non-cross-coupled motion within the 3D space.

In another example, the control systems and methods discussed above may provide a control system for general aviation and/or a method for controlling general aviation. Conventional general aviation is controlled using control systems that require both hands and feet of an operator to operate the control system. Using the control systems and/or the methods discussed above provide several benefits in controlling general aviation, including intuitive single-handed, precise, non-cross-coupled motion within the airspace for general aviation.

It is understood that variations may be made in the above without departing from the scope of the invention. While specific embodiments have been shown and described, modifications can be made by one skilled in the art without departing from the spirit or teaching of this invention. The

embodiments as described are exemplary only and are not limiting. Many variations and modifications are possible and are within the scope of the invention. Furthermore, one or more elements of the exemplary embodiments may be omitted, combined with, or substituted for, in whole or in part, with one or more elements of one or more of the other exemplary embodiments. Accordingly, the scope of protection is not limited to the embodiments described, but is only limited by the claims that follow, the scope of which shall include all equivalents of the subject matter of the claims.

What is claimed is:

1. A controller, comprising:

a first control member movable with three degrees of freedom and providing in response thereto a first set of up to three independent control inputs, each indicating an amount of displacement of the first control member in one of the three degrees of freedom relative to a null position, wherein the first control member is configured to be gripped by a user's single hand, the first control member including a first inertial motion sensor;

a second control member extending from the first control member that is movable with at least one independent degree of freedom relative to but independently of the first control member and providing in response thereto a second set of at least one independent control inputs indicating an amount of displacement of the second control member in each of the at least one independent degrees of freedom relative to the first control member, where each control inputs of the second set is independent of each of the control input of the first set, wherein the second control member is configured to be manipulated by the a digit of the user's single hand;

a forearm brace with which first control member is coupled; and

a second inertial motion sensor operatively connected to the forearm brace, wherein the first inertial motion sensor and the second inertial motion sensor being configured to provide data representative of relative movement between the first control member and the brace,

wherein at least one of the first set of three independent control inputs is provided in response to the movement of the first control member in at least one of the three degrees of freedom relative to the forearm brace.

2. The controller of claim 1, further comprising a linkage extending from the forearm brace, to which the first control member is coupled in a fixed relationship.

3. The controller of claim 2, wherein the linkage comprises at least two members that articulate about a joint with an axis of rotation that, when the forearm brace is mounted on a user's forearm and the first control member is gripped by the user's hand, extends through the user's wrist, wherein movement of the first control member about the axis of rotation corresponds to one of the three degrees of freedom of the first control member.

4. The controller of claim 3, further comprising a sensor for measuring angular displacement of the joint for generating a signal indicative of the amount of the displacement, wherein a first one of the first set of control inputs that indicates the amount of movement of the first control member in the first one of the three degrees of freedom responds to the measured angular displacement.

5. The controller of claim 1, wherein the first control member has an elongated shape with a portion adapted for being gripped by the user's hand.

6. The controller of claim 5, further comprising a third control member on the portion adapted for being gripped for

being depressed by one or more digits of the user's hand while gripping the first control member, wherein the third control member is movable in conjunction with, and in opposition to, movement of the second control member in the at least one independent degree of freedom.

7. A controller comprising:

a first control member shaped to be grasped by a hand of a user, the controller being displaceable by the user in three degrees of freedom of movement about each of three axes of rotation, the controller having at least two control inputs, each of which indicates an amount of angular displacement of the first control member about a separate one of the three axes of rotation relative to a null position, the first control member including a first inertial motion sensor;

a second control member mounted on the first control member for displacement relative to the first control member in at least one degree of freedom of movement, the second control member being located on the first control member in a position that allows for movement by a thumb or index finger on the user's hand while gripping the first control member; and

a frame configured for removably mounting on a part of a user's arm for serving as a reference for at least one of the three rotational axes, a second inertial motion sensor operatively connected to the frame, and configured to measure relative movement of the frame and the first control member in at least one of the three rotational degrees of freedom of movement of the controller to generate at least one of the at least two control inputs.

8. The controller of claim 7, further comprising a linkage coupling the frame and the first control member for determining movement of the first control member relative to the user's forearm in at least one degree of freedom.

9. The controller of claim 8, wherein the linkage comprises at least two members that articulate about a joint with

an axis of rotation corresponding to one of the three axes of rotation of the first control member and that extends through the user's wrist when the frame is mounted on the user's forearm and the first control member is gripped by the user's hand.

10. The controller of claim 9, further comprising a sensor for measuring angular displacement of the joint for generating a signal indicative of the amount of the displacement of the joint and generating in response thereto one of the at least two control inputs.

11. The controller of claim 9, wherein the linkage further comprises a third member and a second joint having an axis of rotation corresponding to a second one of the three axes of rotation of the first control member, the second joint articulating when a user moves the first control member about the second one of the three axes of rotation.

12. The controller of claim 8, wherein the linkage is adjustable for accommodating different users.

13. The controller of claim 7, wherein the frame comprises a brace configured for attachment to the user's wrist or forearm.

14. The controller of claim 13, wherein the frame comprises a bracket for holding a visual display in view of the user when the frame is mounted on the user's arm and the user is manipulating the controller.

15. The controller of claim 7, wherein the first control member has an elongated shape with a portion adapted for being gripped by a user's hand.

16. The controller of claim 7, further comprising a third control member for being depressed by one or more digits of a user's single hand while gripping the first control member, wherein the third control member is movable in conjunction with, and in opposition to, movement of the second control member in the at least one degree of freedom of movement.

* * * * *