



US010239638B1

(12) **United States Patent**
Cohen et al.

(10) **Patent No.:** **US 10,239,638 B1**
(45) **Date of Patent:** **Mar. 26, 2019**

(54) **HOME STATION FOR UNMANNED AERIAL VEHICLE**

(71) Applicant: **Wing Aviation LLC**, Mountain View, CA (US)

(72) Inventors: **Joanna Cohen**, Mountain View, CA (US); **Parsa Dormiani**, San Mateo, CA (US); **Mathias Samuel Fleck**, Milpitas, CA (US); **James Ryan Burgess**, Redwood City, CA (US); **Sean Mullaney**, Mountain View, CA (US)

(73) Assignee: **Wing Aviation LLC**, Mountain View, CA (US)

(*) Notice: Subject to any disclaimer, the term of this patent is extended or adjusted under 35 U.S.C. 154(b) by 688 days.

(21) Appl. No.: **14/619,673**

(22) Filed: **Feb. 11, 2015**

Related U.S. Application Data

(60) Provisional application No. 61/991,496, filed on May 10, 2014.

(51) **Int. Cl.**
B64F 1/00 (2006.01)
B64F 1/02 (2006.01)
(Continued)

(52) **U.S. Cl.**
CPC **B64F 1/04** (2013.01); **B64C 39/024** (2013.01); **B64F 1/02** (2013.01); **B64F 1/025** (2013.01);
(Continued)

(58) **Field of Classification Search**
CPC **B64F 1/04**; **B64F 1/02**; **B64F 1/025**; **B64C 39/024**; **B64C 2201/088**; **B64C 2201/024**;
(Continued)

(56) **References Cited**

U.S. PATENT DOCUMENTS

4,123,020 A * 10/1978 Korsak B64F 1/00
244/115
6,056,237 A * 5/2000 Woodland B64C 3/40
244/120

(Continued)

FOREIGN PATENT DOCUMENTS

WO 12/064891 A2 5/2012
WO 13/055265 A1 4/2013

OTHER PUBLICATIONS

Lum et al., "Telesurgery Via Unmanned Aerial Vehicle (UAV) with a Field Deployable Surgical Robot", *Medicine Meets Virtual Reality 15*, 2007, 313-315.

(Continued)

Primary Examiner — Richard R. Green

Assistant Examiner — Michael A. Fabula

(74) *Attorney, Agent, or Firm* — McDonnell Boehnen Hulbert & Berghoff LLP

(57) **ABSTRACT**

Described herein are apparatuses that provided various features related to unmanned aerial vehicles (UAVs). An example apparatus may include, among other features, (i) a launch system for a UAV, (ii) a landing feature that is arranged on the apparatus so as to receive the UAV when the UAV returns from a flight, and (iii) a mechanical battery-replacement system that is configured to (a) remove a first battery from the UAV, and (b) after removal of the first battery, install a second battery in the UAV.

17 Claims, 11 Drawing Sheets

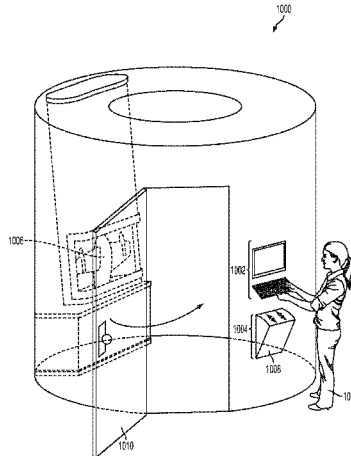
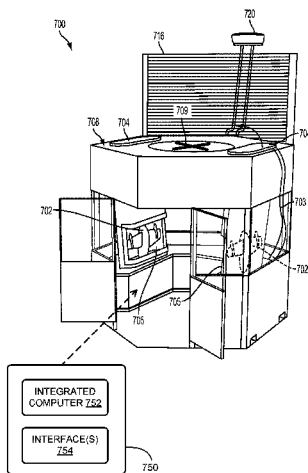

(51)	Int. Cl.		9,505,493 B2 *	11/2016	Borko	B64C 39/024
	B64F 1/04	(2006.01)	9,527,605 B1 *	12/2016	Gentry	B64F 1/12
	B64F 1/18	(2006.01)	9,545,852 B2 *	1/2017	Streett	B64C 39/024
	B64C 39/02	(2006.01)	9,561,871 B2 *	2/2017	Sugumaran	B64C 25/32
(52)	U.S. Cl.		9,714,012 B1 *	7/2017	Hoareau	B60S 5/06
	CPC	B64F 1/18 (2013.01); B64C 2201/022	9,718,564 B1 *	8/2017	Beckman	G06Q 10/0832
		(2013.01); B64C 2201/024 (2013.01); B64C	9,764,836 B1 *	9/2017	Elzinga	B64C 39/024
		2201/025 (2013.01); B64C 2201/088	9,777,502 B2 *	10/2017	Curlander	E04H 14/00
		(2013.01); B64C 2201/104 (2013.01); B64C	9,959,773 B2 *	5/2018	Raptopoulos	G08G 5/0069
		2201/108 (2013.01); B64C 2201/128	2005/0051667 A1 *	3/2005	Arlton	B64C 27/10
		(2013.01); B64C 2201/141 (2013.01); B64C				244/17.11
		2201/145 (2013.01); B64C 2201/146	2005/0151014 A1 *	7/2005	McGeer	B64C 25/68
		(2013.01); B64C 2201/182 (2013.01)				244/120
(58)	Field of Classification Search		2005/0230536 A1 *	10/2005	Dennis	B64C 39/024
	CPC	B64C 2201/182; B64C 2201/108; B64C	2006/0249622 A1 *	11/2006	Steele	B64F 1/04
		2201/128; B64C 2201/104				244/115
		See application file for complete search history.	2007/0049251 A1	3/2007	Mock et al.	
			2008/0085732 A1	4/2008	Mizuide et al.	
			2009/0212157 A1 *	8/2009	Arlton	B64C 27/10
(56)	References Cited		2009/0242693 A1 *	10/2009	Urnes, Sr.	B63B 35/50
	U.S. PATENT DOCUMENTS					244/63
	6,567,044 B2	5/2003 Carroll	2009/0294584 A1 *	12/2009	Lovell	B63B 27/10
	6,817,573 B2	11/2004 Harrison et al.				244/110 F
	6,874,729 B1 *	4/2005 McDonnell	2009/0314883 A1 *	12/2009	Arlton	B64C 39/024
		B64C 25/68				244/63
	6,965,816 B2	11/2005 Walker	2010/0084513 A1	4/2010	Garipey et al.	
	7,089,843 B2 *	8/2006 Miller	2010/0256839 A1	10/2010	Fitzpatrick	
		F41A 23/42	2010/0280699 A1	11/2010	Bageshwar et al.	
		89/1.806	2011/0084162 A1 *	4/2011	Goossen	B64C 39/024
	7,175,135 B2 *	2/2007 Dennis				244/12.1
		B64C 25/68	2011/0106294 A1 *	5/2011	Bebbington	B60L 11/1822
		244/110 C				700/215
	7,410,124 B2 *	8/2008 Miller	2011/0128372 A1	6/2011	Malecki et al.	
		B64C 39/024	2011/0130636 A1	6/2011	Daniel et al.	
		124/65	2011/0168838 A1 *	7/2011	Hornback	B64C 39/028
	7,472,866 B2 *	1/2009 Heaston				244/63
		B63G 8/28	2011/0267241 A1	11/2011	Grimm et al.	
		244/63	2011/0281679 A1	11/2011	Larrabee et al.	
	7,574,193 B2	8/2009 Hulkkonen et al.	2011/0315806 A1	12/2011	Piasecki et al.	
	7,665,691 B2 *	2/2010 Hanzlick	2012/0080556 A1 *	4/2012	Root, Jr.	B64F 1/02
		B64F 1/10				244/63
	7,813,888 B2	10/2010 Vian et al.	2012/0152654 A1	6/2012	Marcus	
	7,877,785 B2	1/2011 Selignan	2013/0081245 A1 *	4/2013	Vavrina	B60L 11/1822
	8,028,952 B2 *	10/2011 Urnes, Sr.				29/402.08
		B63B 35/50	2014/0022051 A1 *	1/2014	Levien	A61M 5/20
		114/261				340/5.2
	8,164,300 B2 *	4/2012 Agassi	2014/0022055 A1 *	1/2014	Levien	A61M 5/20
		B60K 1/04				340/5.64
		307/10.1	2014/0025229 A1 *	1/2014	Levien	A61M 5/20
	8,205,820 B2 *	6/2012 Goossen				701/2
		B64C 37/00	2014/0025230 A1 *	1/2014	Levien	A61M 5/20
		244/110 E				701/2
	8,276,844 B2 *	10/2012 Kariv	2014/0032034 A1 *	1/2014	Raptopoulos	G08G 5/0069
		B64F 1/02				701/25
		244/110 C	2014/0067159 A1 *	3/2014	Levien	A61M 5/20
	8,439,301 B1 *	5/2013 Lussier				701/2
		B64F 1/02	2014/0067160 A1 *	3/2014	Levien	A61M 5/20
		244/63				701/2
	8,511,606 B1 *	8/2013 Lutke	2014/0067167 A1 *	3/2014	Levien	A61M 5/20
		B64C 39/028				701/3
		244/100 R	2015/0266575 A1 *	9/2015	Borko	B64C 39/024
	8,774,982 B2 *	7/2014 Oakley				701/3
		B64C 27/08	2016/0033966 A1 *	2/2016	Farris	G01C 21/00
		244/17.23				701/15
	8,880,241 B2 *	11/2014 Mohamadi	2016/0039540 A1 *	2/2016	Wang	B64F 1/36
		B64C 19/00				244/114 R
		244/190	2016/0140496 A1 *	5/2016	Simms	G06Q 10/0835
	8,909,391 B1 *	12/2014 Peeters				705/337
		G05D 1/0027	2016/0163204 A1 *	6/2016	Raptopoulos	G08G 5/0069
		701/2				701/3
	8,978,534 B2 *	3/2015 Jacq	2016/0229299 A1 *	8/2016	Streett	B64C 39/024
		F41A 23/20				2016/0236582 A1 *
		89/1.11				8/2016 Wang
	9,056,676 B1 *	6/2015 Wang				B64F 1/36
	9,061,102 B2 *	6/2015 Levien				
	9,139,310 B1 *	9/2015 Wang				
	9,254,363 B2 *	2/2016 Levien				
	9,284,062 B2 *	3/2016 Wang				
	9,346,560 B2 *	5/2016 Wang				
	9,421,869 B1 *	8/2016 Ananthanarayanan				
		B60L 5/005				
	9,429,953 B1 *	8/2016 Miller				
	9,440,545 B2 *	9/2016 Wang				
	9,448,562 B1 *	9/2016 Sirang				
	9,481,475 B2 *	11/2016 Campillo				
	9,499,265 B2 *	11/2016 Sanz				

(56)

References Cited

U.S. PATENT DOCUMENTS

2016/0257423 A1* 9/2016 Martin B64F 1/00
2016/0364989 A1* 12/2016 Speasl G08G 5/0034
2016/0375779 A1* 12/2016 Wang B64F 1/36
701/2

OTHER PUBLICATIONS

Nguyen et al., "Situation Identification by Unmanned Aerial Vehicle",
Institute of Mathematics, 2001, 49-56.

Bone et al., "Unmanned Aerial Vehicles: Background and Issues for
Congress", Report for Congress Congressional Research Service,
2003, 1-53.

* cited by examiner

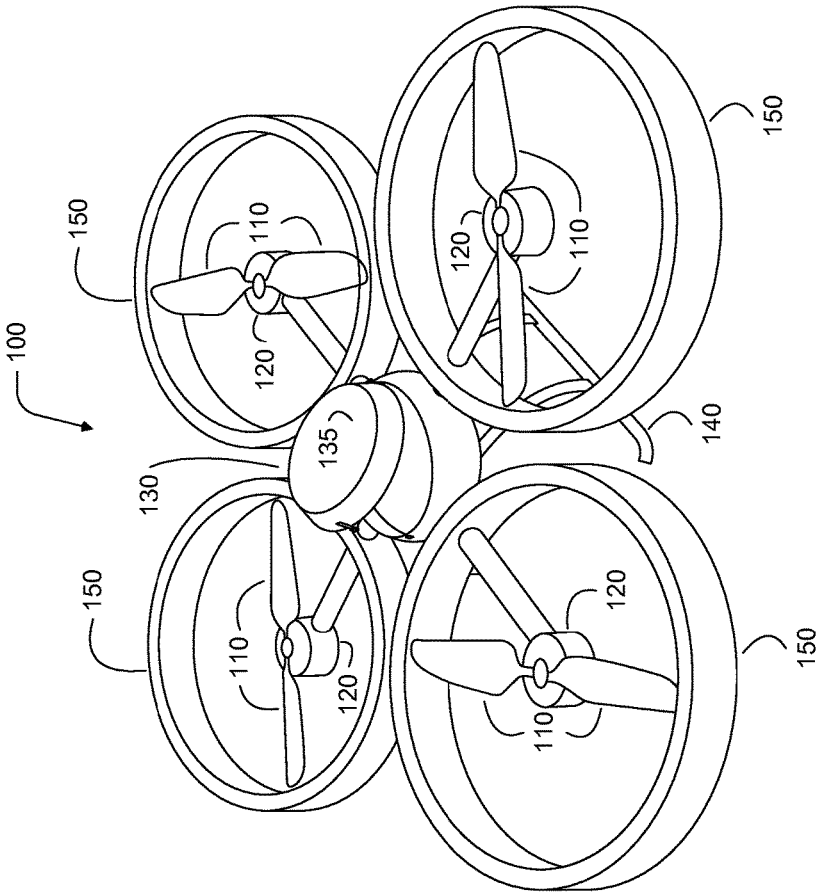

FIG. 1

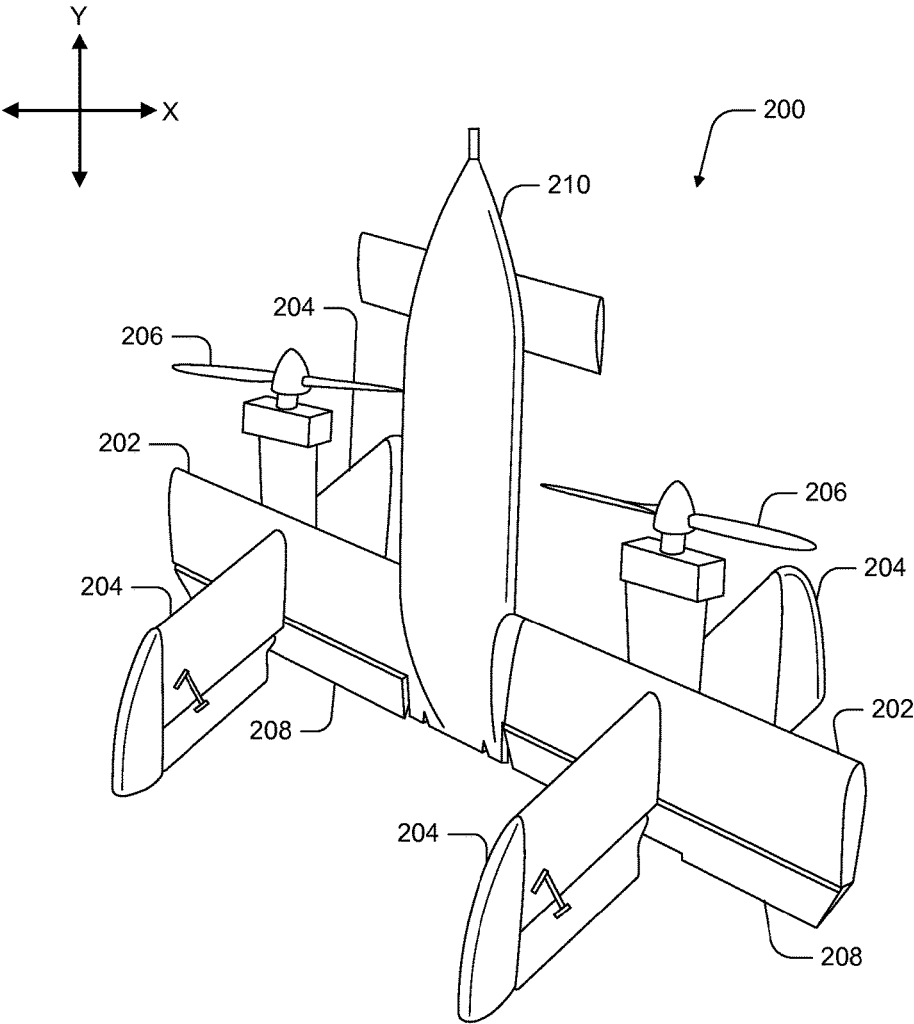

FIG. 2

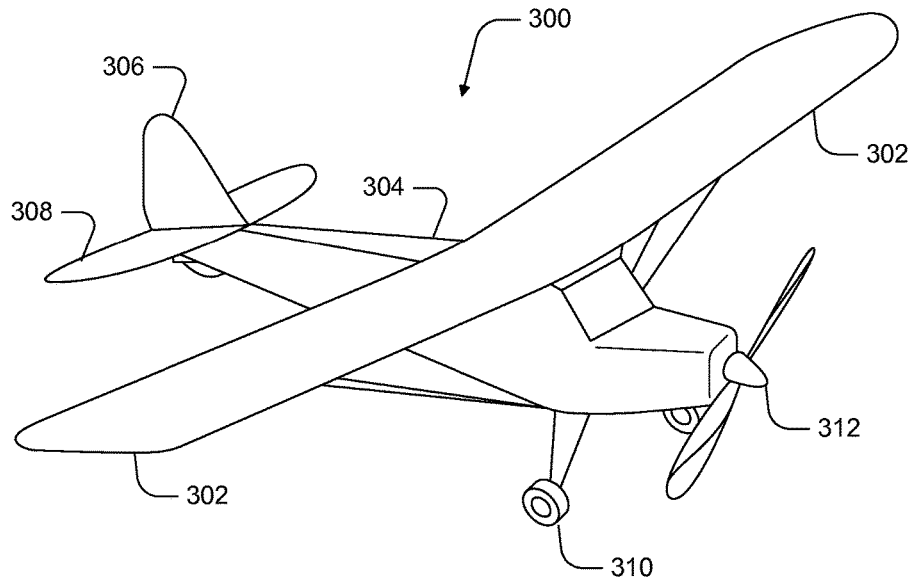

FIG. 3

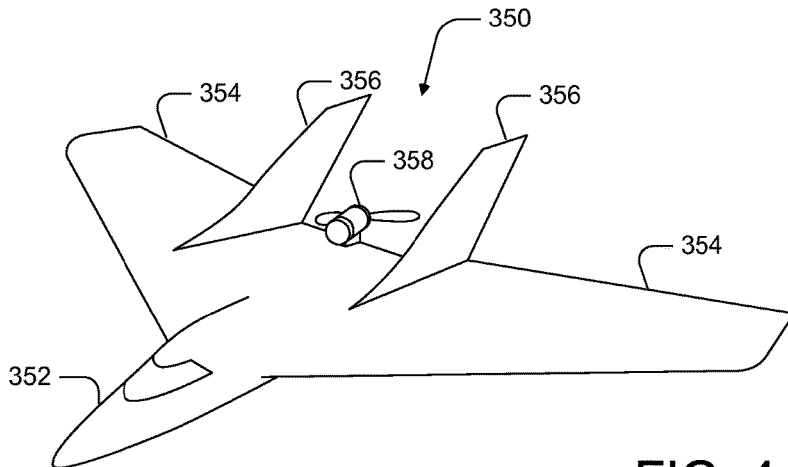
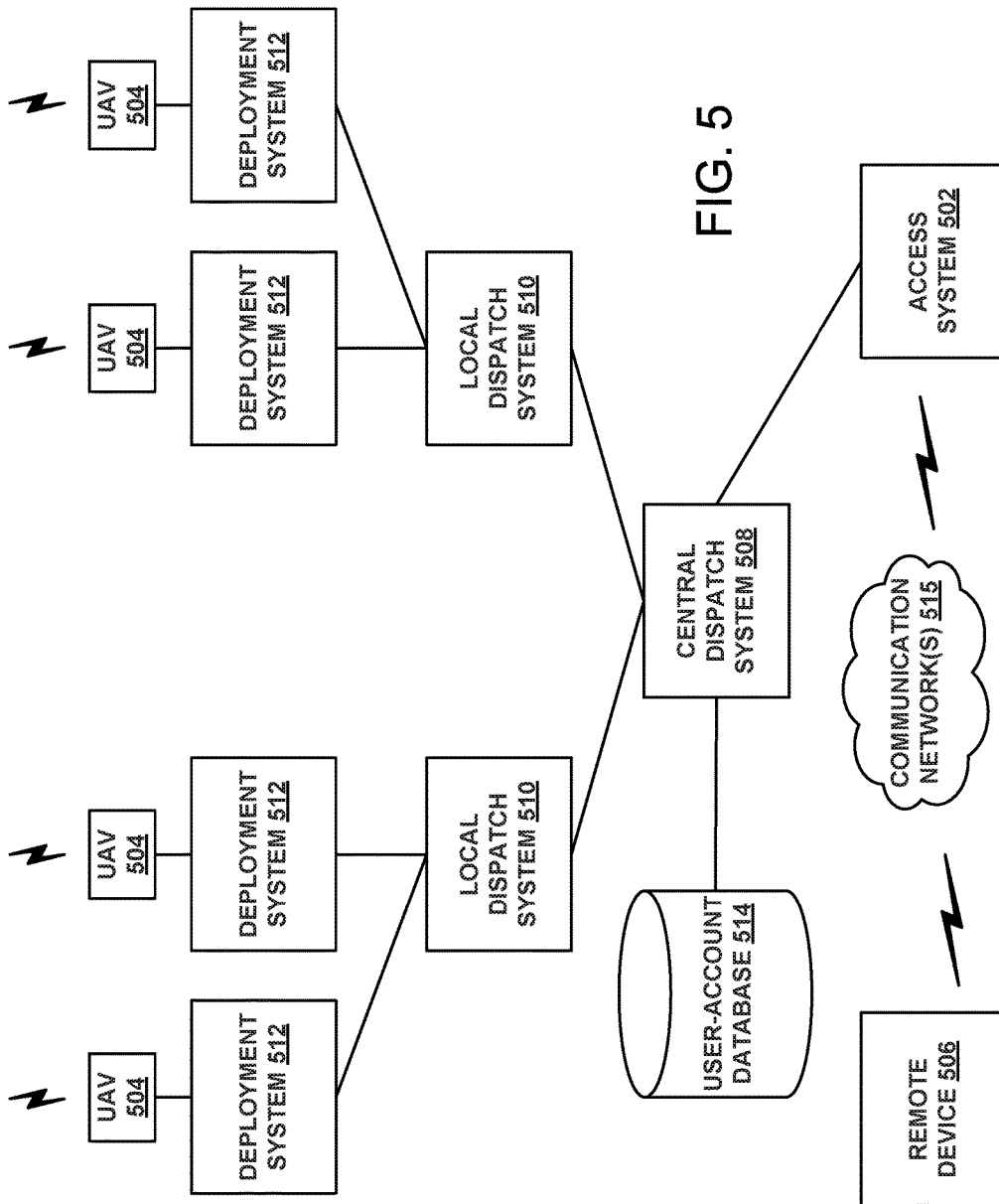

FIG. 4



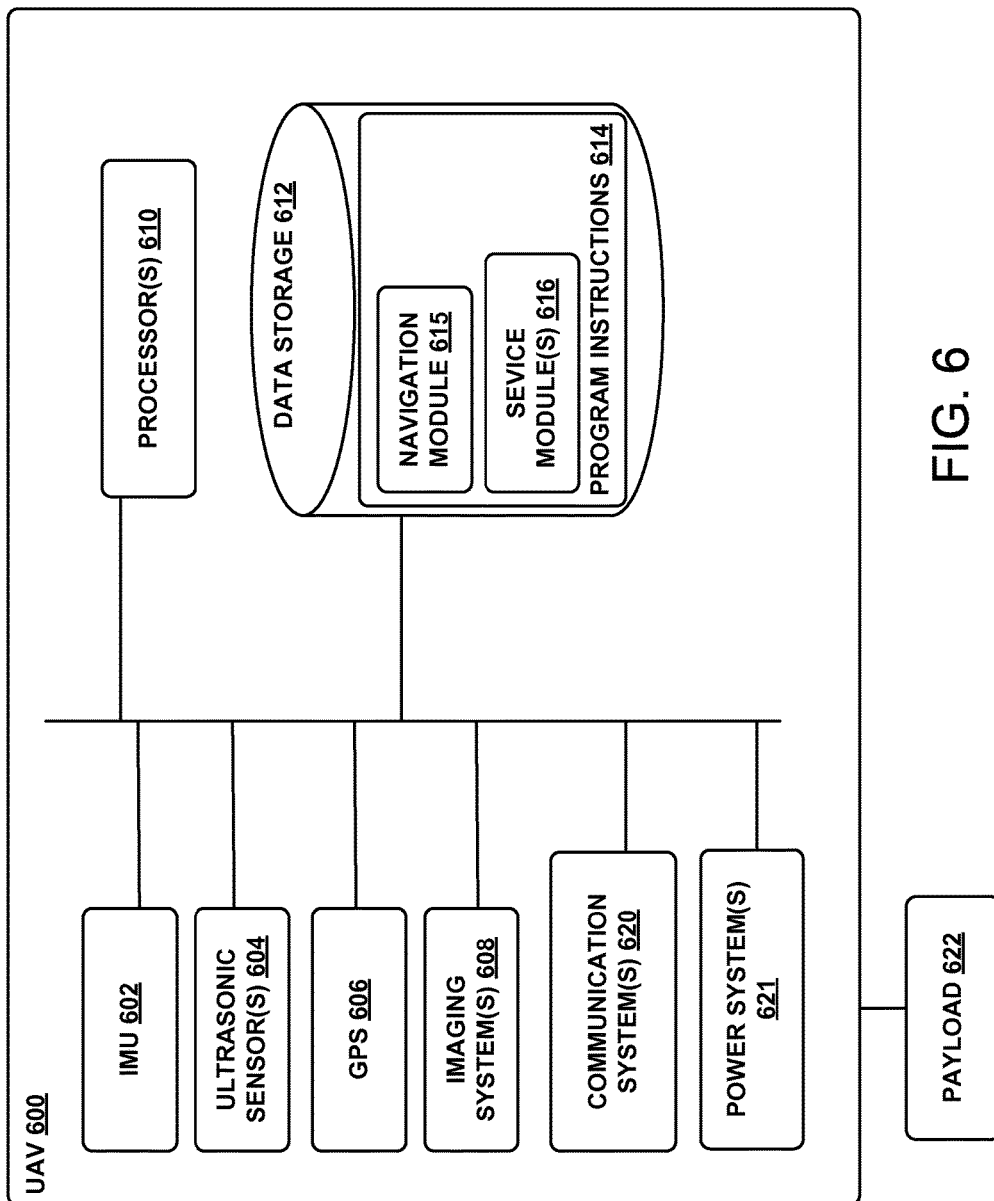
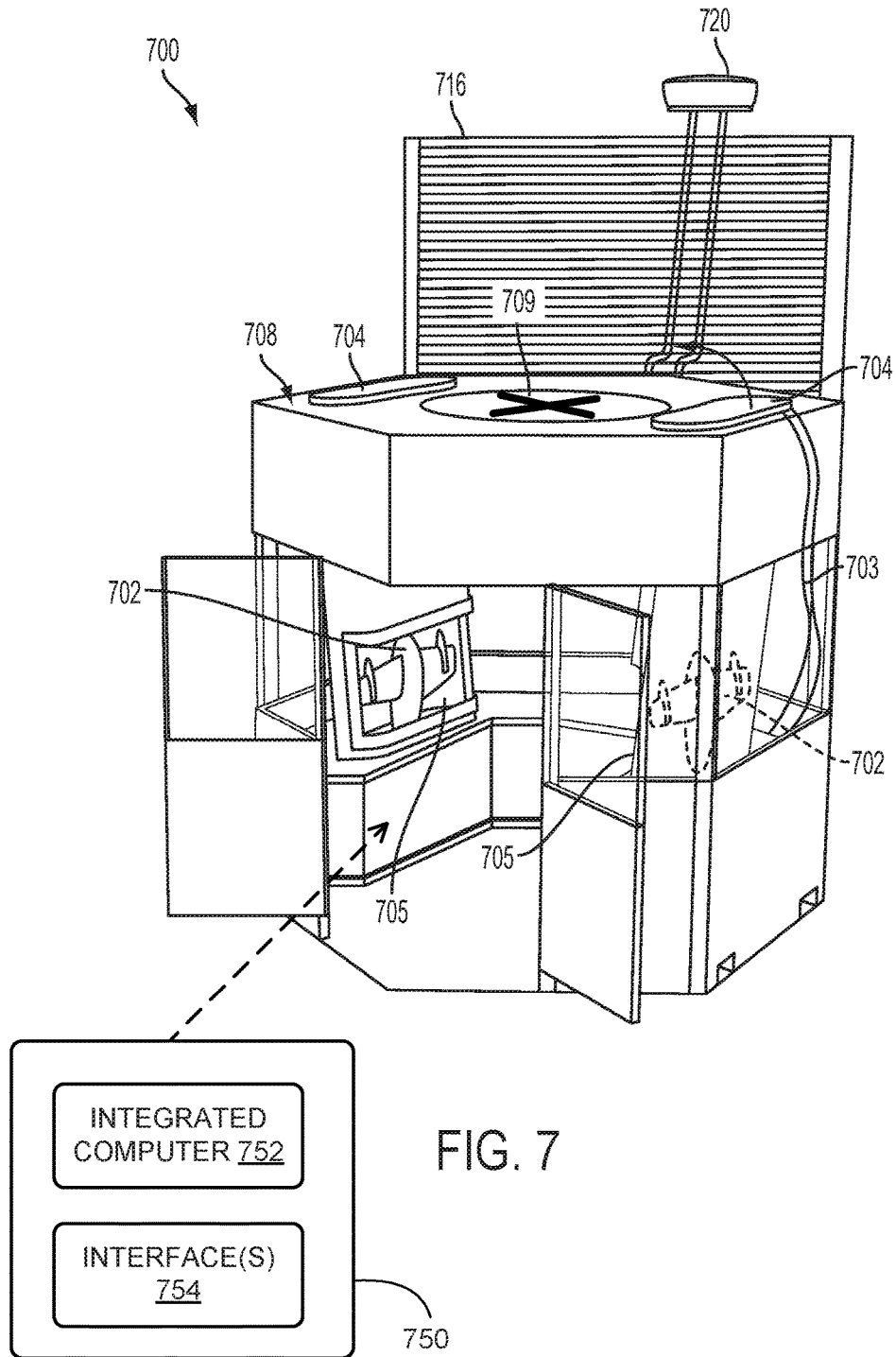

FIG. 6



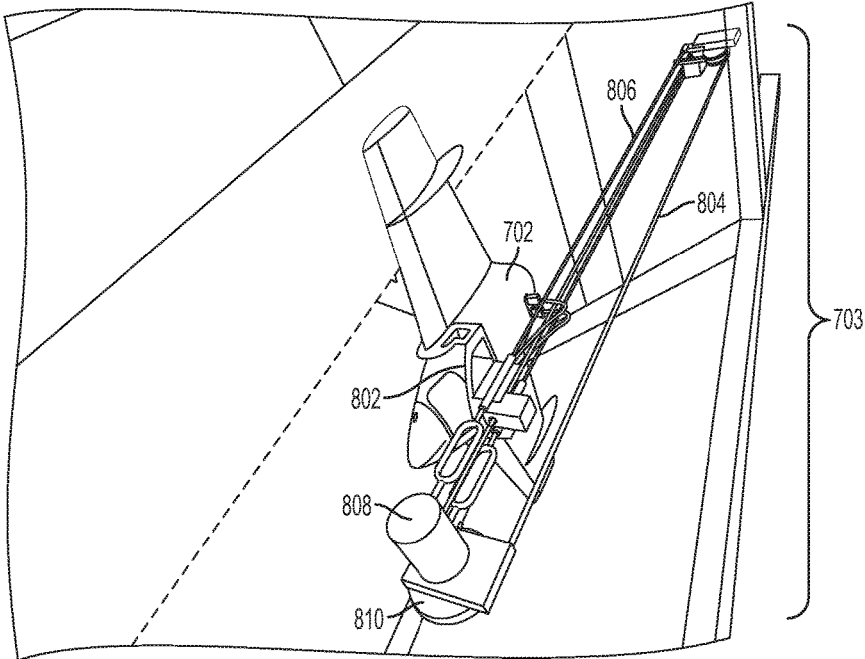

FIG. 8A

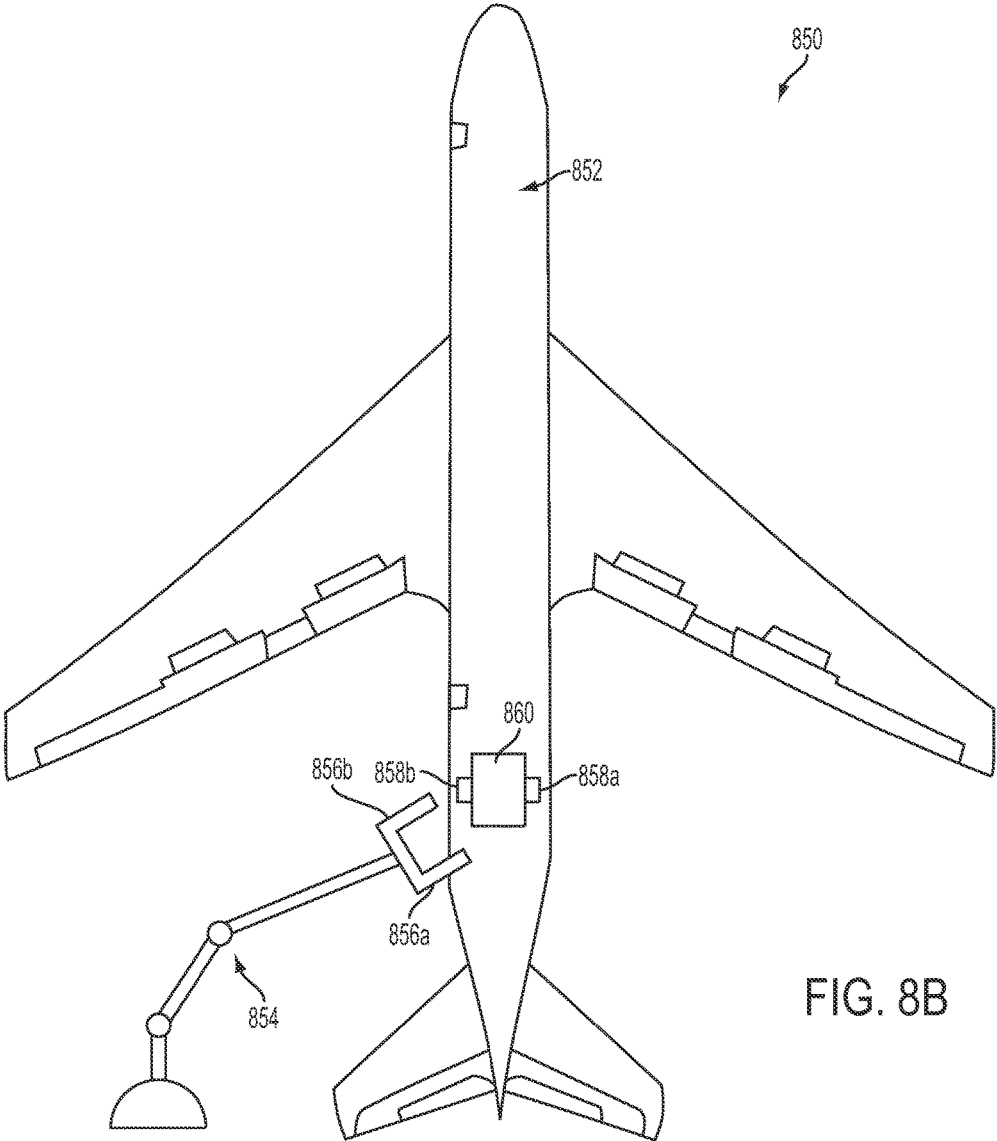

FIG. 8B

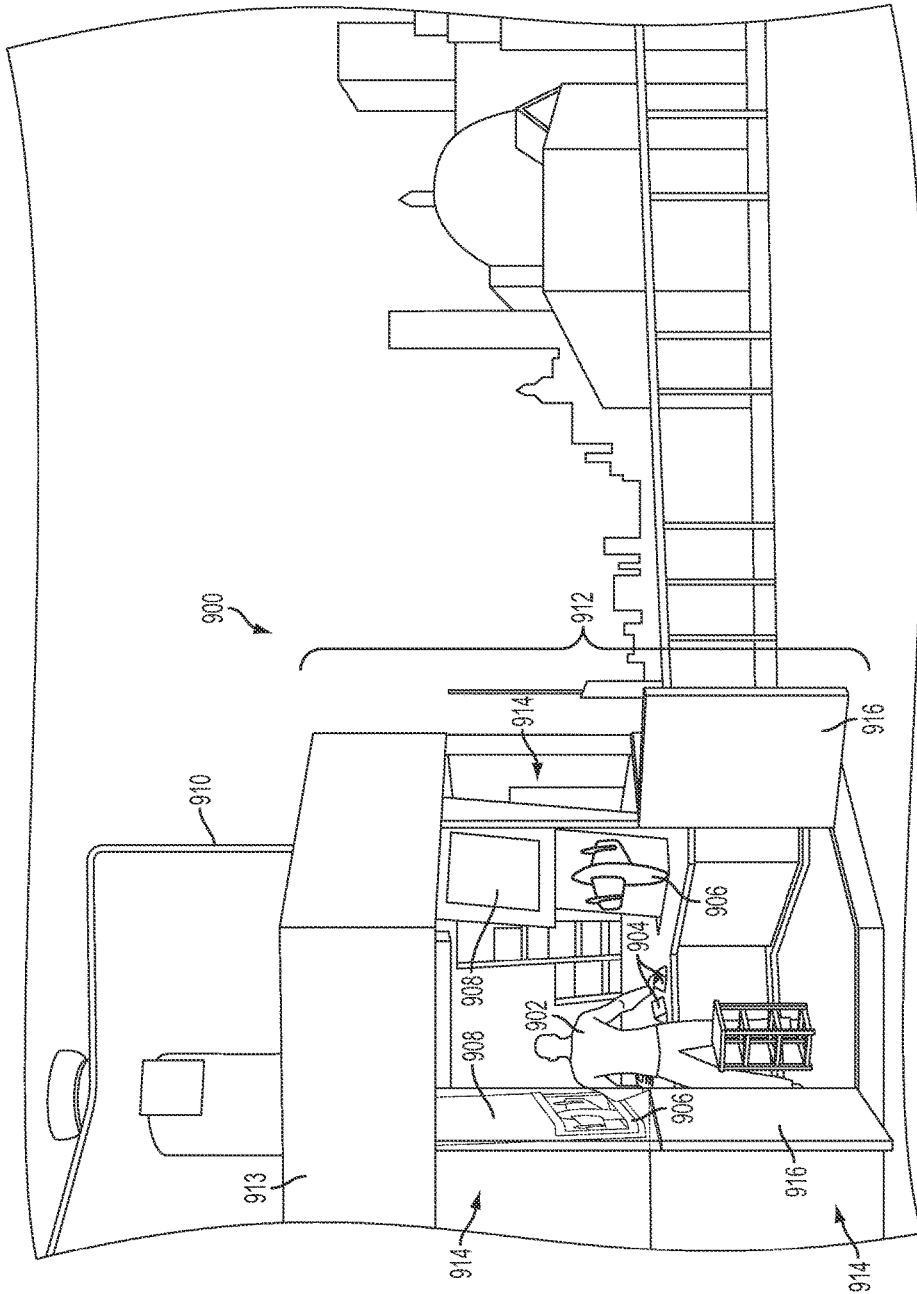

FIG. 9

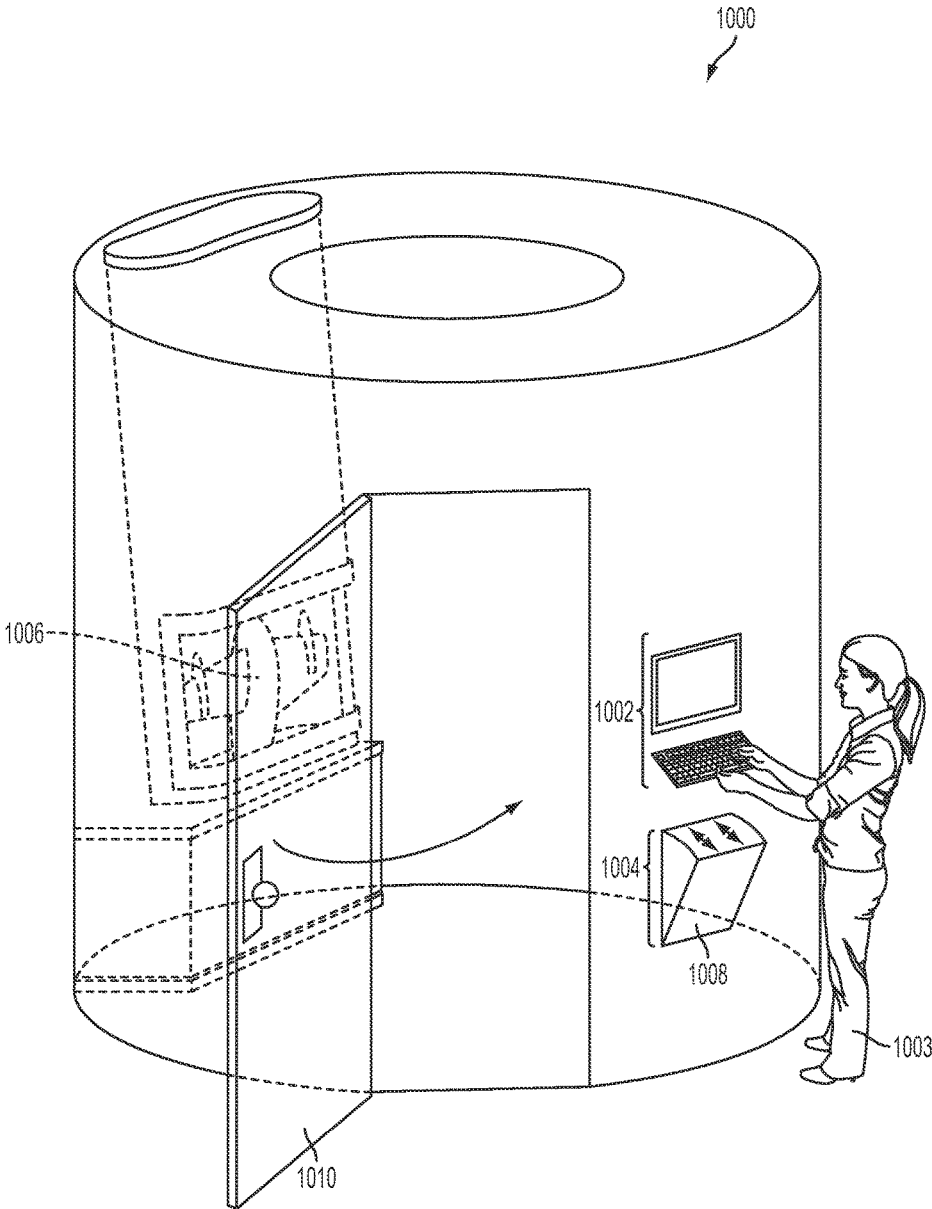

FIG. 10A

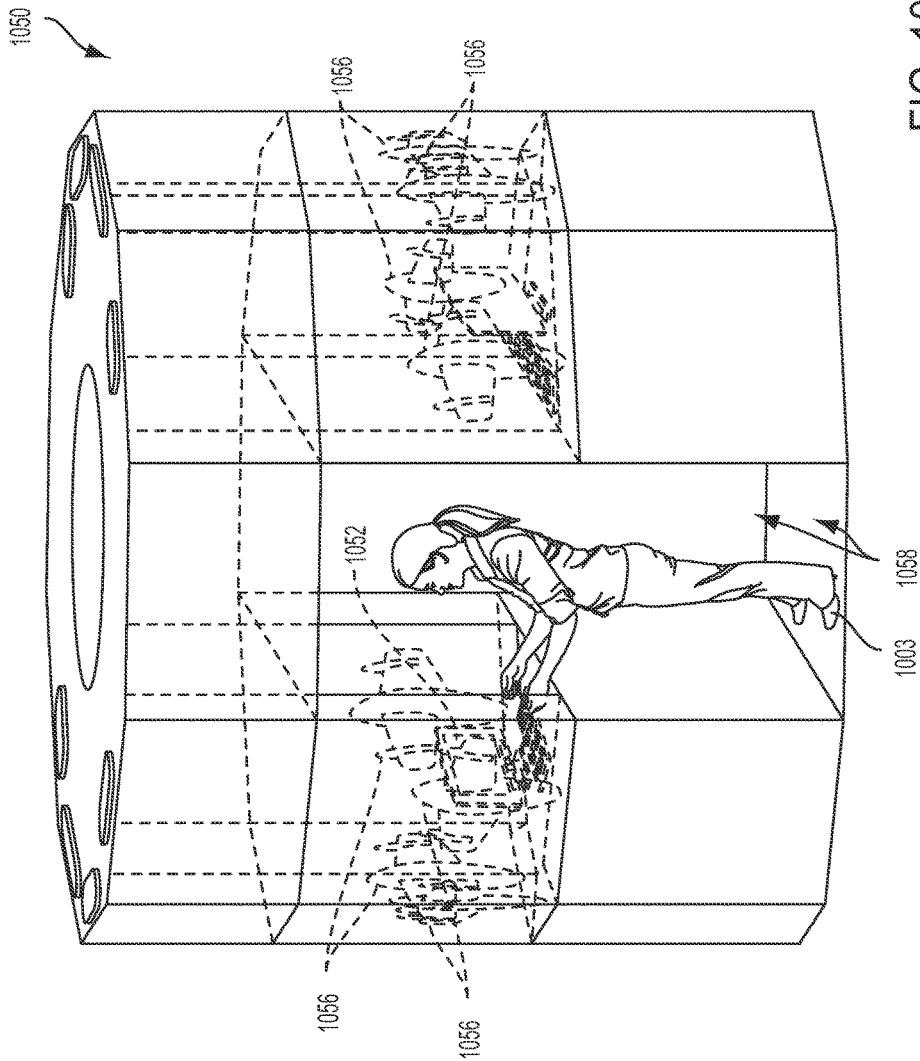

FIG. 10B

HOME STATION FOR UNMANNED AERIAL VEHICLE

CROSS REFERENCE TO RELATED APPLICATION

This application claims priority to U.S. Provisional Application No. 61/991,496, filed on May 10, 2014, the contents of which are incorporated by reference herein for all purposes.

BACKGROUND

An unmanned vehicle, which may also be referred to as an autonomous vehicle, is a vehicle capable of travel without a physically-present human operator. An unmanned vehicle may operate in a remote-control mode, in an autonomous mode, or in a partially autonomous mode.

When an unmanned vehicle operates in a remote-control mode, a pilot or driver that is at a remote location can control the unmanned vehicle via commands that are sent to the unmanned vehicle via a wireless link. When the unmanned vehicle operates in autonomous mode, the unmanned vehicle typically moves based on pre-programmed navigation waypoints, dynamic automation systems, or a combination of these. Further, some unmanned vehicles can operate in both a remote-control mode and an autonomous mode, and in some instances may do so simultaneously. For instance, a remote pilot or driver may wish to leave navigation to an autonomous system while manually performing another task, such as operating a mechanical system for picking up objects, as an example.

Various types of unmanned vehicles exist for various different environments. For instance, unmanned vehicles exist for operation in the air, on the ground, underwater, and in space. Examples include quad-copters and tail-sitter UAVs, among others. Unmanned vehicles also exist for hybrid operations in which multi-environment operation is possible. Examples of hybrid unmanned vehicles include an amphibious craft that is capable of operation on land as well as on water or a floatplane that is capable of landing on water as well as on land. Other examples are also possible.

SUMMARY

Take-off, landing, and maintenance procedures for unmanned aerial vehicles (UAVs) have not been standardized to any significant degree. As such, existing unmanned aerial vehicles (UAVs) typically require a properly-trained human operator to perform certain tasks in order to for a UAV to take off (e.g., launch). For example, before take off, a human operator may be required to retrieve the UAV, position it at a take-off location, and orient the UAV in a manner that facilitates state estimation. A human operator may also be required to perform certain tasks after a UAV lands. For example, post-landing tasks may include discharge of used batteries and/or installation of new, fully-charged, batteries, and/or maintenance and diagnostics tasks to ensure that the UAV will function properly on its next flight, among other possibilities. Further, safety precautions and procedures are typically implemented by individual human operators. Thus, human error can result in an accident when a human operator is performing tasks such as those described above.

Example embodiments may take the form of or otherwise relate to a home station for launching and landing a UAV. Such a home station may also be referred to herein as a

“UAV nest,” or simply as a “nest.” A UAV nest may include features that facilitate launching and landing a UAV. Further, a UAV nest in accordance with an example embodiment may include features that help to automate pre-takeoff and post-landing tasks, and/or to standardize and simplify such task for a human operator, where a human operator is still required. Yet further, a nest may provide safety features that protect a human operator and/or safeguard against human error during pre-takeoff and post-landing tasks. In addition, a network of such nests may help operators to automate high-volume UAV mission execution with less technical knowledge, setup, and/or human intervention than was previously required.

In one aspect, an apparatus includes: (i) a launch system for an unmanned aerial vehicle (UAV); (ii) a landing feature that is arranged on the apparatus so as to receive the UAV when the UAV returns from a flight; and (iii) a mechanical battery-replacement system that is configured to (a) remove a first battery from the UAV, and (b) after removal of the first battery, install a second battery in the UAV.

In another aspect, the apparatus includes: (i) a launch system for an unmanned aerial vehicle (UAV); (ii) a landing feature that is arranged on the apparatus so as to receive the UAV when the UAV returns from a flight; (iii) a frame structure that comprises a roof and one or more side sections, wherein the one or more side sections and the roof form a human-sized chamber that is at least partially enclosed; and (iv) one or more human-operable control interfaces that are physically accessible from within the human-sized chamber, wherein the one or more human-operable control interfaces are operable to control at least the launch system, wherein at least a portion of the launch system is disposed within the human-sized chamber such that the UAV can be loaded onto the launch system from within the human-sized chamber, and wherein the landing feature is at least partially disposed on the roof.

These as well as other aspects, advantages, and alternatives will become apparent to those of ordinary skill in the art by reading the following detailed description with reference where appropriate to the accompanying drawings. Further, it should be understood that the description provided in this summary section and elsewhere in this document is intended to illustrate the claimed subject matter by way of example and not by way of limitation.

BRIEF DESCRIPTION OF THE DRAWINGS

FIGS. 1, 2, 3, and 4 are simplified illustrations of unmanned aerial vehicles, according to example embodiments.

FIG. 5 is a simplified block diagram illustrating a UAV system, according to an example embodiment.

FIG. 6 is a simplified block diagram illustrating components of an unmanned aerial vehicle, according to an example embodiment.

FIG. 7 is an illustration of a nest, according to an example embodiment.

FIG. 8A shows a launch system, according to an example embodiment.

FIG. 8B shows a battery-replacement system, according to an example embodiment.

FIG. 9 is a simplified illustration of a human operator standing inside of an example nest.

FIGS. 10A and 10B are simplified illustrations of nests configured as self-service kiosks, according to example embodiments.

The following detailed description describes various features and functions of the disclosure with reference to the accompanying Figures. In the Figures, similar symbols typically identify similar components, unless context dictates otherwise. The illustrative apparatus described herein are not meant to be limiting. It will be readily understood that certain aspects of the disclosure can be arranged and combined in a wide variety of different configurations, all of which are contemplated herein.

I. OVERVIEW

Example embodiments may take the form of or otherwise relate to a home station for launching and landing a UAV. Such a home station may also be referred to herein as a “UAV nest,” or simply as a “nest.” A UAV nest may include features that facilitate launching and landing a UAV. Further, an example UAV nest may include features that help to automate pre-takeoff and post-landing tasks, and/or to standardize and simplify such task for a human operator, where a human operator is still required. Yet further, a nest may provide safety features that protect a human operator and/or safeguard against human error during pre-takeoff and post-landing tasks. In addition, a network of such nests may help operators to automate high-volume UAV mission execution with less technical knowledge, setup, and/or human intervention than was previously required.

II. ILLUSTRATIVE UNMANNED VEHICLES

Herein, the terms “unmanned aerial vehicle” and “UAV” refer to any autonomous or semi-autonomous vehicle that is capable of performing some functions without a physically present human pilot. Examples of flight-related functions may include, but are not limited to, sensing its environment or operating in the air without a need for input from an operator, among others.

A UAV may be autonomous or semi-autonomous. For instance, some functions may be controlled by a remote human operator, while other functions are carried out autonomously. Further, a UAV may be configured to allow a remote operator to take over functions that can otherwise be controlled autonomously by the UAV. Yet further, a given type of function may be controlled remotely at one level of abstraction and performed autonomously at another level of abstraction. For example, a remote operator could control high level navigation decisions for a UAV, such as by specifying that the UAV should travel from one location to another (e.g., from the city hall in Palo Alto to the city hall in San Francisco), while the UAV’s navigation system autonomously controls more fine-grained navigation decisions, such as the specific route to take between the two locations, specific flight controls to achieve the route and avoid obstacles while navigating the route, and so on. Other examples are also possible.

A UAV can be of various forms. For example, a UAV may take the form of a rotorcraft such as a helicopter or multicopter, a fixed-wing aircraft, a jet aircraft, a ducted fan aircraft, a lighter-than-air dirigible such as a blimp or steerable balloon, a tail-sitter aircraft, a glider aircraft, and/or an ornithopter, among other possibilities. Further, the terms “drone”, “unmanned aerial vehicle system” (“UAVS”), or “unmanned aerial system” (“UAS”) may also be used to refer to a UAV.

FIG. 1 is a simplified illustration of a UAV, according to an example embodiment. In particular, FIG. 1 shows an example of a rotorcraft **100** that is commonly referred to as a multicopter. Multicopter **100** may also be referred to as a quadcopter, as it includes four rotors **110**. It should be understood that example embodiments may involve rotorcraft with more or less rotors than multicopter **100**. For example, a helicopter typically has two rotors. Other examples with three or more rotors are possible as well. Herein, the term “multicopter” refers to any rotorcraft having more than two rotors, and the term “helicopter” refers to rotorcraft having two rotors.

Referring to multicopter **100** in greater detail, the four rotors **110** provide propulsion and maneuverability for the multicopter **100**. More specifically, each rotor **110** includes blades that are attached to a motor **120**. Configured as such the rotors may allow the multicopter **100** to take off and land vertically, to maneuver in any direction, and/or to hover. Furthermore, the pitch of the blades may be adjusted as a group and/or differentially, and may allow a multicopter **110** to perform three-dimensional aerial maneuvers such as an upside-down hover, a continuous tail-down “tic-toc,” loops, loops with pirouettes, stall-turns with pirouette, knife-edge, immelman, slapper, and traveling flips, among others. When the pitch of all blades is adjusted to perform such aerial maneuvering, this may be referred to as adjusting the “collective pitch” of the multicopter **100**. Blade-pitch adjustment may be particularly useful for rotorcraft with substantial inertia in the rotors and/or drive train, but is not limited to such rotorcraft.

Additionally or alternatively, multicopter **100** may propel and maneuver itself adjust the rotation rate of the motors, collectively or differentially. This technique may be particularly useful for small electric rotorcraft with low inertia in the motors and/or rotor system, but is not limited to such rotorcraft.

Multicopter **100** also includes a central enclosure **130** with a hinged lid **135**. The central enclosure may contain, e.g., control electronics such as an inertial measurement unit (IMU) and/or an electronic speed controller, batteries, other sensors, and/or a payload, among other possibilities.

The illustrative multicopter **100** also includes landing gear **140** to assist with controlled take-offs and landings. In other embodiments, multicopters and other types of UAVs without landing gear are also possible.

In a further aspect, multicopter **100** includes rotor protectors **150**. Such rotor protectors **150** can serve multiple purposes, such as protecting the rotors **110** from damage if the multicopter **100** strays too close to an object, protecting the multicopter **100** structure from damage, and protecting nearby objects from being damaged by the rotors **110**. It should be understood that in other embodiments, multicopters and other types of UAVs without rotor protectors are also possible. Further, rotor protectors of different shapes, sizes, and function are possible, without departing from the scope of the invention.

A multicopter **100** may control the direction and/or speed of its movement by controlling its pitch, roll, yaw, and/or altitude. To do so, multicopter **100** may increase or decrease the speeds at which the rotors **110** spin. For example, by maintaining a constant speed of three rotors **110** and decreasing the speed of a fourth rotor, the multicopter **100** can roll right, roll left, pitch forward, or pitch backward, depending upon which motor has its speed decreased. Specifically, the multicopter may roll in the direction of the motor with the decreased speed. As another example, increasing or decreasing the speed of all rotors **110** simul-

taneously can result in the multicopter **100** increasing or decreasing its altitude, respectively. As yet another example, increasing or decreasing the speed of rotors **110** that are turning in the same direction can result in the multicopter **100** performing a yaw-left or yaw-right movement. These are but a few examples of the different types of movement that can be accomplished by independently or collectively adjusting the RPM and/or the direction that rotors **110** are spinning.

FIG. 2 is a simplified illustration of a UAV, according to an example embodiment. In particular, FIG. 2 shows an example of a tail-sitter UAV **200**. In the illustrated example, the tail-sitter UAV **200** has fixed wings **202** to provide lift and allow the UAV to glide horizontally (e.g., along the x-axis, in a position that is approximately perpendicular to the position shown in FIG. 2). However, the fixed wings **202** also allow the tail-sitter UAV **200** take off and land vertically on its own.

For example, at a launch site, tail-sitter UAV **200** may be positioned vertically (as shown) with fins **204** and/or wings **202** resting on the ground and stabilizing the UAV in the vertical position. The tail-sitter UAV **200** may then take off by operating propellers **206** to generate the upward thrust (e.g., a thrust that is generally along the y-axis). Once at a suitable altitude, the tail-sitter UAV **200** may use its flaps **208** to reorient itself in a horizontal position, such that the fuselage **210** is closer to being aligned with the x-axis than the y-axis. Positioned horizontally, the propellers **206** may provide forward thrust so that the tail-sitter UAV **200** can fly in a similar manner as a typical airplane.

Variations on the illustrated tail-sitter UAV **200** are possible. For instance, tail-sitters UAVs with more or less propellers, or that utilize a ducted fan or multiple ducted fans, are also possible. Further, different wing configurations with more wings (e.g., an “x-wing” configuration with four wings), with less wings, or even with no wings, are also possible. More generally, it should be understood that other types of tail-sitter UAVs and variations on the illustrated tail-sitter UAV **200** are also possible.

As noted above, some embodiments may involve other types of UAVs, in addition or in the alternative to multicopters. For instance, FIGS. 3 and 4 are simplified illustrations of other types of UAVs, according to example embodiments.

In particular, FIG. 3 shows an example of a fixed-wing aircraft **300**, which may also be referred to as an airplane, an aeroplane, or simply a plane. A fixed-wing aircraft **300**, as the name implies, has stationary wings **302** that generate lift based on the wing shape and the vehicle’s forward airspeed. This wing configuration is different from a rotorcraft’s configuration, which produces lift through rotating rotors about a fixed mast, and an ornithopter’s configuration, which produces lift by flapping wings.

FIG. 3 depicts some common structures used in a fixed-wing aircraft **300**. In particular, fixed-wing aircraft **300** includes a fuselage **304**, two horizontal wings **302** with an airfoil-shaped cross section to produce an aerodynamic force, a vertical stabilizer **306** (or fin) to stabilize the plane’s yaw (turn left or right), a horizontal stabilizer **308** (also referred to as an elevator or tailplane) to stabilize pitch (tilt up or down), landing gear **310**, and a propulsion unit **312**, which can include a motor, shaft, and propeller.

FIG. 4 shows an example of an aircraft **350** with a propeller in a pusher configuration. The term “pusher” refers to the fact that the propulsion unit **358** is mounted at the back of the aircraft and “pushes” the vehicle forward, in contrast to the propulsion unit being mounted at the front of the

aircraft. Similar to the description provided for FIG. 3, FIG. 4 depicts common structures used in the pusher plane: a fuselage **352**, two horizontal wings **354**, vertical stabilizers **356**, and a propulsion unit **358**, which can include a motor, shaft, and propeller.

UAVs can be launched in various ways, using various types of launch systems. A very simple way to launch a UAV is a hand launch. To perform a hand launch, a user holds a portion of the aircraft, preferably away from the spinning rotors, and throws the aircraft into the air while contemporaneously throttling the propulsion unit to generate lift.

Rather than using a hand launch procedure in which the person launching the vehicle is exposed to risk from the quickly spinning propellers, a stationary or mobile launch station can be utilized. For instance, a launch system can include supports, angled and inclined rails, and a backstop. The aircraft begins the launch system stationary on the angled and inclined rails and launches by sufficiently increasing the speed of the propeller to generate forward airspeed along the incline of the launch system. By the end of the angled and inclined rails, the aircraft can have sufficient airspeed to generate lift. As another example, a launch system may include a rail gun or cannon, either of which may launch a UAV by thrusting the UAV into flight. A launch system of this type may launch a UAV quickly and/or may launch a UAV far towards the UAV’s destination. Other types of launch systems may also be utilized.

In some cases, there may be no separate launch system for a UAV, as a UAV may be configured to launch itself. For example, a “tail sitter” UAV typically has fixed wings to provide lift and allow the UAV to glide, but also is configured to take off and land vertically on its own. Other examples of self-launching UAVs are also possible.

In a further aspect, various other types of unmanned vehicles may be utilized to provide remote medical support. Such vehicles may include, for example, unmanned ground vehicles (UGVs), unmanned space vehicles (USVs), and/or unmanned underwater vehicles (UUVs). A UGV may be a vehicle, which is capable of sensing its own environment and navigating surface-based terrain without input from a driver. Examples of UGVs include watercraft, cars, trucks, buggies, motorcycles, treaded vehicles, and retrieval duck decoys, among others. A UUV is a vehicle that is capable of sensing its own environment and navigating underwater on its own, such as a submersible vehicle. Other types of unmanned vehicles are possible as well.

III. ILLUSTRATIVE UAV SYSTEMS

UAV systems may be implemented in order to provide various services. In particular, UAVs may be provided at a number of different launch sites, which may be in communication with regional and/or central control systems. Such a distributed UAV system may allow UAVs to be quickly deployed to provide services across a large geographic area (e.g., that is much larger than the flight range of any single UAV). For example, UAVs capable of carrying payloads may be distributed at a number of launch sites across a large geographic area (possibly even throughout an entire country, or even worldwide), in order to deliver various items to locations throughout the geographic area. As another example, a distributed UAV system may be provided in order to provide remote medical support, via UAVs. FIG. 5 is a simplified block diagram illustrating a distributed UAV system **500**, according to an example embodiment.

In an illustrative UAV system **500**, an access system **502** may allow for interaction with, control of, and/or utilization

of a network of UAVs **504**. In some embodiments, an access system **502** may be a computing system that allows for human-controlled dispatch of UAVs **504**. As such, the control system may include or otherwise provide a user interface (UI) **503** via which a user can access and/or control UAVs **504**. In some embodiments, dispatch of UAVs **504** may additionally or alternatively be accomplished via one or more automated processes.

Further, an access system **502** may provide for remote operation of a UAV. For instance, an access system **502** may allow an operator to control the flight of a UAV via user interface (UI). As a specific example, an operator may use an access system to dispatch a UAV **504** to deliver a package to a target location, or to travel to the location of a medical situation with medical-support items. The UAV **504** may then autonomously navigate to the general area of the target location. At this point, the operator may use the access system **502** to take over control of the UAV **504**, and navigate the UAV to the target location (e.g., to a particular person to whom a package is being sent). Other examples of remote operation of a UAV are also possible.

In an illustrative embodiment, UAVs **504** may take various forms. For example, each UAV **504** may be a UAV such as those illustrated in FIGS. 1, 2, 3, and 4. However, medical support system **500** may also utilize other types of UAVs without departing from the scope of the invention. In some implementations, all UAVs **504** may be of the same or a similar configuration. However, in other implementations, UAVs **504** may include a number of different types of UAVs. For instance, UAVs **504** may include a number of types of UAVs, with each type of UAV being configured for a different type or types of medical support.

A remote device **506** may take various forms. Generally, a remote device **506** may be any device via which a direct or indirect request to dispatch UAV can be made. (Note that an indirect request may involve any communication that may be responded to by dispatching a UAV; e.g., requesting a package delivery, or sending a request for medical support). In an example embodiment, a remote device **506** may be a mobile phone, tablet computer, laptop computer, personal computer, or any network-connected computing device. Further, in some instances, remote device **506** may not be a computing device. As an example, a standard telephone, which allows for communication via plain old telephone service (POTS), may serve as a remote device **506**. Other types of remote devices are also possible.

Further, a remote device **506** may be configured to communicate with access system **502** via one or more types of communication network(s) **515**. For example, a remote device **506** could communicate with access system **502** (or via a human operator of the access system) by placing a phone call over a POTS network, a cellular network, and/or a data network such as the Internet. Other types of networks may also be utilized.

In some embodiments, a remote device **506** may be configured to allow a user to request delivery of one or more items to a desired location. For example, a user could request UAV delivery of a package to their home via their mobile phone, tablet, or laptop. As another example, a user could request dynamic delivery to whatever location they are at the time of delivery. To provide such dynamic delivery, a UAV system **500** may receive location information (e.g., GPS coordinates, etc.) from the user's mobile phone, or any other device on the user's person, such that a UAV can navigate to the user's location (as indicated by their mobile phone).

In some embodiments, a remote device **506** may be configured to allow a user to request medical support. For

example, a person may use their mobile phone, a POTS phone, or a VoIP phone, to place an emergency call (e.g., a 9-1-1 call) and request that medical support be provided at the scene of an accident. Further, note that a request for medical support need not be explicit. For instance, a person may place a 9-1-1 call to report an emergency situation. When the 9-1-1 operator receives such a call, the operator may evaluate the information that is provided and decide that medical support is appropriate. Accordingly, the operator may use an access system **502** to dispatch a UAV **504**.

As noted, a remote device **506** may be configured to determine and/or provide an indication of its own location. For example, remote device **506** may include a GPS system so that it can include GPS location information (e.g., GPS coordinates) in a communication to an access system **502** and/or to a dispatch system such as central dispatch system **508**. As another example, a remote device **506** may use a technique that involves triangulation (e.g., between base stations in a cellular network) to determine its location. Alternatively, another system such as a cellular network may use a technique that involves triangulation to determine the location of a remote device **506**, and then send a location message to the remote device **506** to inform the remote device of its location. Other location-determination techniques are also possible.

In an illustrative arrangement, central dispatch system **508** may be a server or group of servers, which is configured to receive dispatch messages requests and/or dispatch instructions from an access system **502**. Such dispatch messages may request or instruct the central dispatch system **508** to coordinate the deployment of UAVs to various target locations. A central dispatch system **508** may be further configured to route such requests or instructions to local dispatch systems **510**. To provide such functionality, central dispatch system **508** may communicate with access system **502** via a data network, such as the Internet or a private network that is established for communications between access systems and automated dispatch systems.

In the illustrated configuration, central dispatch system **508** may be configured to coordinate the dispatch of UAVs **504** from a number of different local dispatch systems **510**. As such, central dispatch system **508** may keep track of which UAVs **504** are located at which local dispatch systems **510**, which UAVs **504** are currently available for deployment, and/or which services or operations each of the UAVs **504** is configured for (in the event that a UAV fleet includes multiple types of UAVs configured for different services and/or operations). Additionally or alternatively, each local dispatch system **510** may be configured to track which of its associated UAVs **504** are currently available for deployment, and/or to track which services or operations each of its associated UAVs is configured for.

In some cases, when central dispatch system **508** receives a request for UAV-related service from an access system **502**, central dispatch system **508** may select a specific UAV **504** to dispatch. The central dispatch system **508** may accordingly instruct the local dispatch system **510** that is associated with the selected UAV to dispatch the selected UAV. The local dispatch system **510** may then operate its associated deployment system **512** to launch the selected UAV. In other cases, a central dispatch system **508** may forward a request for a UAV-related service to a local dispatch system **510** that is near the location where the support is requested, and leave the selection of a particular UAV **504** to the local dispatch system **510**.

In some embodiments, each deployment system **512** may take the form of a nest or possibly multiple nests, such as the

illustrative nests described herein. Alternatively, a each nest could include one or more deployment systems **512**. In other configurations, a nest may include or provide some or all of the functionality of a local dispatch system **510** and/or a central dispatch system **508**. It should be understood, however, that a nest may additionally or alternatively provide other functionality and/or include other systems.

In an example configuration, a local dispatch system **510** may be implemented in a computing system at the same location as the deployment system or systems **512** that it controls. For example, in some embodiments, a local dispatch system **510** could be implemented by a computing system at a building, such as a fire station, where the deployment systems **512** and UAVs **504** that are associated with the particular local dispatch system **510** are also located. In other embodiments, a local dispatch system **510** could be implemented at a location that is remote to its associated deployment systems **512** and UAVs **404**.

Numerous variations on and alternatives to the illustrated configuration of medical support system **500** are possible. For example, in some embodiments, a user of a remote device **506** could request medical support directly from a central dispatch system **508**. To do so, an application may be implemented on a remote device **506** that allows the user to provide information regarding a requested service, and generate and send a data message to request that the UAV system provide the service. In such an embodiment, central dispatch system **508** may include automated functionality to handle requests that are generated by such an application, evaluate such requests, and, if appropriate, coordinate with an appropriate local dispatch system **510** to deploy a UAV.

Further, in some implementations, some or all of the functionality that is attributed herein to central dispatch system **508**, local dispatch system(s) **510**, access system **502**, and/or deployment system(s) **512** could be combined in a single system, implemented in a more complex system, and/or redistributed among central dispatch system **508**, local dispatch system(s) **510**, access system **502**, and/or deployment system(s) **512** in various ways.

Yet further, while each local dispatch system **510** is shown as having two associated deployment systems, a given local dispatch system **510** may have more or less associated deployment systems. Similarly, while central dispatch system **508** is shown as being in communication with two local dispatch systems **510**, a central dispatch system may be in communication with more or less local dispatch systems **510**.

In a further aspect, a deployment system **512** may take various forms. In general, a deployment system may take the form of or include a system for physically launching a UAV **504**. Such a launch system may include features that allow for a human-assisted UAV launch and/or features that provide for an automated UAV launch. Further, a deployment system **512** may be configured to launch one particular UAV **504**, or to launch multiple UAVs **504**.

A deployment system **512** may further be configured to provide additional functions, including for example, diagnostic-related functions such as verifying system functionality of the UAV, verifying functionality of devices that are housed within a UAV (e.g., such as a defibrillator, a mobile phone, or an HIVID), and/or maintaining devices or other items that are housed in the UAV (e.g., by charging a defibrillator, mobile phone, or HIVID, or by checking that medicine has not expired).

In some embodiments, the deployment systems **512** and their corresponding UAVs **504** (and possibly associated local dispatch systems **510**) may be strategically distributed

throughout an area such as a city. For example, deployment systems **512** may be located on the roofs of certain municipal buildings, such as fire stations, which can thus serve as the dispatch locations for UAVs **504**. Fire stations may function well for UAV dispatch, as fire stations tend to be distributed well with respect to population density, their roofs tend to be flat, and the use of firehouse roofs as leased spaces for UAV dispatch could further the public good. However, deployment systems **512** (and possibly the local dispatch systems **510**) may be distributed in other ways, depending upon the particular implementation. As an additional example, kiosks that allow users to transport packages via UAVs may be installed in various locations. Such kiosks may include UAV launch systems, and may allow a user to provide their package for loading onto a UAV and pay for UAV shipping services, among other possibilities. Other examples are also possible.

In a further aspect, a UAV system **500** may include or have access to a user-account database **514**. The user-account database **514** may include data for a number of user-accounts, and which are each associated with one or more person. For a given user-account, the user-account database **514** may include data related to or useful in providing UAV-related services. Typically, the user data associated with each user-account is optionally provided by an associated user and/or is collected with the associated user's permission.

Further, in some embodiments, a person may have to register for a user-account with the UAV system **500** in order to use or be provided with UAV-related services by the UAVs **504** of medical-support system **500**. As such, the user-account database **514** may include authorization information for a given user-account (e.g., a user-name and password), and/or other information that may be used to authorize access to a user-account.

In some embodiments, a person may associate one or more of their devices with their user-account, such that they can be provided with access to the services of UAV system **500**. For example, when a person uses an associated mobile phone to, e.g., place a call to an operator of access system **402** or send a message requesting a UAV-related service to a dispatch system, the phone may be identified via a unique device identification number, and the call or message may then be attributed to the associated user-account. Other examples are also possible.

IV. ILLUSTRATIVE COMPONENTS OF A UAV

FIG. 6 is a simplified block diagram illustrating components of a UAV **600**, according to an example embodiment. UAV **600** may take the form of, or be similar in form to, one of the UAVs **100**, **200**, **300**, and **350** described in reference to FIGS. 1, 2, 3, and 4. However, a UAV **600** may also take other forms.

UAV **600** may include various types of sensors, and may include a computing system configured to provide the functionality described herein. In the illustrated embodiment, the sensors of UAV **600** include an inertial measurement unit (IMU) **602**, ultrasonic sensor(s) **604**, GPS **606**, imaging system(s) **608**, among other possible sensors and sensing systems.

In the illustrated embodiment, UAV **600** also includes one or more processors **610**. A processor **610** may be a general-purpose processor or a special purpose processor (e.g., digital signal processors, application specific integrated circuits, etc.). The one or more processors **610** can be configured to execute computer-readable program instructions **614**

that are stored in the data storage **612** and are executable to provide the functionality of a UAV described herein.

The data storage **612** may include or take the form of one or more computer-readable storage media that can be read or accessed by at least one processor **610**. The one or more computer-readable storage media can include volatile and/or non-volatile storage components, such as optical, magnetic, organic or other memory or disc storage, which can be integrated in whole or in part with at least one of the one or more processors **610**. In some embodiments, the data storage **612** can be implemented using a single physical device (e.g., one optical, magnetic, organic or other memory or disc storage unit), while in other embodiments, the data storage **612** can be implemented using two or more physical devices.

As noted, the data storage **612** can include computer-readable program instructions **614** and perhaps additional data, such as diagnostic data of the UAV **600**. As such, the data storage **614** may include program instructions to perform or facilitate some or all of the UAV functionality described herein. For instance, in the illustrated embodiment, program instructions **614** include a navigation module **615** and one or more service modules **616**.

A. Sensors

In an illustrative embodiment, IMU **602** may include both an accelerometer and a gyroscope, which may be used together to determine the orientation of the UAV **600**. In particular, the accelerometer can measure the orientation of the vehicle with respect to earth, while the gyroscope measures the rate of rotation around an axis. IMUs are commercially available in low-cost, low-power packages. For instance, an IMU **602** may take the form of or include a miniaturized MicroElectroMechanical System (MEMS) or a NanoElectroMechanical System (NEMS). Other types of IMUs may also be utilized.

An IMU **602** may include other sensors, in addition to accelerometers and gyroscopes, which may help to better determine position and/or help to increase autonomy of the UAV **600**. Two examples of such sensors are magnetometers and pressure sensors. Other examples are also possible. (Note that a UAV could also include such additional sensors as separate components from an IMU.)

While an accelerometer and gyroscope may be effective at determining the orientation of the UAV **600**, slight errors in measurement may compound over time and result in a more significant error. However, an example UAV **600** may be able to mitigate or reduce such errors by using a magnetometer to measure direction. One example of a magnetometer is a low-power, digital 3-axis magnetometer, which can be used to realize an orientation independent electronic compass for accurate heading information. However, other types of magnetometers may be utilized as well.

UAV **600** may also include a pressure sensor or barometer, which can be used to determine the altitude of the UAV **600**. Alternatively, other sensors, such as sonic altimeters or radar altimeters, can be used to provide an indication of altitude, which may help to improve the accuracy of and/or prevent drift of an IMU.

In a further aspect, UAV **600** may include one or more sensors that allow the UAV to sense objects in the environment. For instance, in the illustrated embodiment, UAV **600** includes ultrasonic sensor(s) **604**. Ultrasonic sensor(s) **604** can determine the distance to an object by generating sound waves and determining the time interval between transmission of the wave and receiving the corresponding echo off an object. A typical application of an ultrasonic sensor for unmanned vehicles or IMUs is low-level altitude control and obstacle avoidance. An ultrasonic sensor can also be used for

vehicles that need to hover at a certain height or need to be capable of detecting obstacles. Other systems can be used to determine, sense the presence of, and/or determine the distance to nearby objects, such as a light detection and ranging (LIDAR) system, laser detection and ranging (LADAR) system, and/or an infrared or forward-looking infrared (FLIR) system, among other possibilities.

UAV **600** also includes a GPS receiver **606**. The GPS receiver **606** may be configured to provide data that is typical of well-known GPS systems, such as the GPS coordinates of the UAV **600**. Such GPS data may be utilized by the UAV **600** for various functions. As such, the UAV may use its GPS receiver **606** to help navigate to the caller's location, as indicated, at least in part, by the GPS coordinates provided by their mobile device. Other examples are also possible.

UAV **600** may also include one or more imaging system(s) **608**. For example, one or more still and/or video cameras may be utilized by a UAV **600** to capture image data from the UAV's environment. As a specific example, charge-coupled device (CCD) cameras or complementary metal-oxide-semiconductor (CMOS) cameras can be used with unmanned vehicles. Such imaging sensor(s) **608** have numerous possible applications, such as obstacle avoidance, localization techniques, ground tracking for more accurate navigation (e.g., by applying optical flow techniques to images), video feedback, and/or image recognition and processing, among other possibilities.

In a further aspect, UAV **600** may use its one or more imaging system **608** to help in determining location. For example, UAV **600** may capture imagery of its environment and compare it to what it expects to see in its environment given current estimated position (e.g., its current GPS coordinates), and refine its estimate of its position based on this comparison.

In a further aspect, UAV **600** may include one or more microphones. Such microphones may be configured to capture sound from the UAVs environment.

B. Navigation and Location Determination

The navigation module **615** may provide functionality that allows the UAV **600** to, e.g., move about in its environment and reach a desired location. To do so, the navigation module **615** may control the altitude and/or direction of flight by controlling the mechanical features of the UAV that affect flight (e.g., rotors **110** of UAV **100**).

In order to navigate the UAV **600** to a target location, a navigation module **615** may implement various navigation techniques, such as map-based navigation and localization-based navigation, for instance. With map-based navigation, the UAV **600** may be provided with a map of its environment, which may then be used to navigate to a particular location on the map. With localization-based navigation, the UAV **600** may be capable of navigating in an unknown environment using localization. Localization-based navigation may involve a UAV **600** building its own map of its environment and calculating its position within the map and/or the position of objects in the environment. For example, as a UAV **600** moves throughout its environment, the UAV **600** may continuously use localization to update its map of the environment. This continuous mapping process may be referred to as simultaneous localization and mapping (SLAM). Other navigation techniques may also be utilized.

In some embodiments, the navigation module **615** may navigate using a technique that relies on waypoints. In particular, waypoints are sets of coordinates that identify points in physical space. For instance, an air-navigation waypoint may be defined by a certain latitude, longitude,

and altitude. Accordingly, navigation module **615** may cause UAV **600** to move from waypoint to waypoint, in order to ultimately travel to a final destination (e.g., a final waypoint in a sequence of waypoints).

In a further aspect, navigation module **615** and/or other components and systems of UAV **600** may be configured for “localization” to more precisely navigate to the scene of a medical situation. More specifically, it may be desirable in certain situations for a UAV to be close to the person to whom an item is being delivered by a UAV (e.g., within reach of the person). To this end, a UAV may use a two-tiered approach in which it uses a more-general location-determination technique to navigate to a target location or area that is associated with the medical situation, and then use a more-refined location-determination technique to identify and/or navigate to the target location within the general area.

For example, a UAV **600** may navigate to the general area of a person to whom an item is being delivered using waypoints. Such waypoints may be pre-determined based on GPS coordinates provided by a remote device at the target delivery location. The UAV may then switch to a mode in which it utilizes a localization process to locate and travel to a specific location of the person in need. For instance, if a person is having a heart attack at a large stadium, a UAV **600** carrying a medical package may need to be within reach of the person or someone near the person so that the can take items from the package. However, a GPS signal may only get a UAV so far, e.g., to the stadium. A more precise location-determination technique may then be used to find the specific location of the person within the stadium.

Various types of location-determination techniques may be used to accomplish localization of a person or a device once a UAV **600** has navigated to the general area of the person or device. For instance, a UAV **600** may be equipped with one or more sensory systems, such as, for example, imaging system(s) **608**, a directional microphone array (not shown), ultrasonic sensors **604**, infrared sensors (not shown), and/or other sensors, which may provide input that the navigation module **615** utilizes to navigate autonomously or semi-autonomously to the specific location of a person.

As another example, once the UAV **600** reaches the general area of a target delivery location (or of a moving subject such as a person or their mobile device), the UAV **600** may switch to a “fly-by-wire” mode where it is controlled, at least in part, by a remote operator, who can navigate the UAV **600** to the specific location of the person in need. To this end, sensory data from the UAV **600** may be sent to the remote operator to assist them in navigating the UAV to the specific location. For example, the UAV **600** may stream a video feed or a sequence of still images from the UAV’s imaging system(s) **608**. Other examples are possible.

As yet another example, the UAV **600** may include a module that is able to signal to a passer-by for assistance in either reaching the specific target delivery location; for example, a UAV may displaying a visual message requesting such assistance in a graphic display, play an audio message or tone through speakers to indicate the need for such assistance, among other possibilities. Such a visual or audio message might indicate that assistance is needed in delivering the UAV **600** to a particular person or a particular location, and might provide information to assist the passer-by in delivering the UAV **600** to the person or location (e.g., a description or picture of the person or location, and/or the person or location’s name), among other possibilities. Such

a feature can be useful in a scenario in which the UAV is unable to use sensory functions or another location-determination technique to determine the specific location of the person. However, this feature is not limited to such scenarios.

In some embodiments, once a UAV **600** arrives at the general area of a person who requested service and/or at the general area that includes a target delivery location, the UAV may utilize a beacon from a user’s remote device (e.g., the user’s mobile phone) to locate the person. Such a beacon may take various forms. As an example, consider the scenario where a remote device, such as the mobile phone of a person who requested a UAV delivery, is able to send out directional signals (e.g., an RF signal, a light signal and/or an audio signal). In this scenario, the UAV may be configured to navigate by “sourcing” such directional signals—in other words, by determining where the signal is strongest and navigating accordingly. As another example, a mobile device can emit a frequency, either in the human range or outside the human range, and the UAV can listen for that frequency and navigate accordingly. As a related example, if the UAV is listening for spoken commands, then the UAV could utilize spoken statements, such as “Help! I’m over here!” to source the specific location of the person in need of medical assistance.

In an alternative arrangement, a navigation module may be implemented at a remote computing device, which communicates wirelessly with the UAV. The remote computing device may receive data indicating the operational state of the UAV, sensor data from the UAV that allows it to assess the environmental conditions being experienced by the UAV, and/or location information for the UAV. Provided with such information, the remote computing device may determine altitudinal and/or directional adjustments that should be made by the UAV and/or may determine how the UAV should adjust its mechanical features (e.g., rotors **110** of UAV **100**) in order to effectuate such movements. The remote computing system may then communicate such adjustments to the UAV so it can move in the determined manner.

C. Communication Systems

In a further aspect, UAV **600** includes one or more communication systems **620**. The communications systems **620** may include one or more wireless interfaces and/or one or more wireline interfaces, which allow UAV **600** to communicate via one or more networks. Such wireless interfaces may provide for communication under one or more wireless communication protocols, such as Bluetooth, WiFi (e.g., an IEEE 802.11 protocol), Long-Term Evolution (LTE), WiMAX (e.g., an IEEE 802.16 standard), a radio-frequency ID (RFID) protocol, near-field communication (NFC), and/or other wireless communication protocols. Such wireline interfaces may include an Ethernet interface, a Universal Serial Bus (USB) interface, or similar interface to communicate via a wire, a twisted pair of wires, a coaxial cable, an optical link, a fiber-optic link, or other physical connection to a wireline network.

In an example embodiment, a UAV **600** may include communication systems **620** that allow for both short-range communication and long-range communication. For example, the UAV **600** may be configured for short-range communications using Bluetooth and for long-range communications under a CDMA protocol. In such an embodiment, the UAV **600** may be configured to function as a “hot spot;” or in other words, as a gateway or proxy between a remote support device and one or more data networks, such as cellular network and/or the Internet. Configured as such,

the UAV 600 may facilitate data communications that the remote support device would otherwise be unable to perform by itself.

For example, UAV 600 may provide a WiFi connection to a remote device, and serve as a proxy or gateway to a cellular service provider's data network, which the UAV might connect to under an LTE or a 3G protocol, for instance. The UAV 600 could also serve as a proxy or gateway to a high-altitude balloon network, a satellite network, or a combination of these networks, among others, which a remote device might not be able to otherwise access.

D. Power Systems

In a further aspect, UAV 600 may include power system (s) 621. A power system 621 may include one or more batteries for providing power to the UAV 600. In one example, the one or more batteries may be rechargeable and each battery may be recharged via a wired connection between the battery and a power supply and/or via a wireless charging system, such as an inductive charging system that applies an external time-varying magnetic field to an internal battery.

E. Payloads

A UAV 600 may employ various systems and configurations in order to transport items. In the illustrated embodiment, a payload 622 may serve as a compartment that can hold one or more items, such that a UAV 600 can deliver the one or more items to a target delivery location. For example, as shown in FIG. 1, a UAV 100 can include a compartment 135, in which an item or items may be transported. As another example, the UAV can include a pick-and-place mechanism, which can pick up and hold the item while the UAV is in flight, and then release the item during or after the UAV's descent. As yet another example, a UAV could include an air-bag drop system, a parachute drop system, and/or a winch system that is operable from high above a medical situation to drop or lower an item or items to the scene of the medical situation. Other examples are also possible.

In some implementations, the payload 622 of a given UAV 600 may include or take the form of a "package" designed to transport medical-support items to a target delivery location. For example, a medical-support UAV may include a package with one or more items for medical support in the particular medical situation, and/or one or more medical-support modules 616 that are designed to provide medical support in the particular medical situation. In some cases, a UAV 600 may include a package that is designed for a particular medical situation such as choking, cardiac arrest, shock, asthma, drowning, etc. In other cases, a UAV 600 may include a package that is designed for a number of different medical situations, which may be associated in some way.

Such medical support items may aid in diagnosing and/or treating a person who needs medical assistance, or may serve other purposes. Example of medical-support items include, but are not limited to: (a) medicines, (b) diagnostic devices, such as a pulse oximeter, blood pressure sensor, or EKG sensor, (c) treatment devices, such as an EpiPen, a first aid kit, or various kinds of defibrillators (e.g., an automated external defibrillator (AED)), and/or (d) remote support devices, such as a mobile phone or a head-mountable device (HIVID), among other possibilities. Note that some items that are electronic may include one or more batteries to provide power to the item. These batteries may be rechargeable and may be recharged using one or more wired or wireless charging systems. In addition or on in the alterna-

tive, an item may be integrated with one or more batteries in the power system 621 for power.

In some embodiments, a UAV 600 could include an integrated system or device for administering or assisting in the administration of medical care (e.g., a system or device having one or more components that are built in to the structure of the UAV itself). For example, as noted above, a UAV could include an oxygen-therapy system. In an example configuration, an oxygen-therapy system might include a mask that is connected via tubing to an on-board oxygen source. Configured as such, the UAV could release the oxygen mask when it reaches a person in need of oxygen (e.g., at a fire scene).

As another example of a UAV with an integrated medical-support device, a UAV 600 might function as a mobile defibrillator. Specifically, rather than carry a stand-alone defibrillator that can then be removed from the UAV for use, the UAV itself may function as a defibrillator.

F. Service Modules

As noted above, UAV 600 may include one or more service modules 916. The one or more service modules 616 include software, firmware, and/or hardware that may help to provide or assist in the provision of the UAV-related services.

Configured as such, a UAV 600 may provide various types of service. For instance, a UAV 600 may have stored information that can be provided to a person or persons at the target location, in order to assist the person or persons in various ways. For example, a UAV may include a video or audio file with instructions for performing some task, which the UAV can play out to a person at the target location. As another example, a UAV may include an interactive program to assist a person at the target location in performing some task. For instance, a UAV may include an application that analyzes the person's speech to detect questions related to the medical situation and/or that provides a text-based interface via which the person can ask such questions, and then determines and provides answers to such questions.

In some embodiments, a UAV 600 may facilitate communication between a layperson and/or medical personnel at the scene and medical personnel at a remote location. As an example, a service module 616 may provide a user interface via which a person at the scene can use a communication system 620 of the UAV to communicate with an emergency medical technician at a remote location. As another example, the UAV 600 can unlock certain capabilities of a remote device, such as a mobile phone, which is near the UAV at the scene of a medical situation. Such capabilities may be inaccessible to a user of the remote device, unless the remote device is within a certain distance from the UAV such that the UAV can unlock the capabilities. For example, a UAV may send the remote device a security key that allows the remote device to establish a secure connection to communicate with medical personnel at a remote location. Other examples are also possible.

V. ILLUSTRATIVE UAV NESTS

In some embodiments, a nest for a UAV may be a home station that includes a landing feature, automated battery recharging and/or swapping systems, maintenance systems, and/or a launch system that operates without physical intervention from an operator (or perhaps with less physical intervention than might otherwise be required). FIG. 7 is an illustration of a nest, according to an example embodiment. An example nest 700 may be built on a frame structure, which in the illustrated example is a hexagonal frame, which

supports a landing pad **709** and includes one or more launch systems. The nest **700** is generally arranged on a frame structure, which supports a roof on which the landing pad **709** is disposed, and includes side sections that provide a human-sized chamber beneath the roof. The chamber is partially closed and provides access to two launch systems that are substantially housed within the chamber, such that a human operator can operate the launch systems from within the chamber.

Herein, a “human-sized” chamber or room should be understood to be any wholly or partially enclosed volume that is large enough to be occupied by a human, while the human is utilizing input interfaces in the chamber (e.g., control interfaces for a nest and/or a UAV). For instance, the interior of nest **700** may provide enough room under roof **708** for some or most humans to stand up fully (e.g., five feet or more or of clearance), while accessing a UAV **702**. As such, the interior of nest **700** may be considered to be “human-sized” chamber. In other cases, a human-sized chamber may not provide enough room for the average human to stand up fully. For example, a chamber with a seat, which is sized to accommodate a human sitting in the seat, may be considered to be a human-sized chamber, regardless of whether or not the chamber is large enough for the human to stand up fully.

An example launch system includes a launch tube **703** and a panel **705** that can be opened or closed to access or restrict access to the interior of the launch tube. An operator may thus open panel **705** and place a UAV **702** on a launch mechanism that is operable to propel the UAV **702** upwards through the launch tube **703** and out of an opening in the roof that is provided when the launch-tube hatch **704** is opened. Note that in some implementations, a UAV, such as a tail-sitter UAV, may also be configured to launch directly from the roof **708** of the nest (e.g., from the landing pad **709**).

In a further aspect, the panel may help to improve the safety for a human operator of an example nest **700**. For example, the launch system may require that the moveable panel **705** be closed in order for a launch process to be initiated. FIG. **8A** shows an example launch system in greater detail. In particular, FIG. **8A** shows an interior view of a launch tube **703**. The launch system includes a UAV attachment feature (e.g., a launch sled **802**) within the launch tube, which connects the UAV **702** to a launch mechanism. (Note that a human operator may place a UAV on the launch sled **802** through the opening provided when panel **705** is opened.) The launch mechanism includes a launch guide (e.g., guide wires **806**), a launch cable **804** to which the launch sled **802** is attached, and a motor **808**. The motor **808** is operable to launch the UAV **702** by moving the launch cable **804** around a pulley system **810**, thus propelling the launch sled **802** and the attached UAV **702** upward through the launch tube **703** such that the UAV that is propelled through an opening at a top end of the launch tube. Note that while the nest **700** shown in FIG. **7** includes two launch systems for UAVs **702**, a single launch system or more than two launch systems such as shown in FIG. **8A** are also possible.

Referring again to FIG. **7**, in the illustrated example, a landing pad **709** may be arranged on the roof of the nest, such that the landing pad is accessible for a UAV to land thereon. The landing pad may include a launch hatch **704** at the top end of each launch tube **703**. A launch hatch **704** may be configured to open as part of a launch process (and possibly only if the interior access panel to the launch tube

is closed), and to otherwise remain closed, thereby sealing the opening at the top of launch tube **703** when no UAV is being launched.

In some embodiments, the landing pad may include a zero-impact or low-impact grass surface on which the UAV can land. Further, the landing pad **709** may include at least one visual feature to assist a UAV in landing on the landing pad, such as a distinctively colored “X” on its surface or a beacon that the onboard camera in a UAV can use to accurately locate and land on the landing pad (e.g., using Visual Odometry).

In another aspect, ultrasonic or IR transmitters (not shown) on or near landing pad **709** could be used to help improve a UAV’s landing accuracy. In such embodiments, the UAV **702** may include ultrasonic or IR receivers that can receive signals from the nest’s transmitters, and use the received signals to help locate the landing pad **709**.

In a further aspect, a recovery net **716** may be adjacent to the landing pad. The recovery net **716** may be arranged such that when the UAV is in the process of landing, the recovery net receives the UAV and/or guides the UAV towards the landing pad. The recovery net **716** also improve safety, e.g., by protecting those that might be in the vicinity of the nest.

In some embodiments, a horizontal net could be placed around a landing pad as a safety measure. For example, a “donut-shaped” net could be placed around the circumference of landing pad **709**, which may protect the UAV and/or prevent the UAV from falling off the roof of the nest **700**, in the event the UAV misses the landing pad **709** by a small amount. Other examples of such nets surrounding a landing pad are also possible.

In some embodiments, the nest’s landing feature may include or take the form of a horizontally-arranged recovery net, which may be used instead of a landing pad **709**. In such an embodiment, a horizontal recovery net may be raised, such that there is an air gap underneath the horizontal recovery net (e.g., a gap between the recovery net and the roof of the nest), such that the recovery net can stretch in order to support, and possibly to “catch” a UAV. Such a horizontal recovery net may include similar visual features to assist in landing as described in reference to landing pad **709**.

To illustrate, consider a scenario where a UAV is landing on a nest that is equipped with a horizontal recovery net on its roof. When returning from a flight, the UAV could switch to a hover mode, lower itself close to the net, and then power off or reduce power to its motors so that it falls into the horizontal recovery net. This type of horizontal recovery net may therefore be particularly useful if a UAV does not have landing gear (e.g., feet or wheels). Of course, a horizontal recovery net may be useful for other landing techniques and/or for other types of UAVs (e.g., UAVs that have landing gear).

In a further aspect, the nest **700** may include one or more mechanical battery-replacement systems, which may each be configured to: (a) remove a first battery from the UAV, (b) connect the first battery to a charging system, and (c) after removal of the first battery, install a second battery in the UAV.

For example, FIG. **8B** is simplified illustrations of battery-replacement systems, according to example embodiments. In particular, FIG. **8B** shows an example in which a small robotic arm **804** is installed within or with access to the interior of a launch tube **850**. The UAV **852** includes slots **858a** and **858b** on either side of a battery compartment **860**. As such, the moveable pinchers **856a** and **856b** of the

robotic arm **854** can slide into slots **858a** and **858b** to grasp and remove a battery from the battery compartment **860**. Similarly, the pinchers **856a** and **856b** of the robotic arm **854** could place a new battery into the battery compartment **860**, once a previous battery is removed.

In a variation on the illustrated configuration, a robotic arm may be otherwise configured in the same way as shown in FIG. **8B**, but may include an electromagnetic end effector that can be turned on and off, instead of pinchers. Further, the UAV may utilize batteries having at least one magnetic surface. Such an electromagnetic end effector may thus be positioned on a battery in the UAV, and then turned on to magnetically attach to the battery and hold it while the robotic arm removes the battery from the UAV. Further, the electromagnetic end effector may be turned on to magnetically attach to a new battery for the UAV, which may be stored in the launch tube or elsewhere, or may be placed in a location that is accessible to the robotic arm by human operator. The robotic arm may then move the new battery into the UAV's battery compartment, and then turn the electromagnetic end effector off and remove it from the UAV to install the new battery in the UAV. Other variations on the illustrated example, and entirely different configurations and techniques for battery replacement in a UAV, are also possible.

In some embodiments, the nest **700** may include one or more battery swapping systems instead of, or in addition to, battery charging systems. In such embodiments, the UAV **702** may include two or more power sources, such that the UAV can be continuously powered during the process of exchanging a used battery for a new battery. As such, a battery swapping system (or battery exchange system) may include one or more mechanical features that can automate the process of removing a battery from the robot, such as robotic arms, pinchers, and/or magnetic features (e.g., controllable electromagnets for attaching to and removing a battery), among other possibilities. In some embodiments, such a system may be operable to place a new battery in the UAV **702**, before an old battery is removed. This may allow the UAV **702** to operate (e.g., fly) with only one battery, which may reduce weight and extend flight time.

Nest **700** may include an onboard integrated computer (not shown), which may generally control the operation of the nest (e.g., those functions that are not controlled by a human operator). The integrated computer may also be referred to as the nest's "control system." Further, the control system may include software and/or firmware to control the UAV **702** and/or to facilitate control of the UAV **702** by a human operator. Yet further, control system may generate and/or store log data, diagnostic data, and/or flight data for UAVs **702**. Such data may be stored locally in data storage in the nest **700**, and/or may be stored in the cloud (e.g., if an internet connection is available). The control system may also be configured to check for software updates and/or to allow for remote updates of its software.

In some embodiments, a nest **700** may also include a diagnostics system **750** for the UAV **702**. Various types of diagnostic systems are possible. The diagnostics system **750** may include: (a) an onboard integrated computer **752** and (b) one or more interfaces **754** for acquiring data from a UAV. Configured as such, the diagnostics system may perform basic diagnostics on the UAV, such as testing motor controllers, propellers, and/or on-board sensors to ascertain whether these components are functioning properly and/or have been damaged.

In a further aspect, a nest **700** may include one or more systems for communicating with UAV that has been

launched from the nest and is flying to or located at a target location. For example, nest **700** may include a long-range (e.g. up to 70 km) communication system configured for communications with the UAV. Such a long-range communication system may include a long-range directional antenna for RF communications with a UAV **702**, as well as a directional tracking mechanism to facilitate the aiming of the directional antenna at the UAV while the UAV is in flight.

A nest **700** may also include other types of communication systems, which may allow for communications via the Internet and/or other data networks. For example, a router, modem and interface to a local wireless network may enable the nest **700** to connect to the Internet. As such, local UAV operators at the nest can run diagnostics. Further, such network connectivity may allow for remote control of some or all functions of a nest **700** and/or a UAV **702**. Further, in some embodiments, nest **700** may include an integrated ground-station radar system **720** that provides air traffic control information to the nest's onboard computer. Alternatively, nest **700** may connect to a remote radar system to obtain such air traffic control information.

As noted above, a nest may provide a "human-sized" chamber that can accommodate (e.g., shelter) a human while they are accessing and/or operating the systems within the nest. FIG. **9** is a simplified illustration of a human operator **902** standing inside of an example nest **900**. Nest **900** is sized so as to accommodate the human operator **902** while the person is accessing control interfaces **904**, and/or while human operator **902** is accessing UAVs **906** and/or UAV launch tubes **908**, and thus may be considered to be a human-sized nest. The components of human-sized nest **900** will now be described in greater detail.

In one aspect, nest **900** includes two launch systems for two UAVs **906**. (Of course, more or less launch systems, for more or less UAVs, are also possible.) In the illustrated implementation, each launch system includes a launch tube **908**, and may operate in a similar manner as the launch system shown in FIG. **8A**.

In another aspect, nest **900** includes a landing feature, which is arranged on the apparatus so as to receive the UAV when the UAV returns from a flight. In the illustrated implementation, the landing feature **910** is on the roof of nest **900**, and may include a landing pad and/or a horizontal recovery net, such as described above in reference to FIG. **7**.

In a further aspect, a frame structure **912** of nest **900** provides a human-sized chamber therein. In the illustrated implementation, the frame structure **912** is formed by a roof **913** and side sections **914**. In nest **900**, the side sections include: (a) opaque panels, which could be made of wood, metal, plastic, or another opaque material, and (b) at least partially transparent panels, which could be made of glass, acrylic, plastic, or another material that is at least partially transparent. It should be understood that side panels of different shapes, different sizes, and/or different opacity are possible, depending upon the particular implementation. The roof of the nest may also vary in shape, size, and/or opacity, and may be made from different materials. Further, note that doors **916** may also be considered part of the frame structure **912**. And, more generally, any structural features that form part of a nest's chamber may be considered part of the nest's frame structure.

Nest **900** also includes one or more control interfaces **904**, that are physically accessible from within the human-sized chamber of the nest. Control interfaces **904** allow a human operator **902** to operate the some or all of the nest's systems, and/or may allow human operator **902** to operate the UAVs

906. The control interfaces **904** may take any appropriate form, such as one or more of a keyboard, a mouse, a touchscreen, and/or a custom-designed interface (e.g., a custom layout of buttons, knobs, dials, sliders, touch pads, etc.), among other possibilities. The control interfaces **904** may provide various functions, such as control of the UAV launch systems, control of battery-replacement systems and/or battery chargers, control of the UAV while in flight (e.g., controls for manual or semi-manual flight of the UAV), control of UAV-mounted camera, controls for diagnostics systems, and/or controls for the nest's communication systems, among other possibilities.

Further, at least a portion of the launch system is disposed within the nest's chamber, such that a human operator **902** can load a UAV onto the launch system from within the chamber. Specifically, when the panel at the bottom of a launch tube **908** is raised, human operator **902** can access the launch tube **908** in order to load a UAV **906** onto the launch system. (Note that in FIG. 9, the panel at the bottom of a launch tube **908** is not visible, as it has been raised into a slot within the launch tube **908**.)

VI. SELF-SERVICE KIOSK NESTS

In a further aspect, a nest may be configured as a self-service kiosk, which receives packages from users and delivers them to recipient locations, possibly without a human operator present to load the package on the UAV and/or operate the UAV. Such a kiosk may allow the average, untrained person, to initiate shipment of a package on a UAV that is launched from the kiosk. FIGS. 10A and 10B are simplified illustrations of two embodiments in which nests are configured as self-service kiosks.

When configured as a self-service kiosk, a nest may include one or more user-interface components, via which a user who wants to ship a package can provide the information necessary to do so. For example, in FIG. 10A, nest **1000** includes interface components **1002**, which may provide features that allow a user **1003** to send a package to a desired location or recipient on UAV **1006** that is launched from the nest. In the illustrated example, user-interface components **1002** include a display (which may be a touchscreen) and a keyboard. However, the user-interfaces components may according to the particular implementation, and may take any appropriate form, such as one or more of a keyboard, a mouse, a touchscreen, and/or a custom-designed interface (e.g., a custom layout of buttons, knobs, dials, sliders, touch pads, etc.), among other possibilities.

Regardless of which components that are utilized, a kiosk's user-interface components **1002** may be operable to: (a) receive information to facilitate delivery of a package to a target location (e.g., by allowing a user to specify the recipient name and/or address), and (b) receive or facilitate payment for the delivery of the package to the target location (e.g., a slot or slots via which a user can provide paper money or coins, a credit-card processing facility, etc.).

Further, a nest **1000** that is configured as a self-service kiosk may include a package-reception feature **1004** configured to receive a package from a user. Further, nest **1000** may include a package-loading mechanism (such as robotic arm **854**, for instance), which is configured to load a package received via the package-reception feature **1004** onto the UAV for transport to the recipient. For example, a compartment door **1008** may open when a user initiates a shipment transaction via user-interface components **1002**, and then close once the transaction is completed and confirmed by the user. The package-loading mechanism, which include any

suitable mechanical and/or structural components, may then load the package to the UAV (e.g., by moving the package into a holding bin that is attached to the underside of the UAV). The nest's launch system can then launch the UAV with received package loaded thereon, such that the UAV can fly to the location of the specified recipient.

In other embodiments, a kiosk nest may not include a package-loading mechanism. For example, a human operator inside the nest **1000** may take a package from the package-reception feature **1004** and place the package in a holding bin on the UAV, or otherwise attach the package to the UAV, before launching the UAV.

In a further aspect, nest **1000** has a door **1010** that can be locked, and thus provides restricted access to the interior chamber of the nest. The interior chamber of nest **1000** may include the same or similar control interfaces as those described elsewhere herein. Thus, a designated human operator (not shown) can unlock door **1010** to access the interior chamber to operate and maintain UAVs using the control interfaces therein. However, the door may otherwise remain locked, such that an average person **1003** who is shipping a package from nest **1000**, cannot access the interior of the nest.

An arrangement with restricted access to the interior of a nest may be desirable in various scenarios. In particular, the user-interface components **1002** on the exterior of the nest **1000** may provide the average person **1003** with the ability to initiate a shipment without any direct interaction with a human operator of the nest, while the control interfaces in the interior chamber of the nest provide functionality that the average person does not necessarily need access to. For example, in some cases, a human operator inside the nest may be present when person **1003** initiates a shipment, such that the human operator can launch the UAV, operate the UAV during flight to the delivery location, and so on.

In other cases, automated systems may load the package onto the UAV, generate a flight plan to the delivery location, launch the UAV, and control the UAV during flight to the delivery location and/or during a return flight from the delivery location to the nest. For example, the nest **1050** shown in FIG. 10B is configured as a substantially autonomous self-service kiosk.

In particular, the average person **1053** who wishes to send a package may enter the nest **1050** through openings **1058**, and access the user-interface components **1052** within the nest in order to initiate a shipment with a UAV **1056**. Automated systems, which do not require the presence of a human operator, may then load the person's package onto one of the UAVs **1056**, generate flight plans to the delivery location, launch the UAV on which the package is loaded, and control the UAV during flight to the delivery location and/or during a return flight from the delivery location to the nest.

VII. CONCLUSION

While the examples described herein include only a single interface feature, it should be understood that in some embodiments, a peripheral device may include two or more interface features, which may be operable to control different functions of an HIVID. Further, in some embodiments, a peripheral device may include a combination of two or more different types of interface features (e.g., a button and switch).

While various aspects of the disclosure have been disclosed herein, other aspects and embodiments will be apparent to those skilled in the art. Accordingly, the embodiments

23

disclosed herein are for purposes of illustration, and are not intended to be limiting, with the true scope and spirit of the disclosure being indicated by the following claims.

What is claimed is:

1. An apparatus comprising:
 a launch system for an unmanned aerial vehicle (UAV);
 a landing feature that is arranged on the apparatus so as to receive the UAV when the UAV returns from a flight;
 a mechanical battery-replacement system that is configured to:
 (a) remove a first battery from the UAV, and
 (b) after removal of the first battery, install a second battery in the UAV; and
 a frame structure comprising:
 a roof, and
 a chamber beneath the roof,
 wherein the launch system is arranged to:
 couple to the UAV at a location inside the chamber, and move the UAV out of the chamber during a launch process, and
 wherein the landing feature is arranged on the roof of the frame structure.
2. The apparatus of claim 1, wherein the launch system comprises a UAV attachment feature within a compartment, wherein the UAV attachment feature connects to a launch mechanism, and
 wherein a panel that is moveable to a first position to provide access to the compartment such that the UAV attachment feature is accessible at the coupling location within the chamber, and is moveable to a second position to restrict access to the compartment.
3. The apparatus of claim 2, wherein the launch system requires the moveable panel to be in the second position in order for a launch process to be initiated.
4. The apparatus of claim 2,
 wherein the launch system further comprises a launch tube, and
 wherein the launch mechanism comprises:
 a rail, and
 a motor configured to move the attachment feature upward through the launch tube such that when the UAV that is attached to the attachment feature the UAV is propelled through an opening at a top end of the launch tube.
5. The apparatus of claim 4, wherein the launch system further comprises a hatch at the top end of the launch tube, wherein the hatch is configured to open as part of a launch process, and to otherwise remain closed.
6. The apparatus of claim 1, wherein the landing feature comprises at least one visible feature to assist a UAV in landing on the landing feature.
7. The apparatus of claim 1, wherein the landing feature comprises a zero-impact grass surface on which a UAV can land.
8. The apparatus of claim 1;
 wherein the landing feature comprises a recovery net adjacent to a landing pad, and
 wherein the recovery net is arranged such that when the UAV is in the process of landing, the recovery net guides the UAV towards the landing pad.
9. The apparatus of claim 1, further comprising a diagnostics system for the UAV, wherein the diagnostics system comprises at least:

24

- (a) an onboard integrated computer, and
 (b) one or more communication interfaces for acquiring data from the UAV.
10. The apparatus of claim 9, wherein the onboard integrated computer is programmed to generate vehicle log data.
11. The apparatus of claim 1, further comprising one or more communication systems.
12. The apparatus of claim 11, wherein the one or more communication systems comprise a long-range communication system configured for communications with the UAV after the UAV has been launched from the apparatus and is in flight to a target location.
13. The apparatus of claim 11, wherein the one or more communication systems comprise a radar system that is operable to receive air-traffic control data.
14. The apparatus of claim 1, wherein the apparatus is operable for self-service UAV delivery of a package, the apparatus further comprising:
 one or more user-interface components, wherein the one or more user-interface components are operable to:
 (a) receive information to facilitate delivery of a package to a target location, and
 (b) receive payment for the delivery of the package to the target location; and
 a package-reception feature configured to receive the package; and
 wherein the launch system is operable to launch the UAV with received package loaded thereon.
15. An apparatus comprising:
 a launch system for an unmanned aerial vehicle (UAV);
 a landing feature that is arranged on the apparatus so as to receive the UAV when the UAV returns from a flight;
 a frame structure that comprises:
 a roof, and
 one or more side sections, wherein the one or more side sections and the roof form a human-sized chamber that is at least partially enclosed;
 one or more human-operable control interfaces that are physically accessible from within the human-sized chamber, wherein the one or more human-operable control interfaces are operable to control at least the launch system;
 wherein at least a portion of the launch system is disposed within the human-sized chamber such that the UAV can be loaded onto the launch system at a coupling location within the human-sized chamber,
 wherein the launch system is operable for a launch process in which the UAV moved out of the chamber, and
 wherein the landing feature is at least partially disposed on the roof.
16. The apparatus of claim 15, further comprising a diagnostics system for the UAV, wherein the diagnostics system comprises at least:
 (a) an onboard integrated computer, and
 (b) one or more communication interfaces for acquiring data from a UAV.
17. The apparatus of claim 15, wherein the apparatus is configured as a self-service kiosk.

* * * * *